



Flex&Lux

INNOVATION IS PASSION

TECHNICAL
SPECIFICATIONS

Rambrandt



INTERIOR



CEILING



WALL



SURFACE



CORNERHOLD

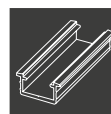

PROFILE

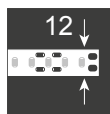

MAX. LED WIDTH



SCREW-IN



ADHESIVE TAPE

DEGAS

Ref. C570

High-quality rigid ABS diffuser, designed to insert the LED strip inside and attach it to the surface with a clamping profile or heat sink without the need for milling.

It helps eliminate the LED bright spot and protect it from dirt and knocks.

TECHNICAL SPECIFICATIONS:

Material:	ABS
Colour:	Opal
Fire resistant:	UL94 HB.
Temperature:	-25 °C – +75 °C
Guarantee:	5 years*
Life cycle:	25+ years
Length of diffuser:	2.60m

* When properly installed, used and maintained

COMPATIBLE LEDS

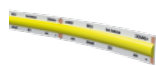

COB EGON 12V/11W

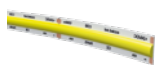

COB EGON 24V/15W



COB EGON RGB
24V/12W



NIKOLA 220V
*without aluminium plate

WHEN USING OUR DIFFUSERS THERE IS A LUMEN LOSS OF 25% TO 35% DEPENDING ON THE THICKNESS OF THE DIFFUSER.

COMPATIBLE PROFILES:



Aluminium profile
NEWTON C581



Aluminium profile
MARCONI C220

220V COMPATIBLE ACCESSORIES:



Pseudo-touch Sensor Switch
For cupboards and drawers
17AE-033
100-240V 300W



Motion sensor
Detection 0.5-2m
76x35x19.5
17AE-025

12/24V COMPATIBLE ACCESSORIES:



Power supply
17FA-140-12 20W/60W/100W
17FA-141-24 30W/75W/120W/180W



Pseudo-touch Sensor Switch
For cupboards and drawers
17AE-033
100-240V 300W



Presence sensor
for doors
17AE-026
12V/36W-24V/72W



Sensor ON-OFF
Surface dimmer
17AE-024
12V/36W-24V/72W



Sensor Switch
Bluetouch indicator light
17AE-021
12-24V



Sensor ON-OFF
Recessed dimmer
17AE-023
12V/36W-24V/72W



Motion sensor
Detection 0.5-2m
76x35x19.5
17AE-025

RGB COMPATIBLE ACCESSORIES:



RGBW sequencer
6A x channel Max. 10A
Battery not included
17AE-150



Wifi RGBW sequencer
4 channels Max. 15A
17AE-151



Power supply
17FA-141-24
30W/75W/120W/180W



SECTION:
Tolerance +0.3

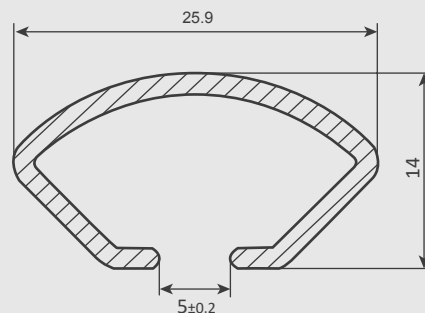

INSTALLATION:



CEILING



WALL

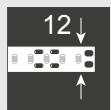

MAX. LED
WIDTH

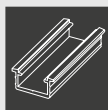

PROFILE



SCREW-IN



ADHESIVE
TAPE



SURFACE



CORNERHOLD

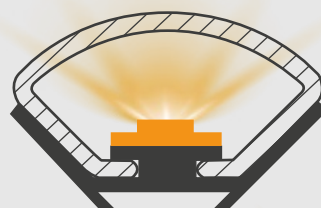

NEWTON
C581

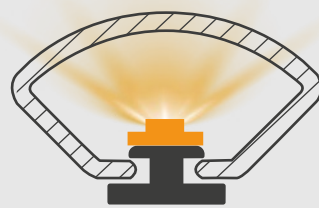

MARCONI
C220

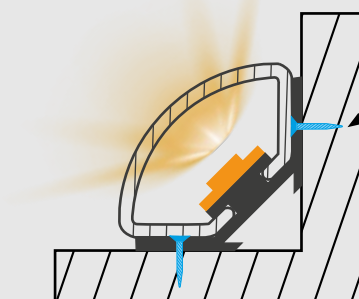

Install screw
countersunk lag screw

NEWTON
C581





INTERIOR



CEILING



WALL



SURFACE

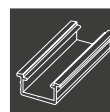

PROFILE



FIT

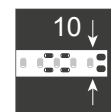

MAX. LED WIDTH



CLIP FASTENING

ANGELO
Ref. B887

High-quality rigid ABS diffuser designed to fit with our ABS profile **ANGELO**.

In this case just insert the LED strip inside the profile, then insert the diffuser into the profile and finally attach the assembly with the fastening clip.

TECHNICAL SPECIFICATIONS:

Material:	ABS
Colour:	● Opal
Max. power:	15 W/m
Fire resistant:	UL94 HB.
Temperature:	-25 °C — +75 °C
Guarantee:	5 years*
Life cycle:	25+ years
Length of diffuser:	2.60m

* When properly installed, used and maintained

COMPATIBLE LEDS:

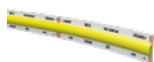

COB EGON 12V/11W

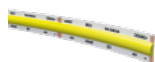

COB EGON 24V/15W



COB EGON RGB 24V/12W

WHEN USING OUR DIFFUSERS THERE IS A LUMEN LOSS OF 25% TO 35% DEPENDING ON THE THICKNESS OF THE DIFFUSER.

COMPATIBLE PROFILES:



Profile
ANGEL B888

12/24V COMPATIBLE ACCESSORIES:



Power supply
17FA-140-12 20W/60W/100W
17FA-141-24 30W/75W/120W/180W



Pseudo-touch Sensor Switch
For cupboards and drawers
17AE-033
100-240V 300W



Presence sensor
for doors
17AE-026
12V/36W-24V/72W



Sensor ON-OFF
Surface dimmer
17AE-024
12V/36W-24V/72W



Sensor Switch
Bluetouch indicator light
17AE-021
12-24V



Sensor ON-OFF
Recessed dimmer
17AE-023
12V/36W-24V/72W



Motion sensor
Detection 0.5-2m
76x35x19.5
17AE-025

RGB COMPATIBLE ACCESSORIES:



RGBW sequencer
6A x channel Max. 10A
Battery not included
17AE-150



Wifi RGBW sequencer
4 channels Max. 15A
17AE-151



Power supply
17FA-141-24
30W/75W/120W/180W

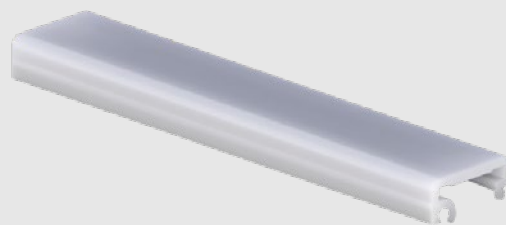

SECTION:

Tolerance +0.3/-0.2

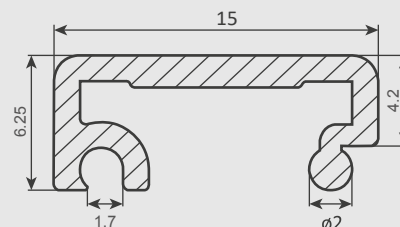

INSTALLATION:



SURFACE

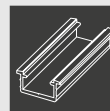

PROFILE



FIT

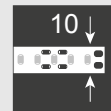

MAX. LED WIDTH



CLIP FASTENING

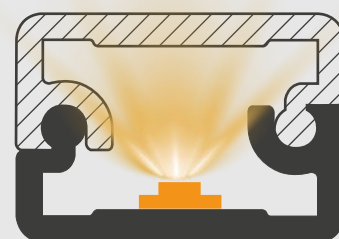

ANGELO
B888





INTERIOR



CEILING



WALL



WORK TIME

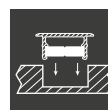

MILLING

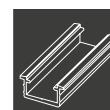

PROFILE

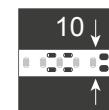

MAX. LED WIDTH

GOYA
Ref. C218

High-quality rigid ABS diffuser, to be applied in millings without the use of any clamping profile.
Designed to insert the LED strip inside without a clamping profile or heat sink, or with our aluminium plate **THOMAS**.

TECHNICAL SPECIFICATIONS:

Material:	ABS
Colour:	● Opal
Max. power with heat sink:	30 W/m
Fire resistant:	UL94 HB.
Temperature:	-25 °C – +75 °C
Guarantee:	5 years*
Life cycle:	25+ years
Length of diffuser::	2.60m

* When properly installed, used and maintained

COMPATIBLE LEDS:



COB EGON 12V/11W



COB EGON 24V/15W



COB EGON RGB
24V/12W



NIKOLA 220V
*without aluminium plate

WHEN USING OUR DIFFUSERS THERE IS A LUMEN LOSS OF 25% TO 35% DEPENDING ON THE THICKNESS OF THE DIFFUSER.

COMPATIBLE PROFILES:



Aluminium plate
THOMAS C219

220V COMPATIBLE ACCESSORIES:



Pseudo-touch Sensor Switch
For cupboards and drawers
17AE-033
100-240V 300W



Motion sensor
Detection 0.5-2m
76x35x19.5
17AE-025

12/24V COMPATIBLE ACCESSORIES:



Power supply
17FA-140-12 20W/60W/100W
17FA-141-24 30W/75W/120W/180W



Pseudo-touch Sensor Switch
For cupboards and drawers
17AE-033
100-240V 300W



Presence sensor
for doors
17AE-026
12V/36W-24V/72W



Sensor ON-OFF
Surface dimmer
17AE-024
12V/36W-24V/72W



Sensor Switch
Bluetouch indicator light
17AE-021
12-24V



Sensor ON-OFF
Recessed dimmer
17AE-023
12V/36W-24V/72W



Motion sensor
Detection 0.5-2m
76x35x19.5
17AE-025

RGB COMPATIBLE ACCESSORIES:



RGBW sequencer
6A x channel Max. 10A
Battery not included
17AE-150



Wifi RGBW sequencer
4 channels Max.15A
17AE-151



Power supply
17FA-141-24
30W/75W/120W/180W

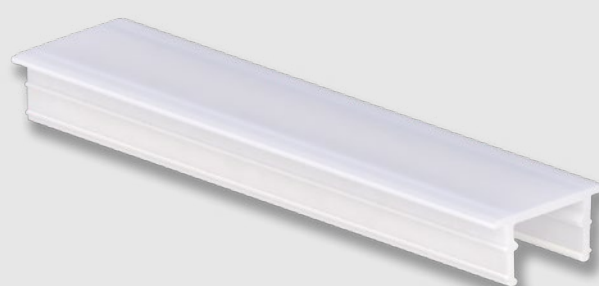

SECTION:
Tolerance +0.3/-0.2

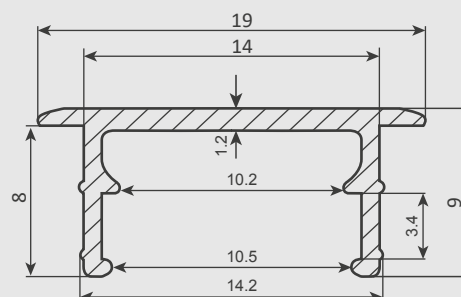

INSTALLATION:



CEILING



WALL



MILLING

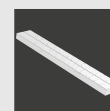

AL. PLATE

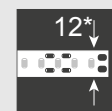

MAX. LED WIDTH

*without aluminium plate



THOMAS C219



NIKOLA

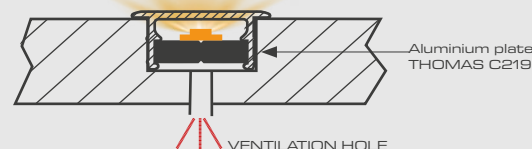

Aluminium plate
THOMAS C219

VENTILATION HOLE

MILLING:

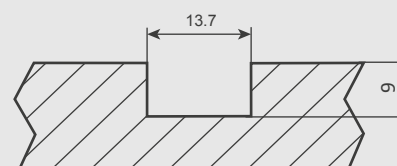

Remember to do the milling on the surface when you receive the product and check its tolerance.





INTERIOR



CEILING



WALL



WORK TIME



LED 220V

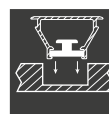

MILLING

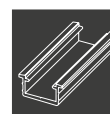

PROFILE

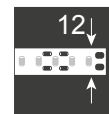

MAX. LED WIDTH

ADOLPHE
Ref. C316

High-quality rigid ABS diffuser, to be used with our heat sink profile **MARCONI**.

In this case simply mill, place the LED strip inside and then insert the diffuser into the slot.

For this application, we recommend using LEDs with a maximum power of 14 W.

TECHNICAL SPECIFICATIONS:

Material:	ABS
Colour:	Opal
Max. power with heat sink:	30 W/m
Fire resistant:	UL94 HB.
Temperature:	-25 °C – +75 °C
Guarantee:	5 years*
Life cycle:	25+ years
Length of diffuser::	2.60m

* When properly installed, used and maintained

COMPATIBLE LEDs:

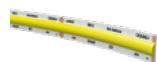

COB EGON 12V/11W

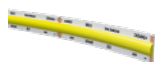

COB EGON 24V/15W

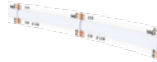

COB EGON RGB
24V/12W



NIKOLA 220V

WHEN USING OUR DIFFUSERS THERE IS A LUMEN LOSS OF 25% TO 35% DEPENDING ON THE THICKNESS OF THE DIFFUSER.

COMPATIBLE PROFILES:



Aluminium profile
MARCONI C220

220V COMPATIBLE ACCESSORIES:



Pseudo-touch Sensor Switch
For cupboards and drawers
17AE-033
100-240V 300W



Motion sensor
Detection 0.5-2m
76x35x19.5
17AE-025

12/24V COMPATIBLE ACCESSORIES:



Power supply
17FA-140-12 20W/60W/100W
17FA-141-24 30W/75W/120W/180W



Pseudo-touch Sensor Switch
For cupboards and drawers
17AE-033
100-240V 300W



Presence sensor
for doors
17AE-026
12V/36W-24V/72W



Sensor ON-OFF
Surface dimmer
17AE-024
12V/36W-24V/72W



Sensor Switch
Bluetouch indicator light
17AE-021
12-24V



Sensor ON-OFF
Recessed dimmer
17AE-023
12V/36W-24V/72W



Motion sensor
Detection 0.5-2m
76x35x19.5
17AE-025

RGB COMPATIBLE ACCESSORIES:



RGBW sequencer
6A x channel Max. 10A
Battery not included
17AE-150



Wifi RGBW sequencer
4 channels Max.15A
17AE-151



Power supply
17FA-141-24
30W/75W/120W/180W

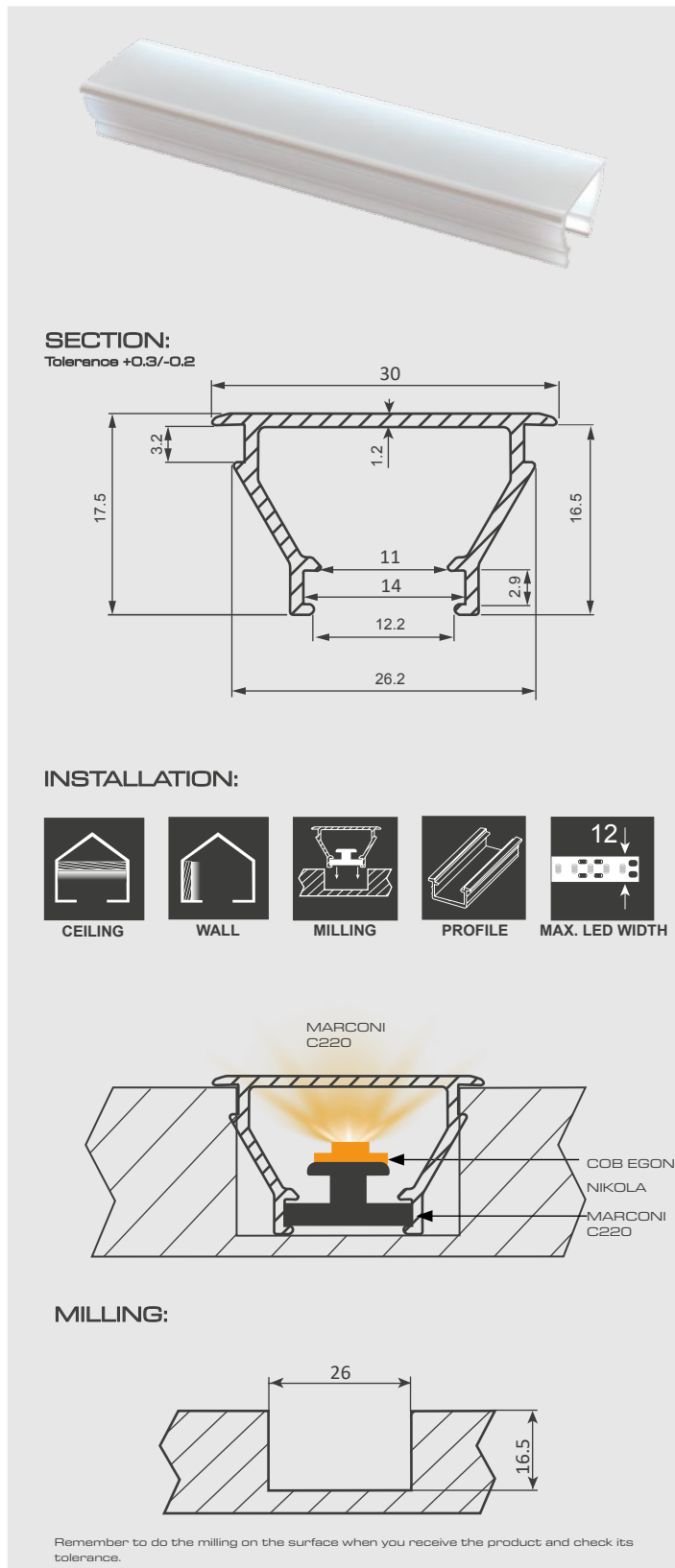



INTERIOR



EXTERIOR



FLEXIBLE



CEILING



WALL



FLOOR



MILLING

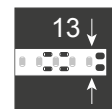

MAX. LED WIDTH



ROLL

JOBS

Ref. B137

Flexible diffuser made from high-quality PVC.

It helps eliminate the LED bright spot and protect it from dirt and knocks.

Designed to be inserted directly into a moulding/channel without the need to use any type of attachment profile or heat sink. It can also be used with our **THOMAS** aluminium plate, designed for dissipating the heat produced by LED strips.

TECHNICAL SPECIFICATIONS:

Material:	PVC
Lateral bending:	R = 80 mm
Colour:	Opal/Semiopal/Crystalline
Fire resistant:	UL94 Self-extinguishing VO
Temperature:	-20 °C — +65 °C
Guarantee:	5 years ²
Life cycle:	25+ years
Packaging:	50-metre roll.

¹ More colours on request

² When properly installed, used and maintained

COMPATIBLE LEDS



COB EGON 12V/11W



COB EGON 24V/15W



COB EGON RGB
24V/12W



NIKOLA 220V

WHEN USING OUR DIFFUSERS THERE IS A LUMEN LOSS OF 25% TO 35% DEPENDING ON THE THICKNESS OF THE DIFFUSER.

COMPATIBLE PROFILES:



Aluminium plate
THOMAS C219

220V COMPATIBLE ACCESSORIES:



Pseudo-touch Sensor Switch
For cupboards and drawers
17AE-033
100-240V 300W



Motion sensor
Detection 0.5-2m
76x35x19.5
17AE-025

12/24V COMPATIBLE ACCESSORIES:



Power supply
17FA-140-12 20W/60W/100W
17FA-141-24 30W/75W/120W/180W



Pseudo-touch Sensor Switch
For cupboards and drawers
17AE-033
100-240V 300W



Presence sensor
for doors
17AE-026
12V/36W-24V/72W



Sensor ON-OFF
Surface dimmer
17AE-024
12V/36W-24V/72W



Sensor Switch
Bluetouch indicator light
17AE-021
12-24V



Sensor ON-OFF
Recessed dimmer
17AE-023
12V/36W-24V/72W



Motion sensor
Detection 0.5-2m
76x35x19.5
17AE-025

RGB COMPATIBLE ACCESSORIES:



RGBW sequencer
6A x channel Max. 10A
Battery not included
17AE-150



Wifi RGBW sequencer
4 channels Max.15A
17AE-151



Power supply
17FA-141-24
30W/75W/120W/180W



SECTION:

Tolerance +0.3/-0.2

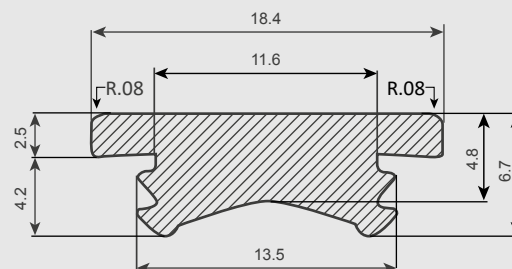

INSTALLATION:



CEILING



WALL



FLOOR



MILLING



AL. PLATE



MAX. LED WIDTH

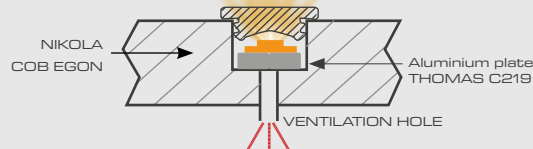
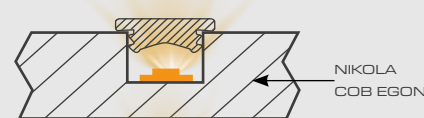

MILLING:

Moulding without plate

Moulding with plate

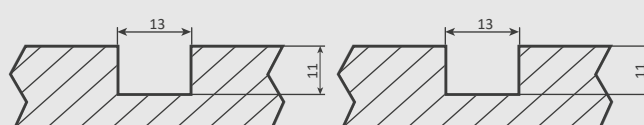

Remember to do the milling on the surface when you receive the product and check its tolerance.





INTERIOR



EXTERIOR



FLEXIBLE



CEILING



WALL



FLOOR



MILLING

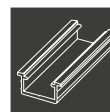

PROFILE

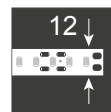

MAX. LED WIDTH



ROLL

TIZIANO

Ref. B258

Flexible diffuser made from high-quality PVC.

It helps eliminate the LED bright spot and protect it from dirt and knocks.

Designed to be inserted directly into a moulding/channel without the need to use any type of attachment profile or heat sink. It can also be attached with our **RUBIK** profile, without the need for milling, or with our **THOMAS** aluminium plate, designed to dissipate the heat produced by LED strips.

TECHNICAL SPECIFICATIONS:

Material:	PVC
Lateral bending:	R = 50 mm
Colour:	Opal/Semiopal/Crystalline
Fire resistant:	UL94 Self-extinguishing VO
Temperature:	-20 °C — +65 °C
Guarantee:	5 years ²
Life cycle:	25+ years
Packaging:	50-metre roll.

¹ More colours on request ² When properly installed, used and maintained

COMPATIBLE LEDs:



COB EGON 12V/11W



COB EGON 24V/15W



COB EGON RGB
24V/12W



NIKOLA 220V

WHEN USING OUR DIFFUSERS THERE IS A LUMEN LOSS OF 25% TO 35% DEPENDING ON THE THICKNESS OF THE DIFFUSER.

COMPATIBLE PROFILES:



RUBIK B579



Aluminium plate
THOMAS C219

220V COMPATIBLE ACCESSORIES:



Pseudo-touch Sensor Switch
For cupboards and drawers
17AE-033
100-240V 300W



Motion sensor
Detection 0.5-2m
76x35x19.5
17AE-025

12/24V COMPATIBLE ACCESSORIES:



Power supply
17FA-140-12 20W/60W/100W
17FA-141-24 30W/75W/120W/180W



Pseudo-touch Sensor Switch
For cupboards and drawers
17AE-033
100-240V 300W



Presence sensor
for doors
17AE-026
12V/36W-24V/72W



Sensor ON-OFF
Surface dimmer
17AE-024
12V/36W-24V/72W



Sensor Switch
Bluetouch indicator light
17AE-021
12-24V



Sensor ON-OFF
Recessed dimmer
17AE-023
12V/36W-24V/72W



Motion sensor
Detection 0.5-2m
76x35x19.5
17AE-025

RGB COMPATIBLE ACCESSORIES:



RGBW sequencer
6A x channel Max. 10A
Battery not included
17AE-150



Wifi RGBW sequencer
4 channels Max.15A
17AE-151



Power supply
17FA-141-24
30W/75W/120W/180W

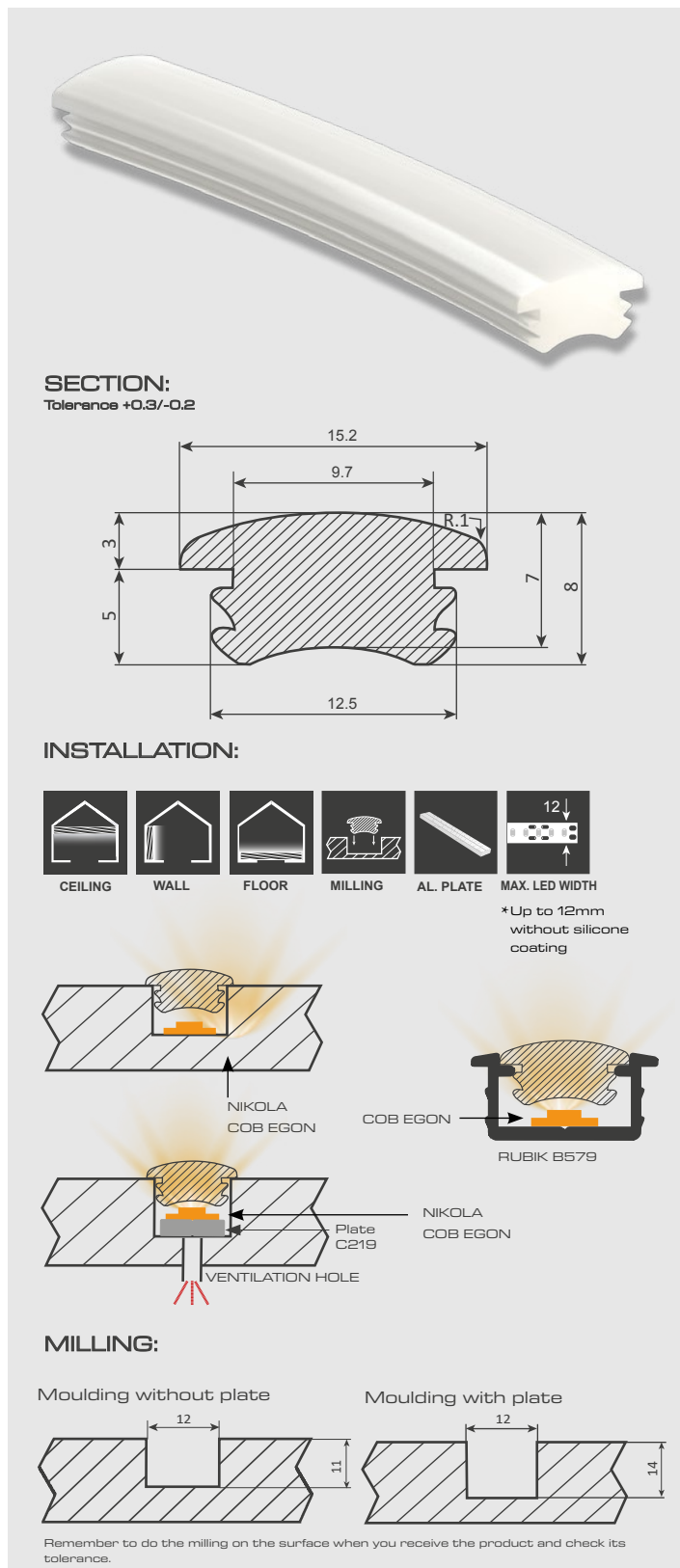



INTERIOR



EXTERIOR



FLEXIBLE



CEILING



WALL



FLOOR



MILLING

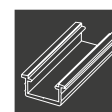

PROFILE

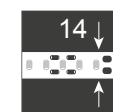

MAX. LED WIDTH



ROLL

VELAZQUEZ

Ref. B136

Flexible diffuser made from high-quality PVC. It helps eliminate the LED bright spot and protect it from dirt and knocks. Designed to be inserted directly into a moulding/channel without the need to use any type of attachment profile or heat sink. It can also be attached with our **FRANKLIN** profile, without the need for milling, or with our **THOMAS** aluminium plate, designed to dissipate the heat produced by LED strips.

TECHNICAL SPECIFICATIONS:

Material:	PVC
Lateral bending:	R = 80 mm
Colour:	Opal/Semiopal/Crystalline
Fire resistant:	UL94 Self-extinguishing VO
Temperature:	-20 °C — +65 °C
Guarantee:	5 years ²
Life cycle:	25+ years
Packaging:	40-metre roll

¹ More colours on request ² When properly installed, used and maintained

COMPATIBLE LEDS:



WHEN USING OUR DIFFUSERS THERE IS A LUMEN LOSS OF 25% TO 35% DEPENDING ON THE THICKNESS OF THE DIFFUSER.

COMPATIBLE PROFILES:



FRANKLIN B580

Aluminium plate THOMAS C219

220V COMPATIBLE ACCESSORIES:



Pseudo-touch Sensor Switch For cupboards and drawers 17AE-033 100-240V 300W
Motion sensor Detection 0.5-2m 76x35x19.5 17AE-025

12/24V COMPATIBLE ACCESSORIES:



Power supply 17FA-140-12 20W/60W/100W 17FA-141-24 30W/75W/120W/180W
Pseudo-touch Sensor Switch For cupboards and drawers 17AE-033 100-240V 300W
Presence sensor for doors 17AE-026 12V/36W-24V/72W



Sensor ON-OFF Surface dimmer 17AE-024 12V/36W-24V/72W
Sensor Switch Bluetouch indicator light 17AE-021 12-24V
Sensor ON-OFF Recessed dimmer 17AE-023 12V/36W-24V/72W
Motion sensor Detection 0.5-2m 76x35x19.5 17AE-025

RGB COMPATIBLE ACCESSORIES:



RGBW sequencer 6A x channel Max. 10A Battery not included 17AE-150
Wifi RGBW sequencer 4 channels Max. 15A 17AE-151
Power supply 17FA-141-24 30W/75W/120W/180W

SECTION:

Tolerance +0.3/-0.2

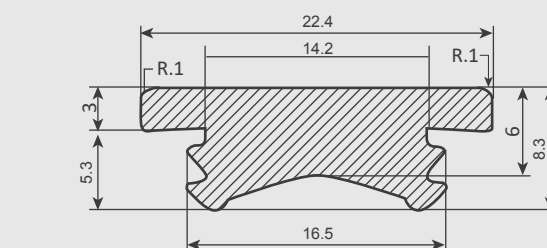

INSTALLATION:

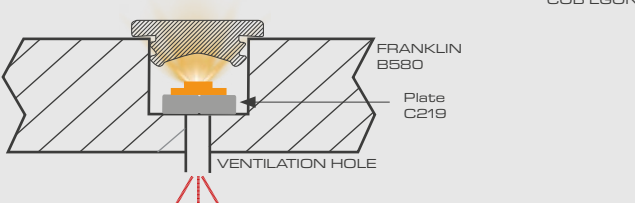
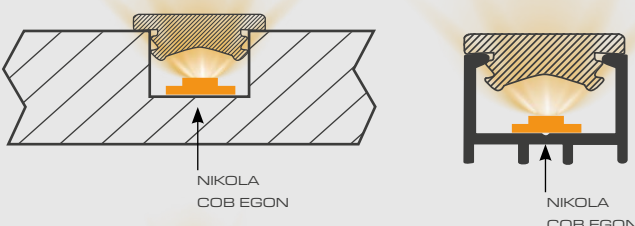
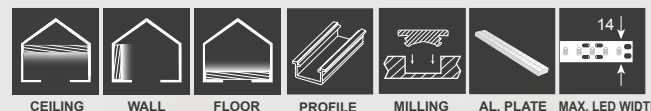

MILLING:

Moulding without plate

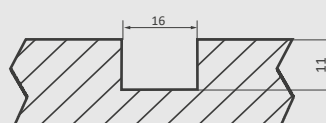

Moulding with plate

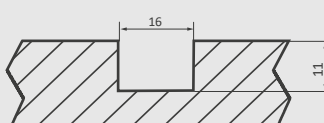

Remember to do the milling on the surface when you receive the product and check its tolerance.





INTERIOR



EXTERIOR



FLEXIBLE



CEILING



WALL



FLOOR



MILLING

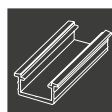

PROFILE

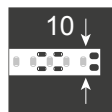

MAX. LED WIDTH



ROLL

WARHOL Ref. B304

Flexible diffuser made from high-quality PVC. It helps eliminate the LED bright spot and protect it from dirt and knocks.

Designed to be inserted directly into a moulding/channel without the need to use any type of attachment profile or heat sink. It can be inserted into our **VOLTA, FRIDA, CEZANNE Y KANDINSKY** aluminium profiles.

TECHNICAL SPECIFICATIONS:

Material:	PVC
Lateral bending:	R = 50 mm
Colour:	Opal/Semiopal/Crystalline
Fire resistant:	UL94 Self-extinguishing VO
Temperature:	-20 °C — +65 °C
Guarantee:	5 years ²
Life cycle:	25+ years
Packaging:	50-metre roll.

¹ More colours on request

² When properly installed, used and maintained

COMPATIBLE LEDS

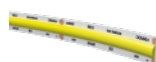

COB EGON 12V/11W



COB EGON 24V/15W*
*Depending on the application



COB EGON RGB 24V/12W
*Depending on the application

WHEN USING OUR DIFFUSERS THERE IS A LUMEN LOSS OF 25% TO 35% DEPENDING ON THE THICKNESS OF THE DIFFUSER.

COMPATIBLE PROFILES:



VOLTA B781



CEZANNE B459



FRIDA B659



KANDINSKY B303

12/24V COMPATIBLE ACCESSORIES:



Power supply
17FA-140-12 20W/60W/100W
17FA-141-24 30W/75W/120W/180W



Pseudo-touch Sensor Switch
For cupboards and drawers
17AE-033
100-240V 300W



Presence sensor
for doors
17AE-026
12V/36W-24V/72W



Sensor ON-OFF
Surface dimmer
17AE-024
12V/36W-24V/72W



Sensor Switch
Bluetooth indicator light
17AE-021
12-24V



Sensor ON-OFF
Recessed dimmer
17AE-023
12V/36W-24V/72W



Motion sensor
Detection 0.5-2m
76x35x19.5
17AE-025

RGB COMPATIBLE ACCESSORIES:



RGBW sequencer
6A x channel Max. 10A
Battery not included
17AE-150



Wifi RGBW sequencer
4 channels Max.15A
17AE-151



Power supply
17FA-141-24
30W/75W/120W/180W



SECTION:

Tolerance +0.3/-0.2

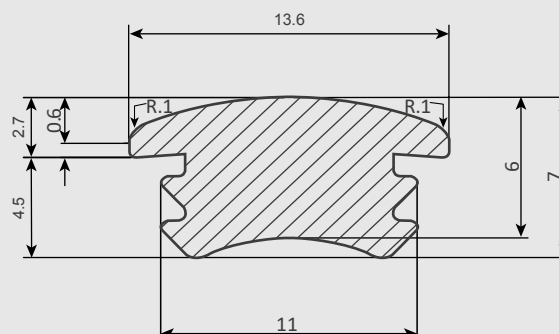

INSTALLATION:

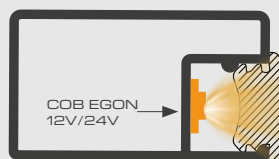

CEZANNE

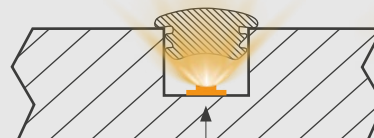

MILLING:

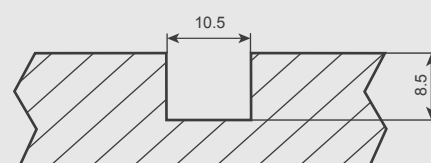

Remember to mill the surface when you receive the product and check its tolerance.





INTERIOR



EXTERIOR



FLEXIBLE



CEILING



WALL



FLOOR

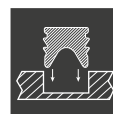

MILLING

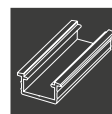

PROFILE

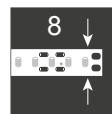

MAX. LED WIDTH



50M ROLL

HARRISON

Ref. C116

Flexible diffuser made from high-quality PVC. It helps eliminate the LED bright spot and protect it from dirt and knocks.

Designed to be inserted directly into a moulding/channel without the need to use any type of attachment profile or heat sink.

It can also be inserted into our aluminium profiles **VOLTA**, **REMBRANDT** or our **PVC** profile **KANDINSKY**.

TECHNICAL SPECIFICATIONS:

Material:	PVC
Lateral bending:	R = 80 mm
Colour:	Opal/Semiopal/Crystalline
Fire resistant:	UL94 Self-extinguishing VO
Temperature:	-20 °C – +65 °C
Guarantee:	5 years ²
Life cycle:	25+ years
Packaging:	50-metre roll.

¹ More colours on request

² When properly installed, used and maintained

COMPATIBLE LEDS



COB EGON 12V/11W



COB EGON 24V/15W*
*Depending on the application

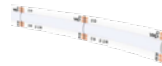

COB EGON RGB 24V/12W
*Depending on the application

WHEN USING OUR DIFFUSERS THERE IS A LUMEN LOSS OF 25% TO 35% DEPENDING ON THE THICKNESS OF THE DIFFUSER.

COMPATIBLE PROFILES:

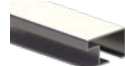

VOLTA B781



REMBRANDT B582



KANDINSKY B303

12/24V COMPATIBLE ACCESSORIES:



Power supply
17FA-140-12 20W/60W/100W
17FA-141-24 30W/75W/120W/180W



Pseudo-touch Sensor Switch
For cupboards and drawers
17AE-033 100-240V 300W



Presence sensor
for doors
17AE-026 12V/36W-24V/72W



Sensor ON-OFF
Surface dimmer
17AE-024 12V/36W-24V/72W



Sensor Switch
Bluetooth indicator light
17AE-021 12-24V



Sensor ON-OFF
Recessed dimmer
17AE-023 12V/36W-24V/72W



Motion sensor
Detection 0.5-2m
76x35x19.5 17AE-025

RGB COMPATIBLE ACCESSORIES:



RGBW sequencer
6A x channel Max. 10A
Battery not included
17AE-150



Wifi RGBW sequencer
4 channels Max. 15A
17AE-151



Power supply
17FA-141-24 30W/75W/120W/180W

SECTION:

Tolerance +0.3/-0.2

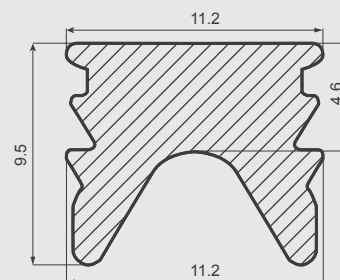

INSTALLATION:



CEILING



WALL



FLOOR



PROFILE



MILLING



MAX. LED WIDTH



MAX. LED WIDTH MILLING

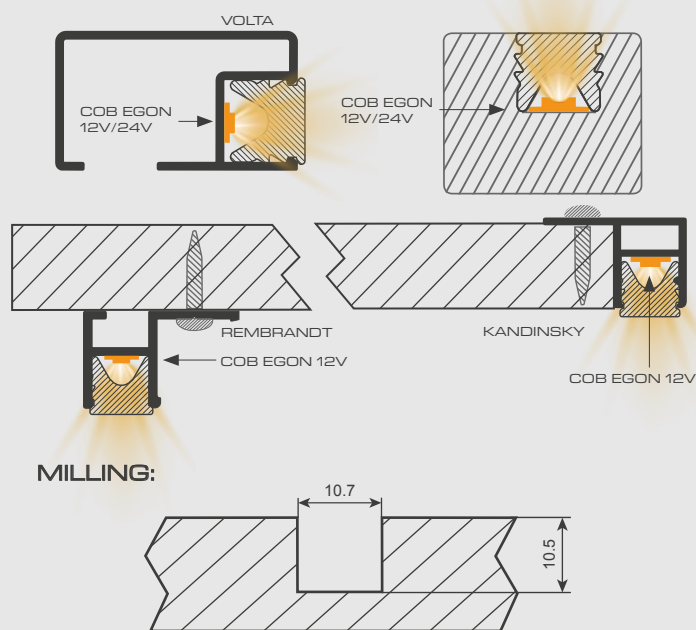

Remember to mill the surface when you receive the product and check its tolerance.





INTERIOR



EXTERIOR



FLEXIBLE



SURFACE

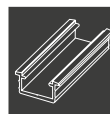

PROFILE

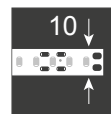

MAX. LED WIDTH



50M ROLL

FULTON Ref. CO15

Flexible diffuser made from high-quality PVC.
It helps eliminate the LED bright spot and protect it from dirt and knocks.

Designed to be installed on the surface with an attachment profile or heat sink, without the need for moulding.

We recommend application with our **VERMEER B298** profile.

TECHNICAL SPECIFICATIONS:

Material:	PVC
Lateral bending:	R = 80 mm
Colour:	Opal/Semiopal/Crystalline
Fire resistant:	UL94 Self-extinguishing VO
Temperature:	-20 °C — +65 °C
Guarantee:	5 years ²
Life cycle:	25+ years
Packaging:	50-metre roll.

¹ More colours on request

² When properly installed, used and maintained

COMPATIBLE LEDS



COB EGON 12V/11W

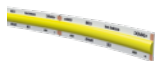

COB EGON 24V/15W^{*}



COB EGON RGB 24V/12W

WHEN USING OUR DIFFUSERS THERE IS A LUMEN LOSS OF 25% TO 35% DEPENDING ON THE THICKNESS OF THE DIFFUSER.

COMPATIBLE PROFILES:



VERMEER B298

12/24V COMPATIBLE ACCESSORIES:



Power supply
17FA-140-12 20W/60W/100W
17FA-141-24 30W/75W/120W/180W



Pseudo-touch Sensor Switch
For cupboards and drawers
17AE-033
100-240V 300W



Presence sensor
for doors
17AE-026
12V/36W-24V/72W



Sensor ON-OFF
Surface dimmer
17AE-024
12V/36W-24V/72W



Sensor Switch
Bluetouch indicator light
17AE-021
12-24V



Sensor ON-OFF
Recessed dimmer
17AE-023
12V/36W-24V/72W



Motion sensor:
Detection 0.5-2m
76x35x19.5
17AE-025

RGB COMPATIBLE ACCESSORIES:



RGBW sequencer
6A x channel Max. 10A
Battery not included
17AE-150



Wifi RGBW sequencer
4 channels Max. 15A
17AE-151



Power supply
17FA-141-24
30W/75W/120W/180W

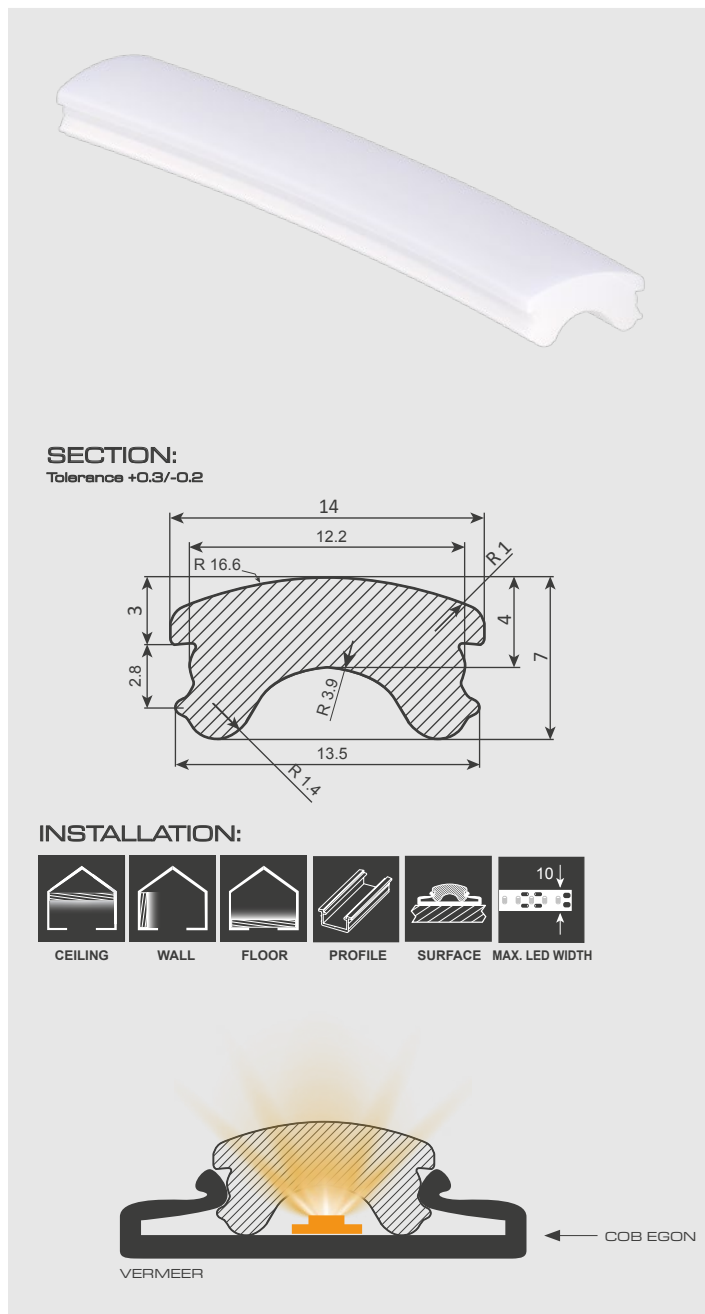



INTERIOR



EXTERIOR



FLEXIBLE



MILLING



CEILING



WALL



FLOOR

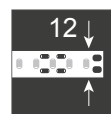

MAX. LED WIDTH



50M ROLL

EDISON

Ref. C056

Flexible diffuser made from high-quality PVC.
It helps eliminate the LED bright spot and protect it from dirt and knocks.

Designed to be inserted directly into a moulding/channel without the need to use any type of attachment profile or heat sink. It can also be used with our **THOMAS**, which is ideal for dissipating the heat produced by LED strips.

TECHNICAL SPECIFICATIONS:

Material:	PVC
Lateral bending:	R = 80 mm
Colour:	Opal/Semiopal/Crystalline
Fire resistant:	UL94 Self-extinguishing VO
Temperature:	-20 °C — +65 °C
Guarantee:	5 years ²
Life cycle:	25+ years
Packaging:	50-metre roll.

¹ More colours on request

² When properly installed, used and maintained

COMPATIBLE LEDS



WHEN USING OUR DIFFUSERS THERE IS A LUMEN LOSS OF 25% TO 35% DEPENDING ON THE THICKNESS OF THE DIFFUSER.

COMPATIBLE PROFILES:



Aluminium plate
THOMAS C219

220V COMPATIBLE ACCESSORIES:



Pseudo-touch Sensor Switch
For cupboards and drawers
17AE-033
100-240V 300W

Motion sensor
Detection 0.5-2m
76x35x19.5
17AE-025

12/24V COMPATIBLE ACCESSORIES:



Power supply
17FA-140-12 20W/60W/100W
17FA-141-24 30W/75W/120W/180W

Pseudo-touch Sensor Switch
For cupboards and drawers
17AE-033
100-240V 300W

Presence sensor
for doors
17AE-026
12V/36W-24V/72W

Sensor ON-OFF
Surface dimmer
17AE-024
12V/36W-24V/72W

Sensor Switch
Bluetouch indicator light
17AE-021
12-24V

Sensor ON-OFF
Recessed dimmer
17AE-023
12V/36W-24V/72W

Motion sensor
Detection 0.5-2m
76x35x19.5
17AE-025

RGB COMPATIBLE ACCESSORIES:



RGBW sequencer
6A x channel Max. 10A
Battery not included
17AE-150

Wifi RGBW sequencer
4 channels Max.15A
17AE-151

Power supply
17FA-141-24
30W/75W/120W/180W



SECTION:

Tolerance +0.3/-0.2

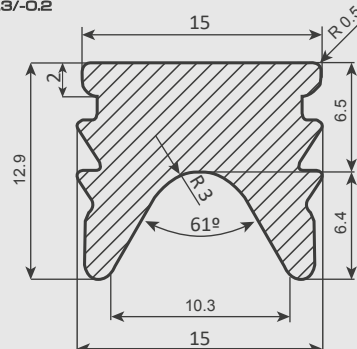

INSTALLATION:

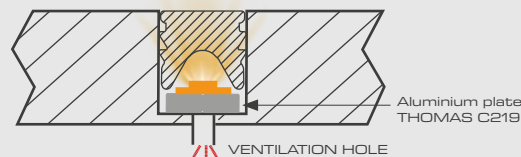

MILLING:

Moulding without plate



Moulding with plate

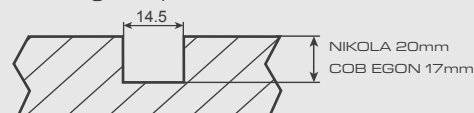

Remember to mill the surface when you receive the product and check its tolerance.





INTERIOR



EXTERIOR



FLEXIBLE



LED POWER



CEILING



WALL

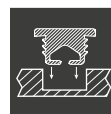

MILLING

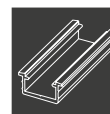

PROFILE

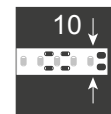

MAX. LED WIDTH



ROLL

VAN GOGH

Ref. B287

Flexible profile-diffuser made from high-quality PVC. It helps eliminate the LED bright spot and protect it from dirt and knocks.

Designed to be inserted directly into a moulding/channel without the need to use any type of attachment profile or heat sink.

It can also be installed on the surface with an attachment profile or heat sink, without the need for moulding.

TECHNICAL SPECIFICATIONS:

Material:	PVC
Lateral bending:	R = 100 mm
Colour:	Opal/Semiopal/Crystalline
Fire resistant:	UL94 Self-extinguishing VO
Temperature:	-20 °C — +65 °C
Guarantee:	5 years ²
Life cycle:	25+ years
Packaging:	25-metre roll

¹ More colours on request

² When properly installed, used and maintained

COMPATIBLE LEDS

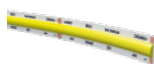

COB EGON 12V/11W

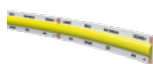

COB EGON 24V/15W



COB EGON RGB 24V/12W

WHEN USING OUR PROFILES/DIFFUSERS THERE IS A LUMEN LOSS OF 25% TO 35% DEPENDING ON THE THICKNESS OF THE DIFFUSER.

COMPATIBLE PROFILES:



FRANKLIN B580 aluminium profile

12/24V COMPATIBLE ACCESSORIES:



Power supply
17FA-140-12 20W/60W/100W
17FA-141-24 30W/75W/120W/180W



Pseudo-touch Sensor Switch
For cupboards and drawers
17AE-033
100-240V 300W



Presence sensor
for doors
17AE-026
12V/36W-24V/72W



Sensor ON-OFF
Surface dimmer
17AE-024
12V/36W-24V/72W



Sensor Switch
Bluetouch indicator light
17AE-021
12-24V



Sensor ON-OFF
Recessed dimmer
17AE-023
12V/36W-24V/72W



Motion sensor
Detection 0.5-2m
76x35x19.5
17AE-025

RGB COMPATIBLE ACCESSORIES:



RGBW sequencer
6A x channel Max. 10A
Battery not included
17AE-150



Wifi RGBW sequencer
4 channels Max.15A
17AE-151



Power supply
17FA-141-24
30W/75W/120W/180W



SECTION:

Tolerance ± 0.4

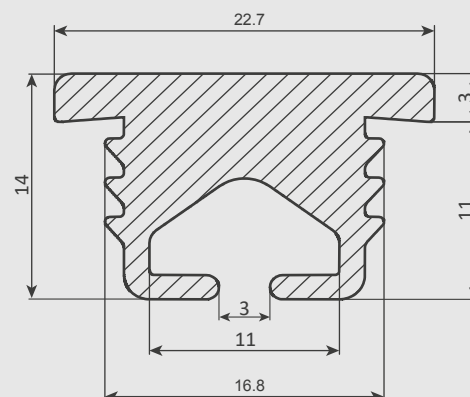

INSTALLATION:



CEILING



WALL



PROFILE



SURFACE



MAX. LED WIDTH

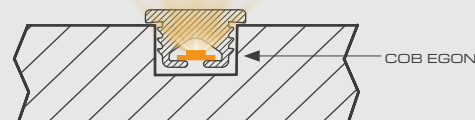
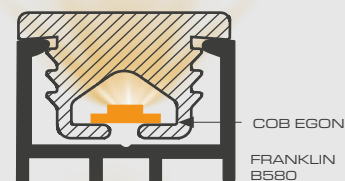

MILLING:

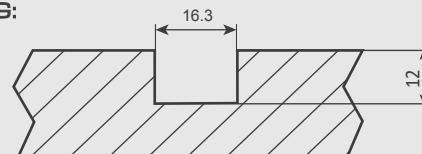

Remember to mill the surface when you receive the product and check its tolerance.





INTERIOR



EXTERIOR



FLEXIBLE



LED POWER



CEILING



WALL



MILLING

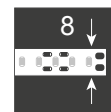

MAX. LED WIDTH



ROLL

DA VINCI Ref. B618

Flexible profile-diffuser made from high-quality PVC.
It helps eliminate the LED bright spot and protect it from dirt and knocks.

Designed to be inserted directly into a moulding/channel without the need to use any type of attachment profile or heat sink.

TECHNICAL SPECIFICATIONS:

Material:	PVC
Lateral bending:	R = 80 mm
Colour:	Opal/Semiopal/Crystalline
Fire resistant:	UL94 Self-extinguishing VO
Temperature:	-20 °C — +65 °C
Guarantee:	5 years ²
Life cycle:	25+ years
Packaging:	25-metre roll

¹ More colours on request

² When properly installed, used and maintained

COMPATIBLE LEDS

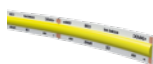

COB EGON 12V/11W

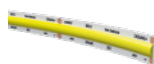

COB EGON 24V/15W



COB EGON RGB 24V/12W

WHEN USING OUR PROFILES/DIFFUSERS THERE IS A LUMEN LOSS OF 25% TO 35% DEPENDING ON THE THICKNESS OF THE DIFFUSER.

12/24V COMPATIBLE ACCESSORIES:



Power supply
17FA-140-12 20W/60W/100W
17FA-141-24 30W/75W/120W/180W



Pseudo-touch Sensor Switch
For cupboards and drawers
17AE-033
100-240V 300W



Presence sensor
for doors
17AE-026
12V/36W-24V/72W



Sensor ON-OFF
Surface dimmer
17AE-024
12V/36W-24V/72W



Sensor Switch
Bluetouch indicator light
17AE-021
12-24V



Sensor ON-OFF
Recessed dimmer
17AE-023
12V/36W-24V/72W



Motion sensor
Detection 0.5-2m
76x35x19.5
17AE-025

RGB COMPATIBLE ACCESSORIES:



RGBW sequencer
6A x channel Max. 10A
Battery not included
17AE-150



Wifi RGBW sequencer
4 channels Max.15A
17AE-151



Power supply
17FA-141-24
30W/75W/120W/180W



SECTION: Tolerance ±0.4

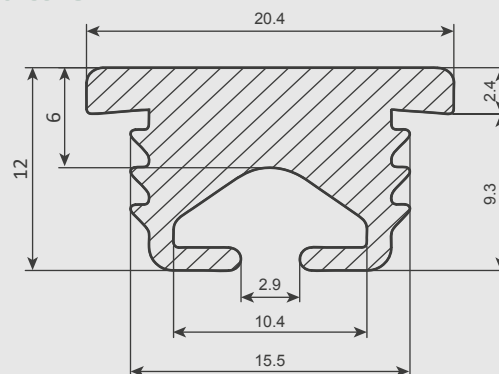

INSTALLATION:



CEILING



WALL



SURFACE



MAX. LED WIDTH

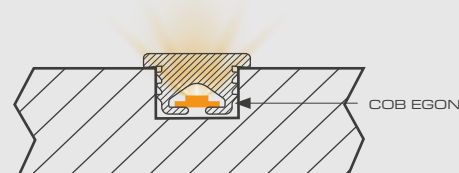

MILLING:

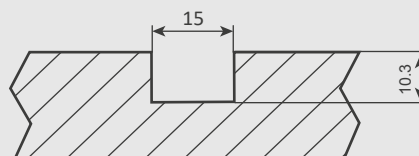

Remember to mill the surface when you receive the product and check its tolerance.





INTERIOR



EXTERIOR



FLEXIBLE

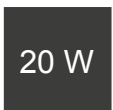

LED POWER



FLOOR



CEILING



WALL



MILLING

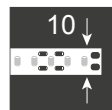

MAX. LED WIDTH



ROLL

MIRÓ
Ref. C136

Flexible profile-diffuser made from high-quality PVC.
It helps eliminate the LED bright spot and protect it from dirt and knocks.
It is delivered in a roll and it can be cut to the desired measurements.

Designed to be inserted directly into a moulding/channel without the need to use any type of attachment profile or heat sink.

TECHNICAL SPECIFICATIONS:

Material:	PVC
Lateral bending:	R = 80 mm
Colour:	Opal/Semiopal/Crystalline
Fire resistant:	UL94 Self-extinguishing VO
Temperature:	-20 °C — +65 °C
Guarantee:	5 years ²
Life cycle:	25+ years
Packaging:	25-metre roll

¹ More colours on request

² When properly installed, used and maintained

COMPATIBLE LEDS



COB EGON 12V/11W



COB EGON 24V/15W



COB EGON RGB 24V/12W

WHEN USING OUR PROFILES/DIFFUSERS THERE IS A LUMEN LOSS OF 25% TO 35% DEPENDING ON THE THICKNESS OF THE DIFFUSER.

12/24V COMPATIBLE ACCESSORIES:



Power supply
17FA-140-12 20W/60W/100W
17FA-141-24 30W/75W/120W/180W



Pseudo-touch Sensor Switch
For cupboards and drawers
17AE-033
100-240V 300W



Presence sensor
for doors
17AE-026
12V/36W-24V/72W



Sensor ON-OFF
Surface dimmer
17AE-024
12V/36W-24V/72W



Sensor Switch
Bluetouch indicator light
17AE-021
12-24V



Sensor ON-OFF
Recessed dimmer
17AE-023
12V/36W-24V/72W



Motion sensor
Detection 0.5-2m
76x35x19.5
17AE-025

RGB COMPATIBLE ACCESSORIES:



RGBW sequencer
6A x channel Max. 10A
Battery not included
17AE-150



Wifi RGBW sequencer
4 channels Max.15A
17AE-151



Power supply
17FA-141-24
30W/75W/120W/180W



SECTION: Tolerance ±0.4

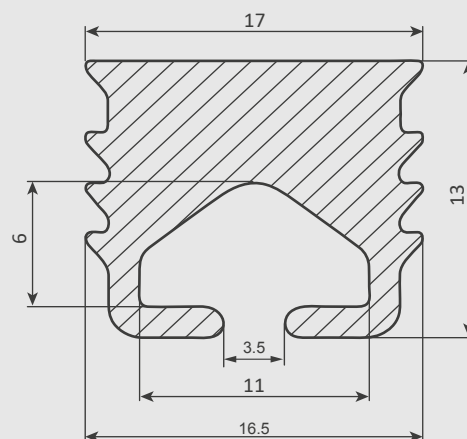

INSTALLATION:



CEILING



WALL



SURFACE



MAX. LED WIDTH

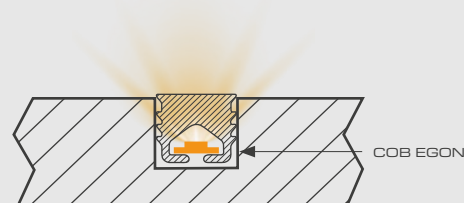

MILLING:

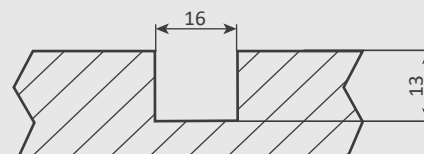

Remember to mill the surface when you receive the product and check its tolerance.





INTERIOR



EXTERIOR



FLEXIBLE



LED POWER



CEILING



WALL



SURFACE

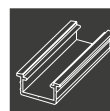

PROFILE

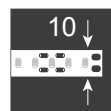

MAX. LED WIDTH



ROLL

PASCAL Ref. C191

Flexible profile-diffuser made from high-quality PVC. It helps eliminate the LED bright spot and protect it from dirt and knocks.

It is delivered in a roll and it can be cut to the desired measurements.

Designed to insert the LED strip inside and attach it to the surface with a clamping profile or heat sink without the need for milling.

TECHNICAL SPECIFICATIONS:

Material:	PVC
Lateral bending:	R = 100 mm
Colour:	Opal/Semiopal/Crystalline
Fire resistant:	UL94 Self-extinguishing VO
Temperature:	-20 °C — +65 °C
Guarantee:	5 years ²
Life cycle:	25+ years
Packaging:	20-metre roll

¹ More colours on request ² When properly installed, used and maintained

COMPATIBLE LEDS

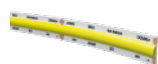

COB EGON 12V/11W

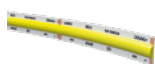

COB EGON 24V/15W



COB EGON RGB 24V/12W

WHEN USING OUR PROFILES/DIFFUSERS THERE IS A LUMEN LOSS OF 25% TO 35% DEPENDING ON THE THICKNESS OF THE DIFFUSER.

COMPATIBLE PROFILES:

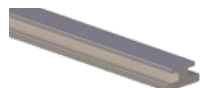

MARCONI C220 aluminium profile



Magnetic profile NOYCE B866

COMPATIBLE COVERS:



Cap with hole*
PASCAL C611



Cap without hole*
PASCAL C612

* To insert the cap with the profile and the diffuser, leave 1 cm of diffuser without profile.

12/24V COMPATIBLE ACCESSORIES:



Power supply
17FA-140-12 20W/60W/100W
17FA-141-24 30W/75W/120W/180W



Pseudo-touch Sensor Switch
For cupboards and drawers
17AE-033
100-240V 300W



Presence sensor
for doors
17AE-026
12V/36W-24V/72W



Sensor ON-OFF
Surface dimmer
17AE-024
12V/36W-24V/72W



Sensor Switch
Bluetooth indicator light
17AE-021
12-24V



Sensor ON-OFF
Recessed dimmer
17AE-023
12V/36W-24V/72W



Motion sensor
Detection 0.5-2m
76x35x19.5
17AE-025

RGB COMPATIBLE ACCESSORIES:



RGBW sequencer
6A x channel Max. 10A
Battery not included
17AE-150



Wifi RGBW sequencer
4 channels Max.15A
17AE-151



Power supply
17FA-141-24
30W/75W/120W/180W



SECTION: Tolerance ±0.4

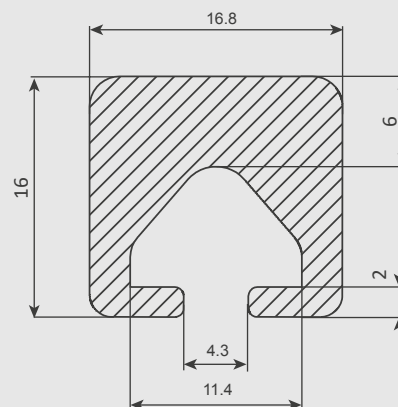

INSTALLATION:



CEILING



WALL



PROFILE



SURFACE



MAX. LED WIDTH

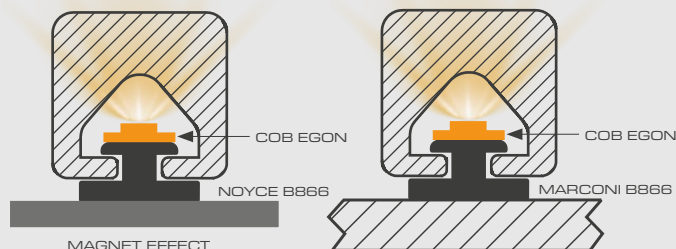

Remember to mill the surface when you receive the product and check its tolerance.





INTERIOR



EXTERIOR



FLEXIBLE



LED POWER



CEILING



WALL



SURFACE

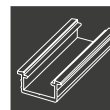

PROFILE

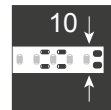

MAX. LED WIDTH



ROLL

FLEMING

Ref. E117

Flexible profile-diffuser made from high-quality silicone rubber. It helps eliminate the LED bright spot and protect it from dirt and knocks.

Designed to insert the LED strip inside and attach it to the surface.

Fully submersible, as professionally certified.

It has different installation options: you can insert two LED strips to obtain 360° lighting or achieve two-colour effects depending on the colour of the LED strip you insert; or a vertical or horizontal LED strip depending on the curves and radius you want to create.

It can also be installed with our **FRANKLIN** profile.

TECHNICAL SPECIFICATIONS:

Material:	Platinum silicone
Lateral bending:	R = 100 mm
Colour:	Pearl White ¹
Fire resistant:	UL94 Self-extinguishing VO
Temperature:	-60 °C — +180 °C
Guarantee:	5 years ²
Life cycle:	25+ years
Packaging:	25-metre roll

¹ More colours on request ² When properly installed, used and maintained

COMPATIBLE LEDS

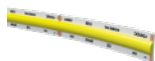

COB EGON 12V/11W

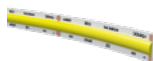

COB EGON 24V/15W

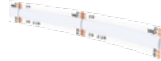

COB EGON RGB 24V/12W

WHEN USING OUR PROFILES/DIFFUSERS THERE IS A LUMEN LOSS OF 25% TO 35% DEPENDING ON THE THICKNESS OF THE DIFFUSER.

COMPATIBLE PROFILES:



Aluminium profile
FRANKLIN B580

COMPATIBLE COVERS:



Cap without hole
FLEMING E117



Cap with hole
FLEMING E117

COMPATIBLE ACCESSORIES:



Plastic clip
C610

12/24V COMPATIBLE ACCESSORIES:



Power supply
17FA-140-12 20W/60W/100W
17FA-141-24 30W/75W/120W/180W



Pseudo-touch Sensor Switch
For cupboards and drawers
17AE-033 100-240V 300W



Presence sensor
for doors
17AE-026 12V/36W-24V/72W



Sensor ON-OFF
Surface dimmer
17AE-024 12V/36W-24V/72W



Sensor Switch
Bluetouch indicator light
17AE-021 12-24V



Sensor ON-OFF
Recessed dimmer
17AE-023 12V/36W-24V/72W



Motion sensor
Detection 0.5-2m
76x35x19.5 17AE-025

RGB COMPATIBLE ACCESSORIES:



RGBW sequencer
8A x channel Max. 10A
Battery not included
17AE-150



Wifi RGBW sequencer
4 channels Max.15A
17AE-151



Power supply
17FA-141-24 30W/75W/120W/180W

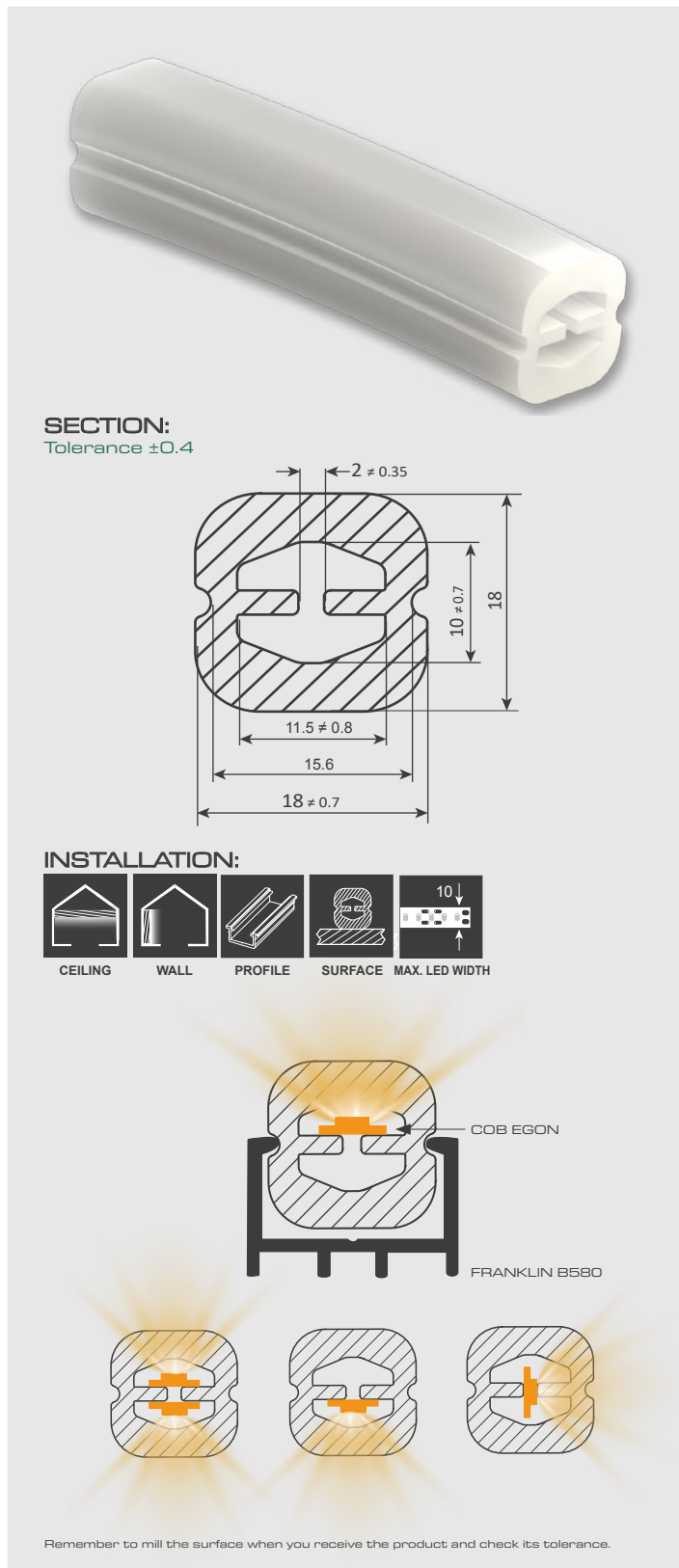

SECTION:

Tolerance ± 0.4

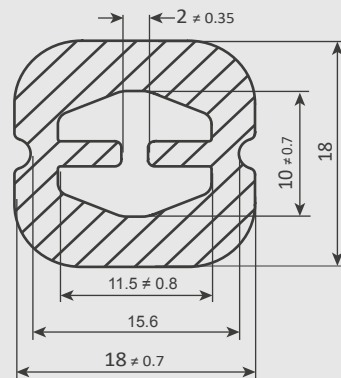

INSTALLATION:



CEILING



WALL



PROFILE



SURFACE



MAX. LED WIDTH

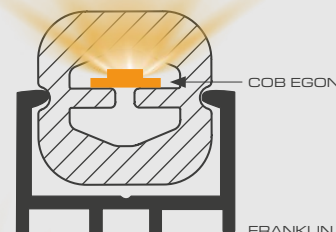

FRANKLIN B580

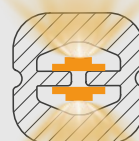

Remember to mill the surface when you receive the product and check its tolerance.





INTERIOR



FLEXIBLE



LED POWER



CEILING



WALL



MILLING

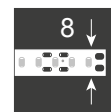

MAX. LED WIDTH



ROLL

EINSTEIN Ref. F168

Flexible profile-diffuser made from high-quality PVC. It helps eliminate the LED bright spot and protect it from dirt and knocks.

Designed to insert the LED strip inside, without the need to use any type of attachment profile or heat sink; in this way it can be bent to create all kinds of curved shapes.

TECHNICAL SPECIFICATIONS:

Material:	PVC
Lateral bending:	Total
Colour:	Opal/Semiopal/Crystalline
Fire resistant:	UL94 Self-extinguishing VO
Temperature:	-20 °C — +65 °C
Guarantee:	5 years ²
Life cycle:	25+ years
Packaging:	40-metre roll

¹ More colours on request

² When properly installed, used and maintained

COMPATIBLE LEDS



COB EGON 12V/11W



COB EGON 24V/15W



COB EGON RGB 24V/12W

WHEN USING OUR PROFILES/DIFFUSERS THERE IS A LUMEN LOSS OF 25% TO 35% DEPENDING ON THE THICKNESS OF THE DIFFUSER.

12/24V COMPATIBLE ACCESSORIES:



Power supply
17FA-140-12 20W/60W/100W
17FA-141-24 30W/75W/120W/180W



Pseudo-touch Sensor Switch
For cupboards and drawers
17AE-033
100-240V 300W



Presence sensor
for doors
17AE-026
12V/36W-24V/72W



Sensor ON-OFF
Surface dimmer
17AE-024
12V/36W-24V/72W



Sensor Switch
Bluetouch indicator light
17AE-021
12-24V



Sensor ON-OFF
Recessed dimmer
17AE-023
12V/36W-24V/72W



Motion sensor
Detection 0.5-2m
76x35x19.5
17AE-025

RGB COMPATIBLE ACCESSORIES:



RGBW sequencer
6A x channel Max. 10A
Battery not included
17AE-150



Wifi RGBW sequencer
4 channels Max.15A
17AE-151



Power supply
17FA-141-24
30W/75W/120W/180W

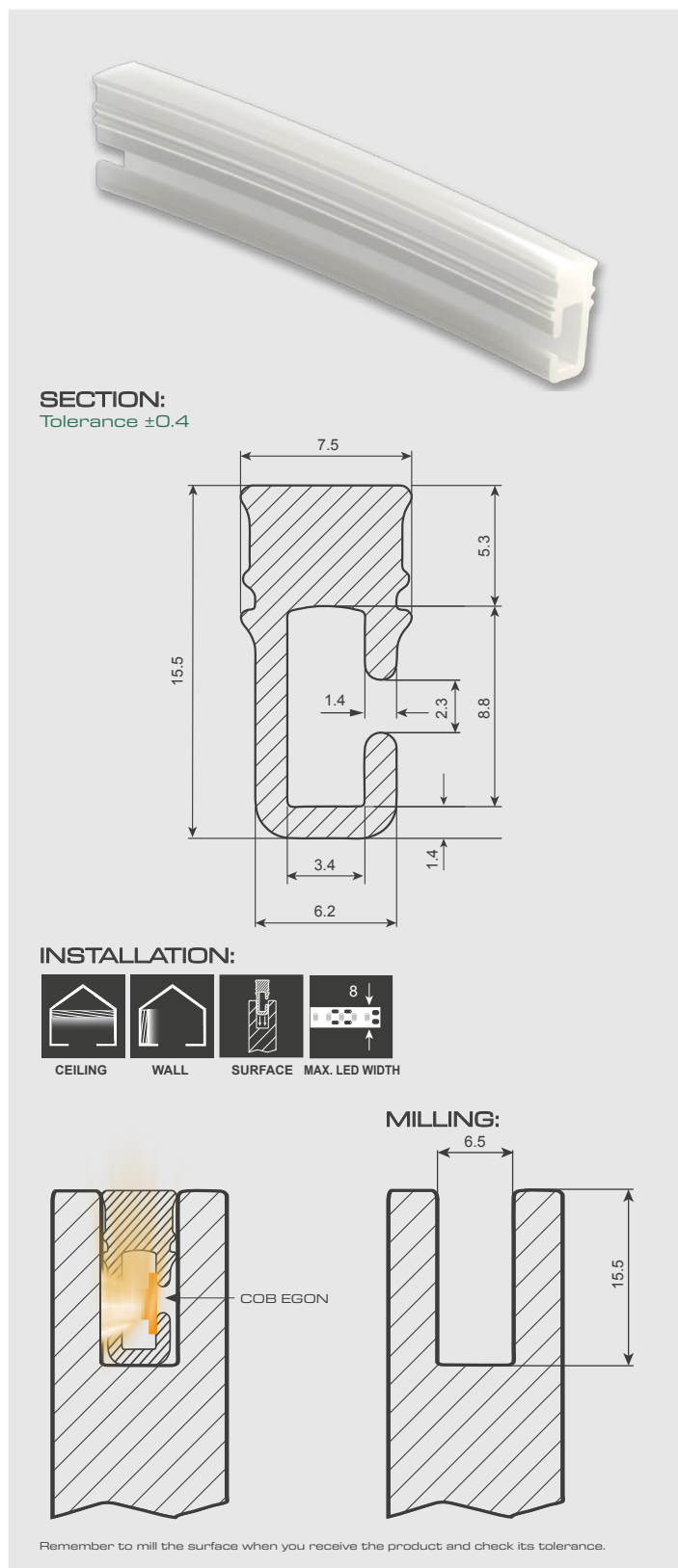



INTERIOR



FLEXIBLE



LED POWER



CEILING



WALL



MILLING

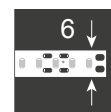

MAX. LED WIDTH



50M
ROLL

MONET Ref. C575

Flexible profile-diffuser made from high-quality PVC.
It helps eliminate the LED bright spot and protect it from dirt and knocks.

Designed to insert the LED strip inside, without using any kind of attachment profile or heat sink; in this way it can be bent to create all kinds of curved shapes.

TECHNICAL SPECIFICATIONS:

Material:	PVC
Lateral bending:	Total
Colour:	Opal/Semiopal/Crystalline
Fire resistant:	UL94 Self-extinguishing VO
Temperature:	-20 °C — +65 °C
Guarantee:	5 years ²
Life cycle:	25+ years
Packaging:	50-metre roll.

¹ More colours on request

² When properly installed, used and maintained

WHEN USING OUR PROFILES/DIFFUSERS THERE IS A LUMEN LOSS OF 25% TO 35% DEPENDING ON THE THICKNESS OF THE DIFFUSER.



SECTION: Tolerance ± 0.4

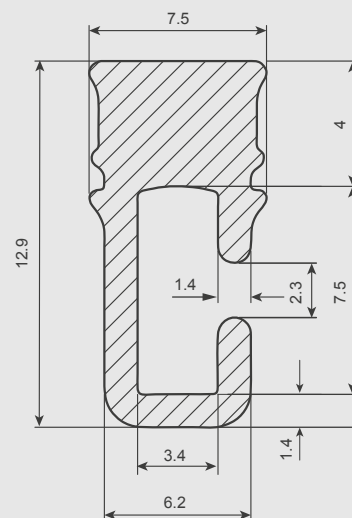

INSTALLATION:



CEILING



WALL



SURFACE



MAX. LED WIDTH

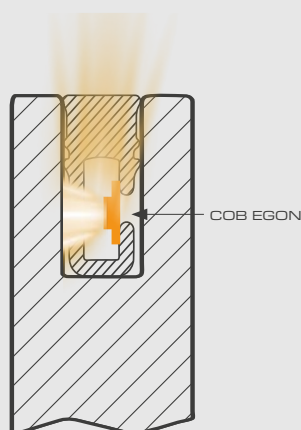

COB Egon

MILLING:

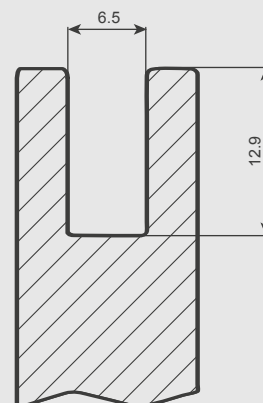

Remember to mill the surface when you receive the product and check its tolerance.





INTERIOR



EXTERIOR



FLEXIBLE



LED POWER



CEILING



WALL



MILLING

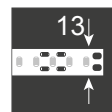

MAX. LED WIDTH



ROLL

SEURAT Ref. C908

Flexible profile-diffuser made from high-quality PVC.
It helps eliminate the LED bright spot and protect it from dirt and knocks.
It is delivered in a roll and it can be cut to the desired measurements.

Designed to be inserted directly into a moulding/channel without the need to use any type of attachment profile or heat sink.

TECHNICAL SPECIFICATIONS:

Material:	PVC
Lateral bending:	R = 80 mm
Colour:	Opal/Semiopal/Crystalline
Fire resistant:	UL94 Self-extinguishing VO
Temperature:	-20 °C — +65 °C
Guarantee:	5 years ²
Life cycle:	25+ years
Packaging:	25-metre roll

¹ More colours on request

² When properly installed, used and maintained

COMPATIBLE LEDS

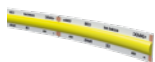

COB EGON 12V/11W

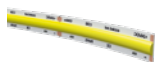

COB EGON 24V/15W

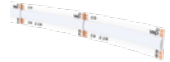

COB EGON RGB
24V/12W



NIKOLA 220V

WHEN USING OUR PROFILES/DIFFUSERS THERE IS A LUMEN LOSS OF 25% TO 35% DEPENDING ON THE THICKNESS OF THE DIFFUSER.

220V COMPATIBLE ACCESSORIES:



Pseudo-touch Sensor Switch
For cupboards and drawers
17AE-033
100-240V 300W



Motion sensor
Detection 0.5-2m
76x35x19.5
17AE-025

12/24V COMPATIBLE ACCESSORIES:



Power supply
17FA-140-12 20W/60W/100W
17FA-141-24 30W/75W/120W/180W



Pseudo-touch Sensor Switch
For cupboards and drawers
17AE-033
100-240V 300W



Presence sensor
for doors
17AE-026
12V/36W-24V/72W



Sensor ON-OFF
Surface dimmer
17AE-024
12V/36W-24V/72W



Sensor Switch
Bluetouch indicator light
17AE-021
12-24V



Sensor ON-OFF
Recessed dimmer
17AE-023
12V/36W-24V/72W



Motion sensor
Detection 0.5-2m
76x35x19.5
17AE-025



SECTION: Tolerance ±0.4

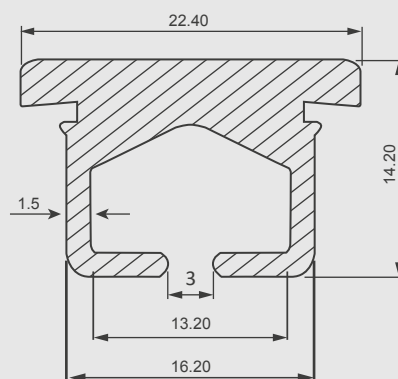

INSTALLATION:



CEILING



WALL



SURFACE



MAX. LED WIDTH

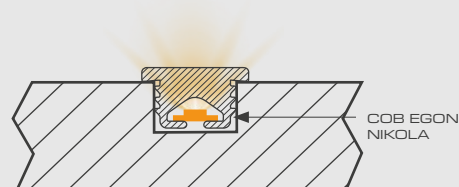

MILLING:

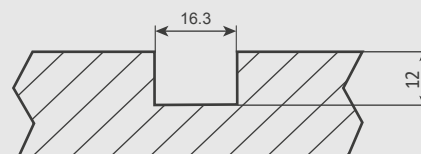

Remember to mill the surface when you receive the product and check its tolerance.





INTERIOR



EXTERIOR



LED POWER



LED 12V/24V



LED 220V



CORNERHOLD



CEILING



WALL

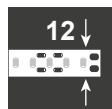

MAX. LED WIDTH



SCREW-IN



ADHESIVE TAPE

NEWTON
Ref. B581

Attachment profile and heat sink, made of high-quality aluminium, designed to house the LED strip inside and to hold our diffuser.

Designed for installation at 90° angles.

We recommend its use with our **ABS DEGAS C570** diffuser.

We recommend the use of **COB EGON** and **NIKOLA** LED strips to achieve a more uniform and diffused illumination.

TECHNICAL SPECIFICATIONS:

Profile material:	Aluminium
Profile finish:	● Anodised
Max. LED width:	12mm
Standard LED power:	30 W/m
Length of profile:	2.60m
Guarantee:	4 years*

* Properly installed, used and maintained

COMPATIBLE LEDS:

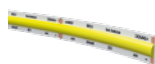

COB EGON 12V/11W



COB EGON 24V/15W



COB EGON RGB
24V/12W



NIKOLA 220V

COMPATIBLE DIFFUSERS:



Rigid diffuser
DEGAS C570

COMPATIBLE COVERS:



Cover
NEWTON C213

220V COMPATIBLE ACCESSORIES:



Pseudo-touch Sensor Switch
For cupboards and drawers
17AE-033
100-240V 300W



Motion sensor
Detection 0.5-2m
76x35x19.5
17AE-025

12/24V COMPATIBLE ACCESSORIES:



Power supply
17FA-140-12 20W/60W/100W
17FA-141-24 30W/75W/120W/180W



Pseudo-touch Sensor Switch
For cupboards and drawers
17AE-033
100-240V 300W



Presence sensor
for doors
17AE-026
12V/36W-24V/72W



Sensor ON-OFF
Surface dimmer
17AE-024
12V/36W-24V/72W



Sensor Switch
Bluetouch indicator light
17AE-021
12-24V



Sensor ON-OFF
Recessed dimmer
17AE-023
12V/36W-24V/72W



Motion sensor
Detection 0.5-2m
76x35x19.5
17AE-025

RGB COMPATIBLE ACCESSORIES:



RGBW sequencer
6A x channel Max. 10A
Battery not included
17AE-150



Wifi RGBW sequencer
4 channels Max.15A
17AE-151



Power supply
17FA-141-24
30W/75W/120W/180W

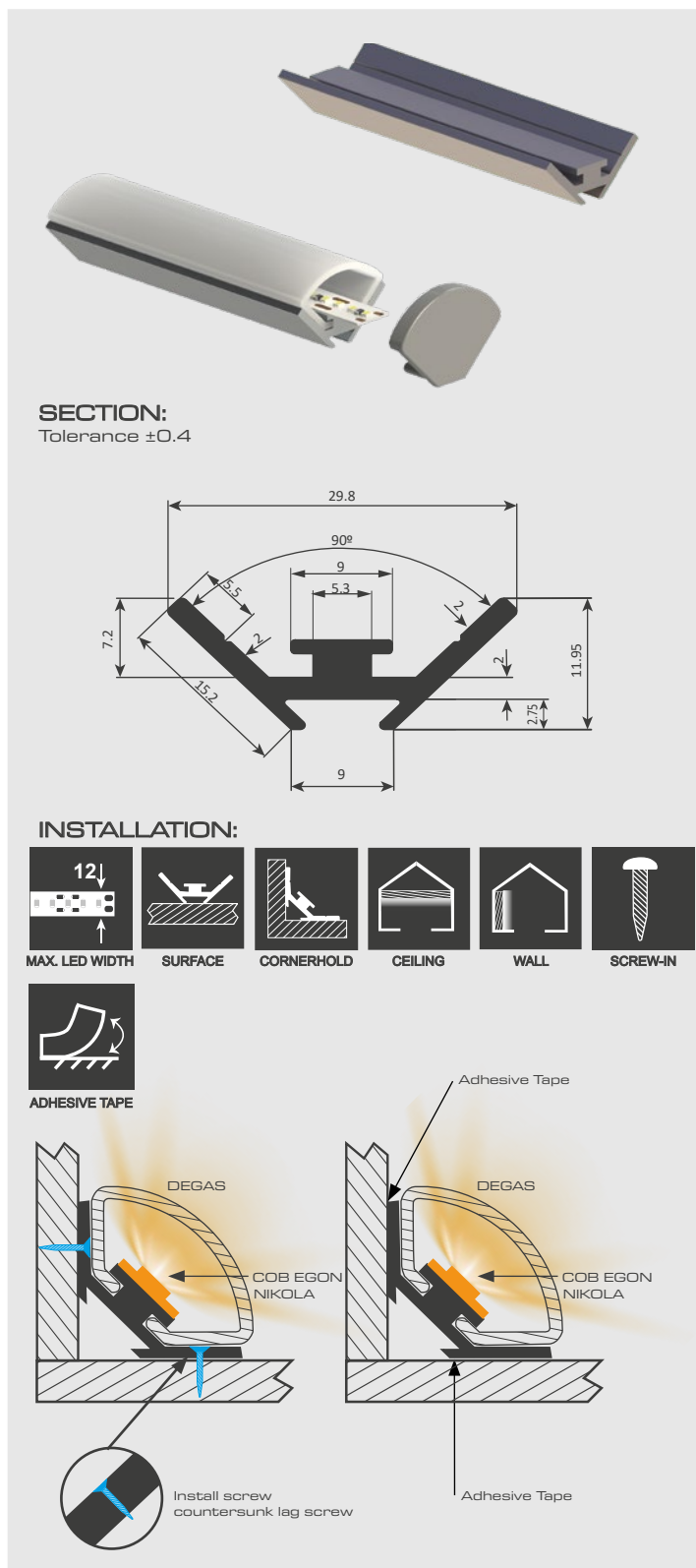



INTERIOR



EXTERIOR

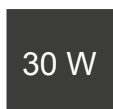

LED POWER



LED 12V/24V



LED 220V



SURFACE



CEILING



WALL

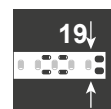

MAX. LED WIDTH



SCREW-IN

FRANKLIN
Ref. B580

Attachment profile and heat sink, made of high-quality aluminium, designed to hold the LED strip inside, dissipate the heat produced and hold our diffusers. In this case place the LED strip inside, then install our diffuser or our diffuser profile and finally install the assembly on the surface or in a recessed position.

We recommend using it with our diffuser profile **VAN GOGH B287** and **FLEMING E117** or with our diffuser **VELÁZQUEZ B136**.

We recommend using **COB EGON** and **NIKOLA** LED strips to achieve a more uniform and diffused illumination.

TECHNICAL SPECIFICATIONS:

Profile material:	Aluminium
Profile finish:	Anodised
Max. LED width:	19mm
Standard LED power:	30 W/m
Length of profile:	2.60m
Guarantee:	4 years*

* Properly installed, used and maintained

COMPATIBLE LEDs:

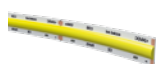

COB EGON 12V/11W



COB EGON 24V/15W



COB EGON RGB
24V/12W



NIKOLA 220V

COMPATIBLE DIFFUSERS:



Profile-diffuser
VAN GOGH B287



Profile-diffuser
FLEMING E117



Diffuser
VELÁZQUEZ B136

COMPATIBLE COVERS:



FRANKLIN B585 cover

220V COMPATIBLE ACCESSORIES:



Pseudo-touch Sensor Switch
For cupboards and drawers
17AE-033
100-240V 300W



Motion sensor
Detection 0.5-2m
76x35x19.5
17AE-025

12/24V COMPATIBLE ACCESSORIES:



Power supply
17FA-140-12 20W/60W/100W
17FA-141-24 30W/75W/120W/180W



Pseudo-touch Sensor Switch
For cupboards and drawers
17AE-033
100-240V 300W



Presence sensor
for doors
17AE-026
12V/36W-24V/72W



Sensor ON-OFF
Surface dimmer
17AE-024
12V/36W-24V/72W



Sensor Switch
Bluetouch indicator light
17AE-021
12-24V



Sensor ON-OFF
Recessed dimmer
17AE-023
12V/36W-24V/72W



Motion sensor
Detection 0.5-2m
76x35x19.5
17AE-025

RGB COMPATIBLE ACCESSORIES:



RGBW sequencer
8A x channel Max. 10A
Battery not included
17AE-150



Wifi RGBW sequencer
4 channels Max.15A
17AE-151



Power supply
17FA-141-24
30W/75W/120W/180W

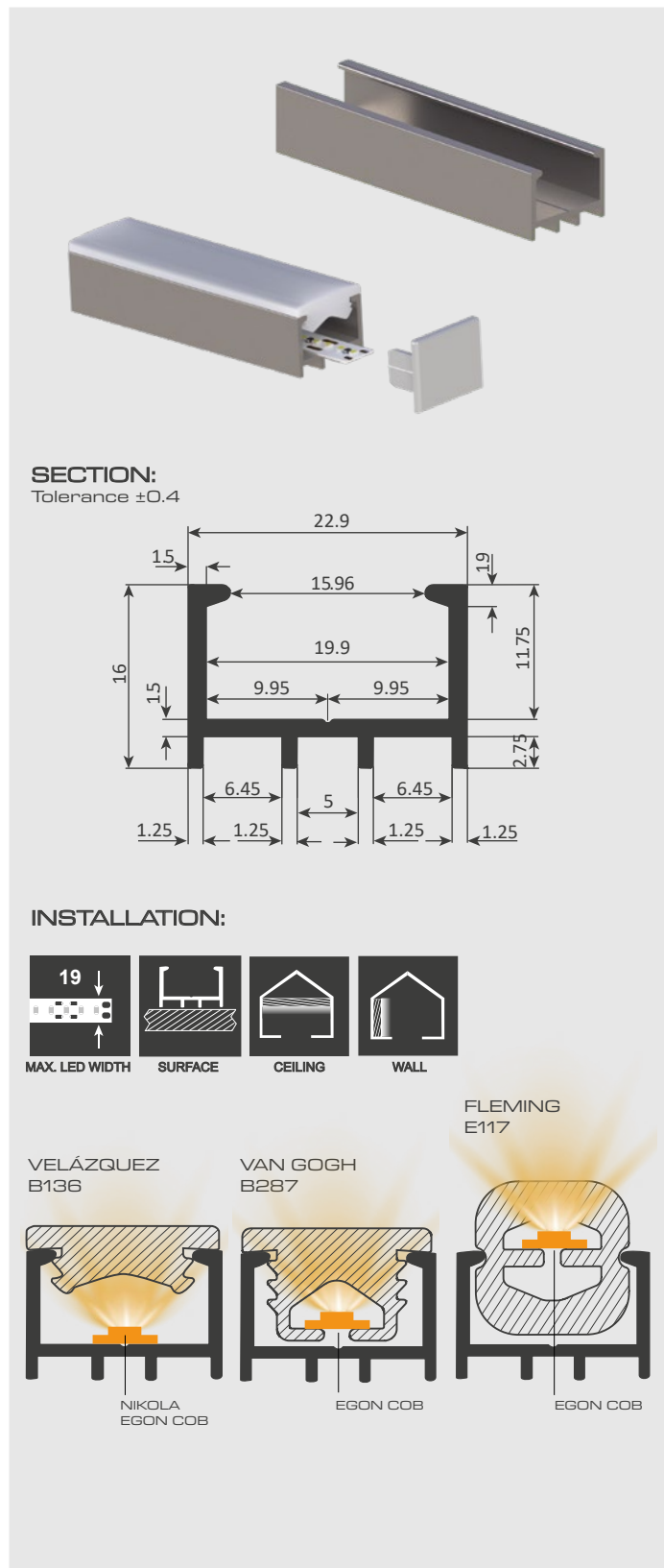



INTERIOR



EXTERIOR

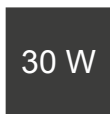

LED POWER



LED 12V/24V



MILLING



CEILING



WALL

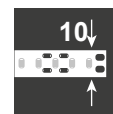

MAX. LED WIDTH

RUBIK
Ref. B579

High-quality aluminium attachment and heat dissipation profile, designed to house the LED strip inside, dissipate the heat produced and hold our diffusers.

In this case, place the LED strip inside, put our diffuser in place and then embed it.

We recommend using it with our diffuser **TIZIANO B258**.

We recommend using **COB EGON** LED strips to achieve a more uniform and diffused illumination.

TECHNICAL SPECIFICATIONS:

Profile material:	Aluminium
Profile finish:	● Anodised
Max. LED width:	15mm
Standard LED power:	30 W/m
Length of profile:	2.60m
Guarantee:	4 years*

* Properly installed, used and maintained

COMPATIBLE LEDs:

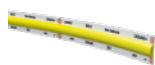

COB EGON 12V/11W

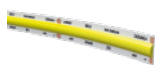

COB EGON 24V/15W



COB EGON RGB 24V/12W

COMPATIBLE DIFFUSERS:



Diffuser
TIZIANO B258

COMPATIBLE COVERS:



Opal cover
RUBIK B584



Aluminium cover
RUBIK B584

12/24V COMPATIBLE ACCESSORIES:



Power supply
17FA-140-12 20W/60W/100W
17FA-141-24 30W/75W/120W/180W



Pseudo-touch Sensor Switch
For cupboards and drawers
17AE-033 100-240V 300W



Presence sensor
for doors
17AE-026 12V/36W-24V/72W



Sensor ON-OFF
Surface dimmer
17AE-024 12V/36W-24V/72W



Sensor Switch
Bluetouch indicator light
17AE-021 12-24V



Sensor ON-OFF
Recessed dimmer
17AE-023 12V/36W-24V/72W



Motion sensor
Detection 0.5-2m
76x35x19.5
17AE-025

RGB COMPATIBLE ACCESSORIES:



RGBW sequencer
6A x channel Max. 10A
Battery not included
17AE-150



Wifi RGBW sequencer
4 channels Max. 15A
17AE-151



Power supply
17FA-141-24 30W/75W/120W/180W

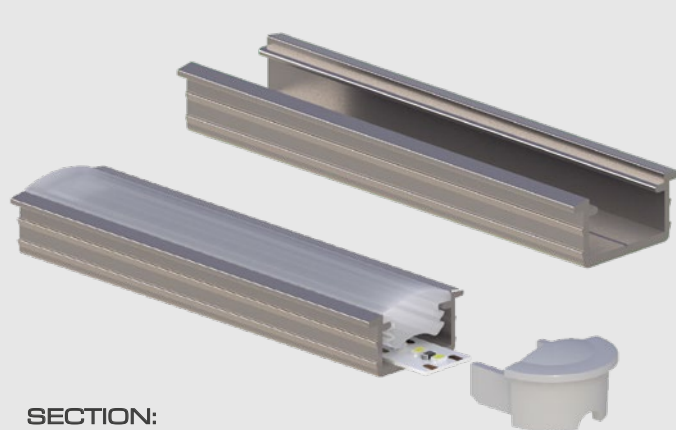

SECTION:
Tolerance ± 0.4

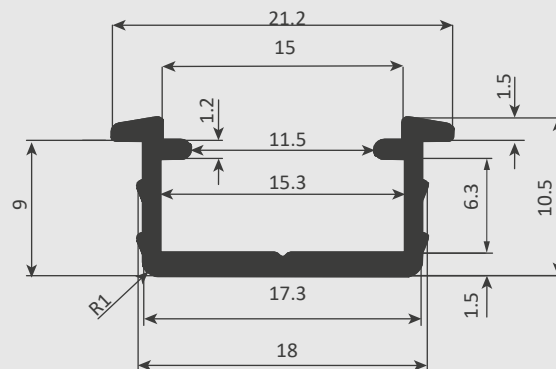

INSTALLATION:

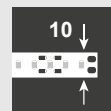

MAX. LED WIDTH

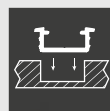

MILLING



CEILING



WALL

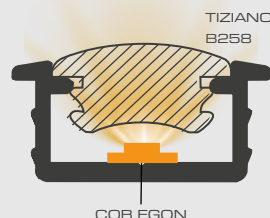

COB EGON

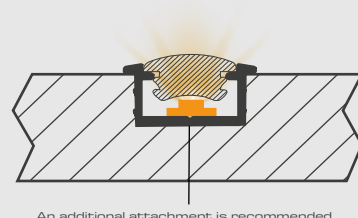

An additional attachment is recommended

MILLING:

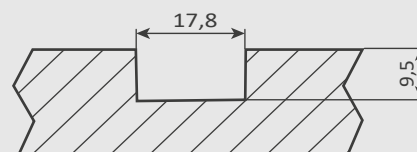

Remember to mill the surface when you receive the product and check its tolerance.





INTERIOR



EXTERIOR

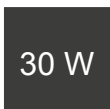

LED POWER



IP65



LED 24V

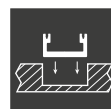

MILLING



CEILING



WALL

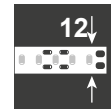

MAX. LED WIDTH

SARAH

BLACK ANODISED 17PS-002NE

High-quality aluminium attachment and heat dissipation profile, designed to house the LED strip inside, dissipate the heat produced and hold our diffusers.

In this case, place the LED strip inside, put our diffuser in place and then embed it.

We recommend using it with our diffuser **DARKNESS**

We recommend using **COB EGON** LED strips to achieve a more uniform and diffused illumination.

TECHNICAL SPECIFICATIONS:

Profile material:	Aluminium
Profile finish:	● Black
Max. LED width	12mm
Standard LED power:	15 W/m
Length of profile:	2.60m
Guarantee:	4 years*

* Properly installed, used and maintained

COMPATIBLE LEDs:



COB EGON 12V/11W



COB EGON 24V/15W



COB EGON RGB 24V/12W

COMPATIBLE DIFFUSERS:

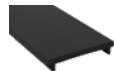

Darkness
Black 17PD-003NE

COMPATIBLE COVERS:



Recessed cover
Black 17TP-009NE

12/24V COMPATIBLE ACCESSORIES:



Power supply
17FA-140-12 20W/60W/100W
17FA-141-24 30W/75W/120W/180W



Pseudo-touch Sensor Switch
For cupboards and drawers
17AE-033
100-240V 300W



Presence sensor
for doors
17AE-026
12V/36W-24V/72W



Sensor ON-OFF
Surface dimmer
17AE-024
12V/36W-24V/72W



Sensor Switch
Bluetouch indicator light
17AE-021
12-24V



Sensor ON-OFF
Recessed dimmer
17AE-023
12V/36W-24V/72W



Motion sensor
Detection 0.5-2m
17AE-025

RGB COMPATIBLE ACCESSORIES:



RGBW sequencer
6A x channel Max. 10A
Battery not included
17AE-150



Wifi RGBW sequencer
4 channels Max.15A
17AE-151



Power supply
17FA-141-24
30W/75W/120W/180W

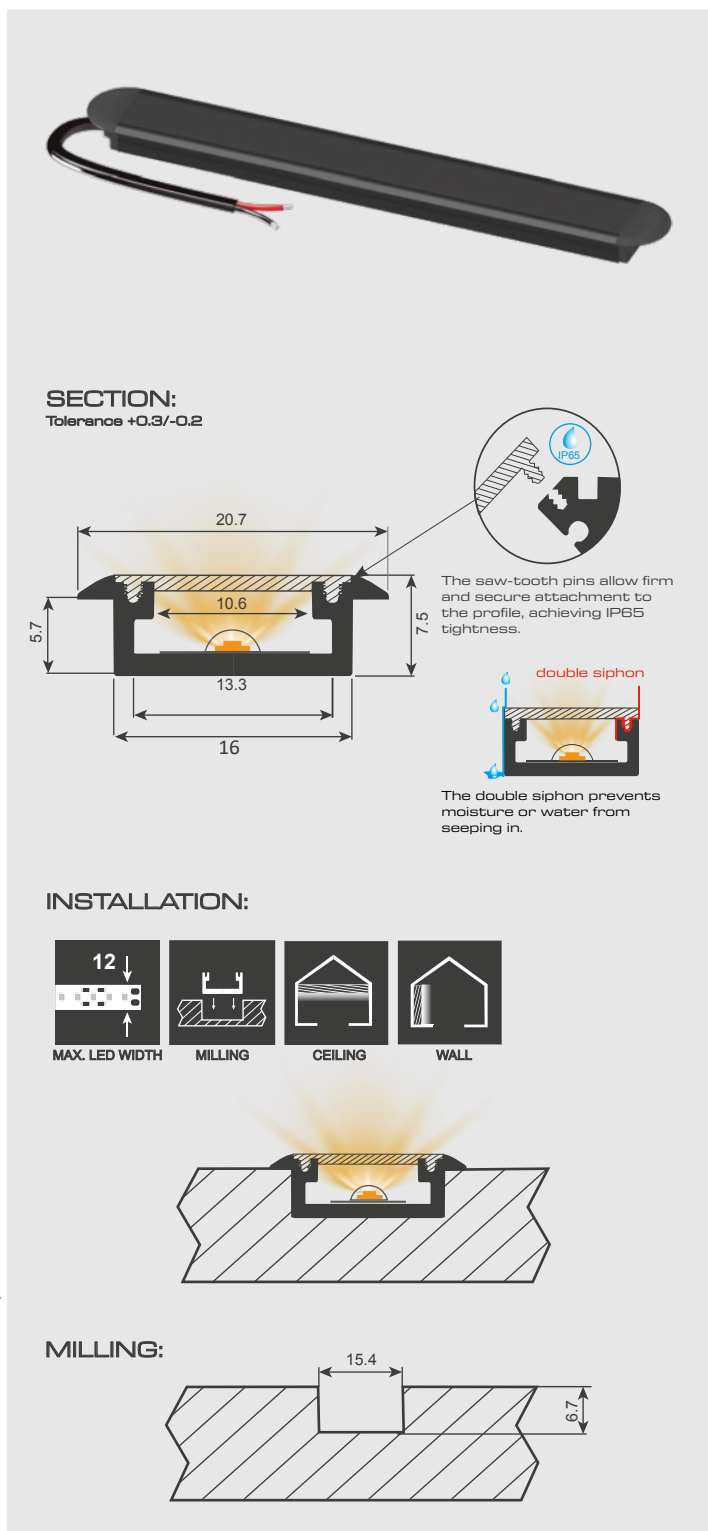

SECTION:

Tolerance +0.3/-0.2

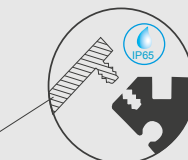
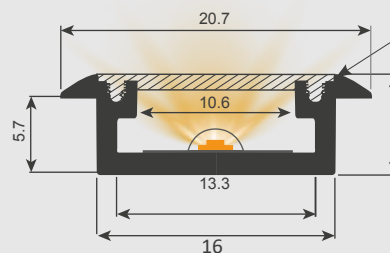

The saw-tooth pins allow firm and secure attachment to the profile, achieving IP65 tightness.

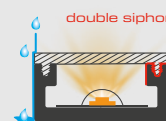

The double siphon prevents moisture or water from seeping in.

INSTALLATION:

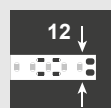

MAX. LED WIDTH

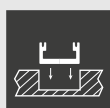

MILLING



CEILING



WALL

MILLING:

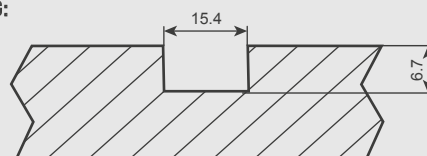



INTERIOR



EXTERIOR

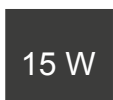

LED POWER



WORK TIME



SURFACE

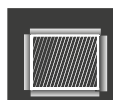

BEHIND THE MIRROR



BEND

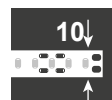

MAX. LED WIDTH



SCREW-IN



ADHESIVE TAPE

CEZANNE

Ref. B459

Attachment profile made from high-quality PVC designed to house the LED strip inside and attach to the diffuser being used as a cover. In this case assemble the profiles creating a rectangular shape, then place the LED strip inside the channel and finally cover the channel with our diffusers, allowing for the possibility of applying the assembly behind a mirror, in sandwich format, on bed headboards, or ceiling fixtures...

We recommend using it with our diffusers

HARRISON C116 and WARHOL B304.

We recommend using **COB EGON** LED strips to achieve a more uniform and diffused illumination.

TECHNICAL SPECIFICATIONS:

Profile material:	PVC
Profile finish:	● Grey
Max. LED width	10mm
Standard LED power:	15 W/m
Length of profile:	2.60m
Guarantee:	4 years*

* Properly installed, used and maintained

COMPATIBLE LEDS:



COB EGON 12V/11W



COB EGON 24V/15W



COB EGON RGB 24V/12W

COMPATIBLE DIFFUSERS:



Diffuser
WARHOL B304



Diffuser
HARRISON C116

COMPATIBLE COVERS:



Silver cover (L/R)
CEZANNE/VOLTA 7965



Transp L/R Cover
CEZANNE/VOLTA 7965

COMPATIBLE ACCESSORIES:



Bend
CEZANNE/VOLTA B460



Bend
CEZANNE/VOLTA B461

12/24V COMPATIBLE ACCESSORIES:



Power supply
17FA-140-12 20W/60W/100W
17FA-141-24 30W/75W/120W/180W



Pseudo-touch Sensor Switch
For cupboards and drawers
17AE-033
100-240V 300W



Presence sensor
for doors
17AE-026
12V/36W-24V/72W



Sensor ON-OFF
Surface dimmer
17AE-024
12V/36W-24V/72W



Sensor Switch
Bluetouch indicator light
17AE-021
12-24V



Sensor ON-OFF
Recessed dimmer
17AE-023
12V/36W-24V/72W



Motion sensor
Detection 0.5-2m
76x55x19.5
17AE-025

RGB COMPATIBLE ACCESSORIES:



RGBW sequencer
6A x channel Max. 10A
Battery not included
17AE-150



Wifi RGBW sequencer
4 channels Max. 15A
17AE-151



Power supply
17FA-141-24
30W/75W/120W/180W

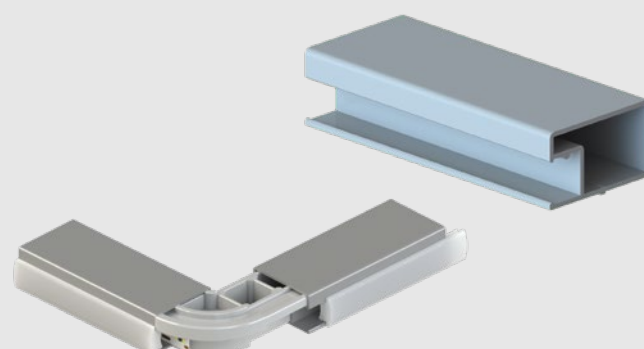

SECTION:
Tolerance ± 0.4

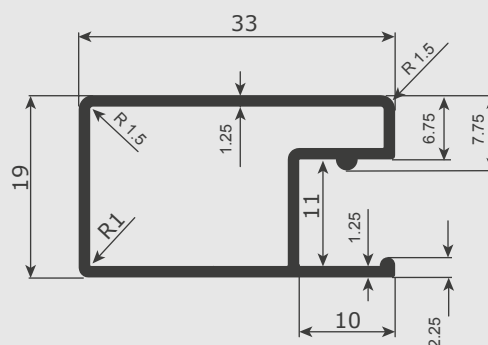

INSTALLATION:

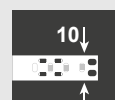

MAX. LED WIDTH



SURFACE



BEND



BEHIND THE
MIRROR



SCREW-IN



ADHESIVE TAPE

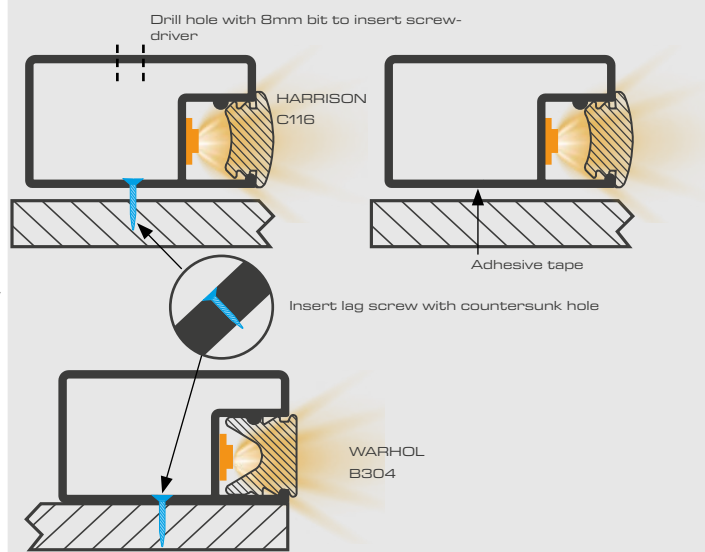



INTERIOR



EXTERIOR

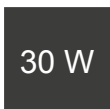

LED POWER



LED 12V/24V



LED 220V



SURFACE

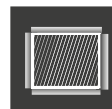

BEHIND THE MIRROR



BEND

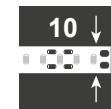

MAX. LED WIDTH



SCREW-IN



ADHESIVE TAPE

VOLTA
Ref. B781

High-quality aluminium attachment and heat dissipation profile, designed to house the LED strip inside, dissipate the heat produced and hold our diffusers.

In this case assemble the profiles creating a rectangular shape, then place the LED strip inside the channel and finally cover the channel with our diffuser.

We recommend using it with our diffusers **HARRISON C116** y **WHARHOL B304**

We recommend using **COB EGON** LED strips to achieve a more uniform and diffused illumination.

TECHNICAL SPECIFICATIONS:

Profile material:	Aluminium
Profile finish:	Anodised
Max. LED width	10mm
Standard LED power:	30 W/m
Length of profile:	2.60m
Guarantee:	4 years*

* Properly installed, used and maintained

COMPATIBLE LEDS:

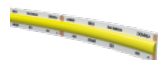

COB EGON 12V/11W



COB EGON 24V/15W



COB EGON RGB
24V/12W



NIKOLA 220V
* depending on
installation

COMPATIBLE DIFFUSERS:



Diffuser
WHARHOL B304



Diffuser
HARRISON C116

COMPATIBLE COVERS:



Silver L/R Cover
CEZANNE/VOLTA 7965



Transp L/R Cover
CEZANNE/VOLTA 7965

COMPATIBLE ACCESSORIES:



CEZANNE/VOLTA B460 curve



CEZANNE/VOLTA B461 curve

220V COMPATIBLE ACCESSORIES:



Pseudo-touch Sensor Switch
For cupboards and drawers
17AE-033 100-240V 300W



Motion sensor
Detection 0.5-2m 76x35x19.5
17AE-025

12/24V COMPATIBLE ACCESSORIES:



Power supply
17FA-140-12 20W/60W/100W
17FA-141-24 30W/75W/120W/180W



Pseudo-touch Sensor Switch
For cupboards and drawers
17AE-033 100-240V 300W



Presence sensor
for doors
17AE-026 12V/36W-24V/72W



Sensor ON-OFF
Surface dimmer
17AE-024 12V/36W-24V/72W



Sensor Switch
Bluetouch indicator light
17AE-021 12-24V



Sensor ON-OFF
Recessed dimmer
17AE-023 12V/36W-24V/72W



Motion sensor
Detection 0.5-2m
76x35x19.5
17AE-025

RGB COMPATIBLE ACCESSORIES:



RGBW sequencer
6A x channel Max. 10A
Battery not included 17AE-150



Wifi RGBW sequencer
4 channels Max.15A
17AE-151



Power supply
17FA-141-24 30W/75W/120W/180W

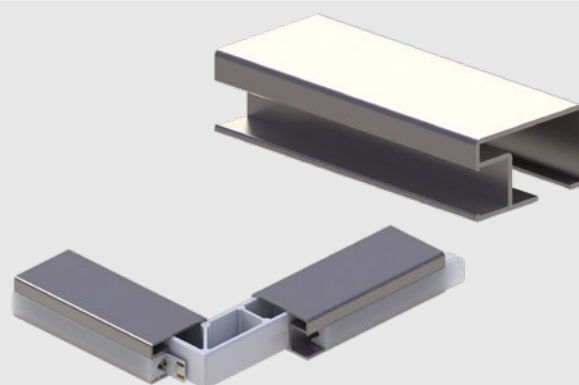

SECTION:
Tolerance ± 0.4

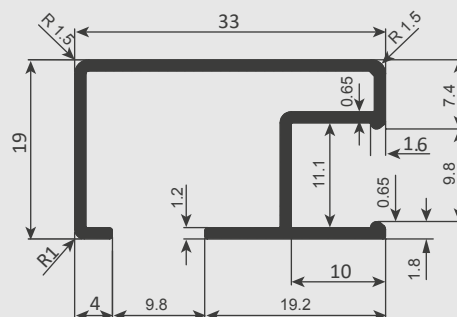

INSTALLATION:

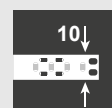

MAX. LED WIDTH



SURFACE



BEND



BEHIND THE
MIRROR



SCREW-IN



ADHESIVE TAPE

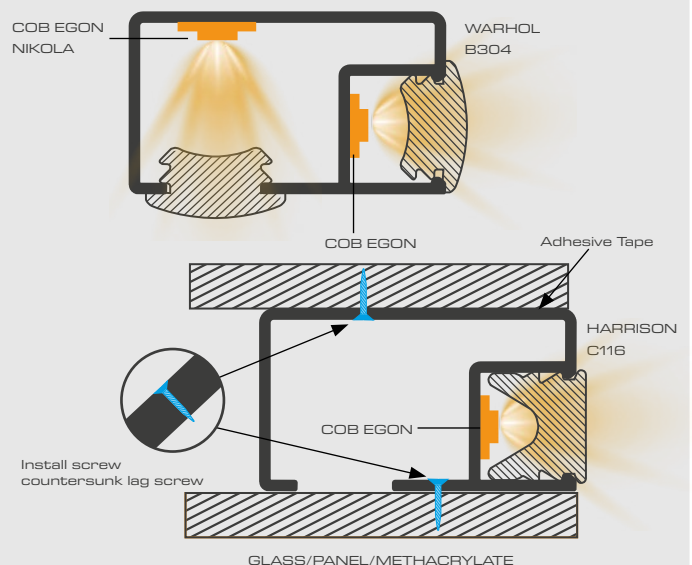



TECHNICAL DATA SHEET

KANDINSKY



INTERIOR



EXTERIOR



LED POWER



LED 12V/24V



SURFACE



CEILING



WALL



VERSATILE

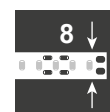

MAX. LED WIDTH



SCREW-IN



ADHESIVE TAPE

KANDINSKY
Ref. B303

Attachment profile made from high-quality PVC designed to house the LED strip inside and attach to the diffuser being used as a cover.

In this case place the LED strip inside the box, then attach our diffuser and finally insert the set superficially at the end, allowing for the possibility of installing it above it (the light will be directed downwards) or installing it below it (the light will be directed upwards).

We recommend using it with our diffuser **HARRISON C116**.

We recommend using **COB EGON** LED strips to achieve a more uniform and diffused illumination.

TECHNICAL SPECIFICATIONS:

Profile material:	PVC
Profile finish:	● Silver ¹
Max. LED width:	10mm
Standard LED power:	15 W/m
Length of profile:	2.60m
Guarantee:	4 years ²

¹ More colours on request

² When properly installed, used and maintained

COMPATIBLE LEDS:



COB EGON 12V/11W

COMPATIBLE DIFFUSERS:



Diffuser:
HARRISON C116

COMPATIBLE COVERS:



Cover:
KANDINSKY/REMBRAND B583

12/24V COMPATIBLE ACCESSORIES:



Power supply
17FA-140-12 20W/60W/100W
17FA-141-24 30W/75W/120W/180W



Pseudo-touch Sensor Switch
For cupboards and drawers
17AE-033
100-240V 300W



Presence sensor
for doors
17AE-026
12V/36W-24V/72W



Sensor ON-OFF
Surface dimmer
17AE-024
12V/36W-24V/72W



Sensor Switch
Bluetouch indicator light
17AE-021
12-24V



Sensor ON-OFF
Recessed dimmer
17AE-023
12V/36W-24V/72W



Motion sensor
Detection 0.5-2m
76x35x19.5
17AE-025

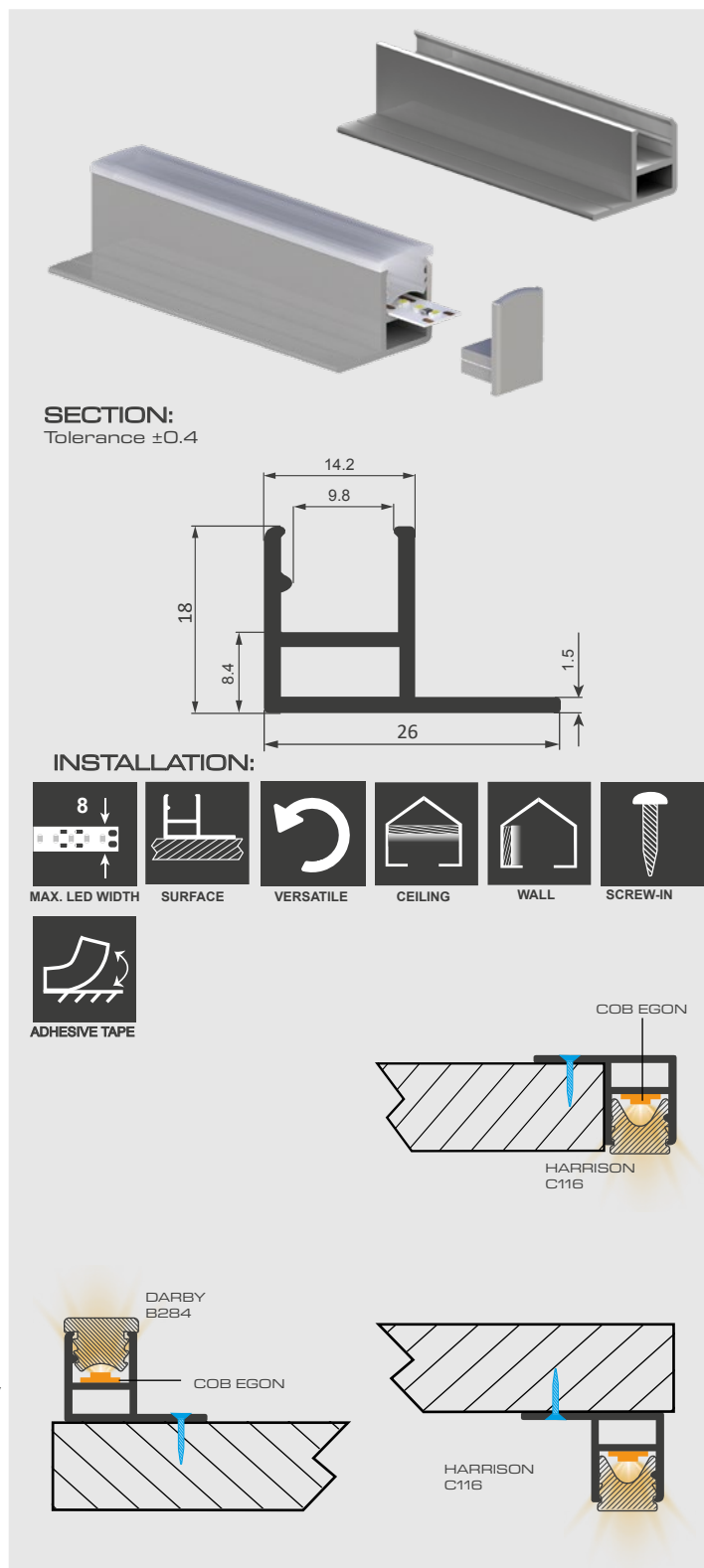



INTERIOR



EXTERIOR



LED POWER



LED 12V/24V



SURFACE



CEILING



WALL



VERSATILE

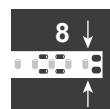

MAX. LED WIDTH



SCREW-IN



ADHESIVE TAPE

REMBRANDT
Ref. B582

Attachment and dissipation profile made from high-quality aluminium designed to house the LED strip inside, dissipate the heat generated and hold our diffusers.

In this case we place the LED strip inside the box, then we place our diffuser and finally we insert the set superficially at the end, with the possibility of installing it above it (the light will be directed downwards) or installing it below it (the light will be directed upwards).

We recommend using it with our diffuser **HARRISON C116**.

We recommend using **COB EGON** LED strips to achieve a more uniform and diffused illumination.

TECHNICAL SPECIFICATIONS:

Profile material:	Aluminium
Profile finish:	● Anodised
Max. LED width:	8mm
Standard LED power:	30 W/m
Length of profile:	2.60m
Guarantee:	4 years*

* Properly installed, used and maintained

COMPATIBLE LEDS:

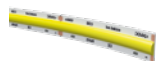

COB EGON 12V/11W

COMPATIBLE DIFFUSERS:



Diffuser
HARRISON C116

COMPATIBLE COVERS:



Cover
KANDINSKY/REMBRANDT B583

12/24V COMPATIBLE ACCESSORIES:



Power supply
17FA-140-12 20W/60W/100W
17FA-141-24 30W/75W/120W/180W



Pseudo-touch Sensor Switch
For cupboards and drawers
17AE-033 100-240V 300W



Presence sensor for doors
17AE-026 12V/36W-24V/72W



Sensor ON-OFF
Surface dimmer
17AE-024 12V/36W-24V/72W



Sensor Switch
Bluetouch indicator light
17AE-021 12-24V



Sensor ON-OFF
Recessed dimmer
17AE-023 12V/36W-24V/72W



Motion sensor
Detection 0.5-2m
76x35x19.5
17AE-025



SECTION:
Tolerance ± 0.4

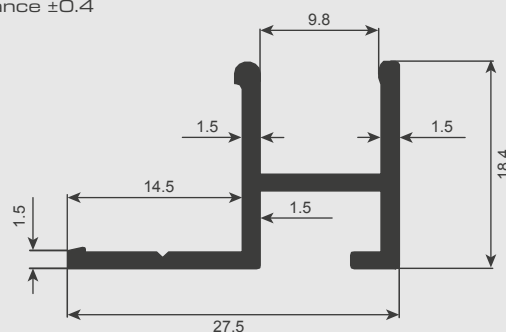

INSTALLATION:

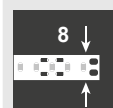

MAX. LED WIDTH



SURFACE



VERSATILE



CEILING



WALL



SCREW-IN



ADHESIVE TAPE

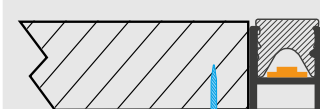

HARRISON C116

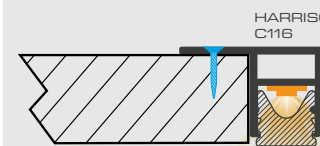

HARRISON C116

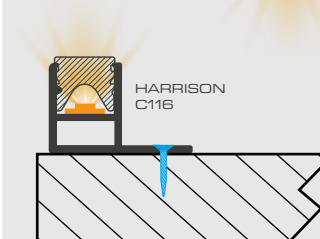

HARRISON C116



COB EGON
HARRISON C116



Install screw
countersunk lag screw

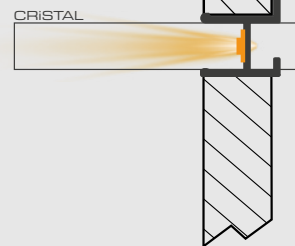

CRISTAL





INTERIOR



EXTERIOR



LED POWER



LED 12V/24V



SURFACE



CEILING



WALL

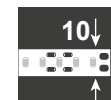

MAX. LED WIDTH



SCREW-IN



ADHESIVE TAPE

VERMEER
Ref. B298

Attachment and dissipation profile made from high-quality aluminium designed to house the LED strip inside, dissipate the heat generated and hold our diffusers.

In this case place the LED strip inside, then attach our diffuser and finally install the set on the surface.

We recommend using it with our diffuser **FULTON C015**
We recommend using **COB EGON** LED strips to achieve a more uniform and diffused illumination.

TECHNICAL SPECIFICATIONS:

Profile material:	Aluminium
Profile finish:	● Aluminium
Max. LED width	10mm
Standard LED power:	40 W/m
Length of profile:	2.60m
Guarantee:	4 years*

* Properly installed, used and maintained

COMPATIBLE LEDS:



COB EGON 12V/11W



COB EGON 24V/15W



COB EGON RGB 24V/12W

COMPATIBLE DIFFUSERS:



Diffuser
FULTON C015

12/24V COMPATIBLE ACCESSORIES:



Power supply
17FA-140-12 20W/60W/100W
17FA-141-24 30W/75W/120W/180W



Pseudo-touch Sensor Switch
For cupboards and drawers
17AE-033
100-240V 300W



Presence sensor
for doors
17AE-026
12V/36W-24V/72W



Sensor ON-OFF
Surface dimmer
17AE-024
12V/36W-24V/72W



Sensor Switch
Bluetouch indicator light
17AE-021
12-24V



Sensor ON-OFF
Recessed dimmer
17AE-023
12V/36W-24V/72W



Motion sensor
Detection 0.5-2m
76x35x19.5
17AE-025

RGB COMPATIBLE ACCESSORIES:



RGBW sequencer
6A x channel Max. 10A
Battery not included
17AE-150



Wifi RGBW sequencer
4 channels Max.15A
17AE-151



Power supply
17FA-141-24
30W/75W/120W/180W

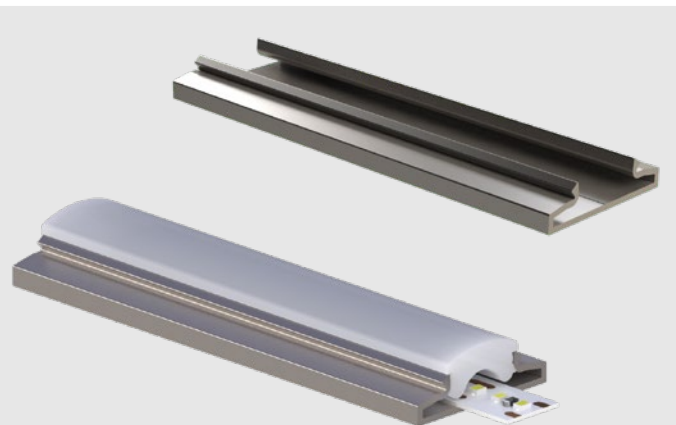

SECTION:
Tolerance ± 0.4

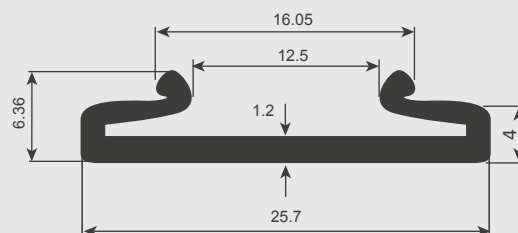

INSTALLATION:

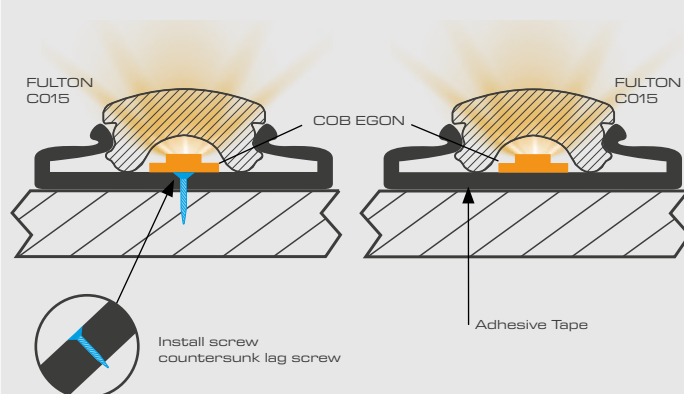



INTERIOR



EXTERIOR



LED POWER



LED 12V/24V



SURFACE



CEILING



WALL

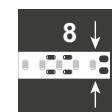

MAX. LED WIDTH



SCREW-IN



ADHESIVE TAPE

FRIDA

Ref. B659

Attachment profile made from high-quality PVC designed to house the LED strip inside and attach to the diffuser being used as a cover.

In this case place the LED strip inside the box, then attach our diffuser and finally insert it on the surface.

We recommend using it with our diffuser **WARHOL B304**.

We recommend using **COB EGON** LED strips to achieve a more uniform and diffused illumination.

TECHNICAL SPECIFICATIONS:

Profile material:	PVC
Profile finish:	● Grey ¹
Max. LED width	8mm
Standard LED power:	15 W/m
Length of profile:	2.60m
Guarantee:	4 years ²

¹ More colours on request

² When properly installed, used and maintained

COMPATIBLE LEDS:



COB EGON 12V/11W

COMPATIBLE DIFFUSERS:



Diffuser
WARHOL B304

12/24V COMPATIBLE ACCESSORIES:



Power supply
17FA-140-12 20W/60W/100W
17FA-141-24 30W/75W/120W/180W



Pseudo-touch Sensor Switch
For cupboards and drawers
17AE-033
100-240V 300W



Presence sensor
for doors
17AE-026
12V/36W-24V/72W



Sensor ON-OFF
Surface dimmer
17AE-024
12V/36W-24V/72W



Sensor Switch
Bluetouch indicator light
17AE-021
12-24V



Sensor ON-OFF
Recessed dimmer
17AE-023
12V/36W-24V/72W



Motion sensor
Detection 0.5-2m
76x35x19.5
17AE-025

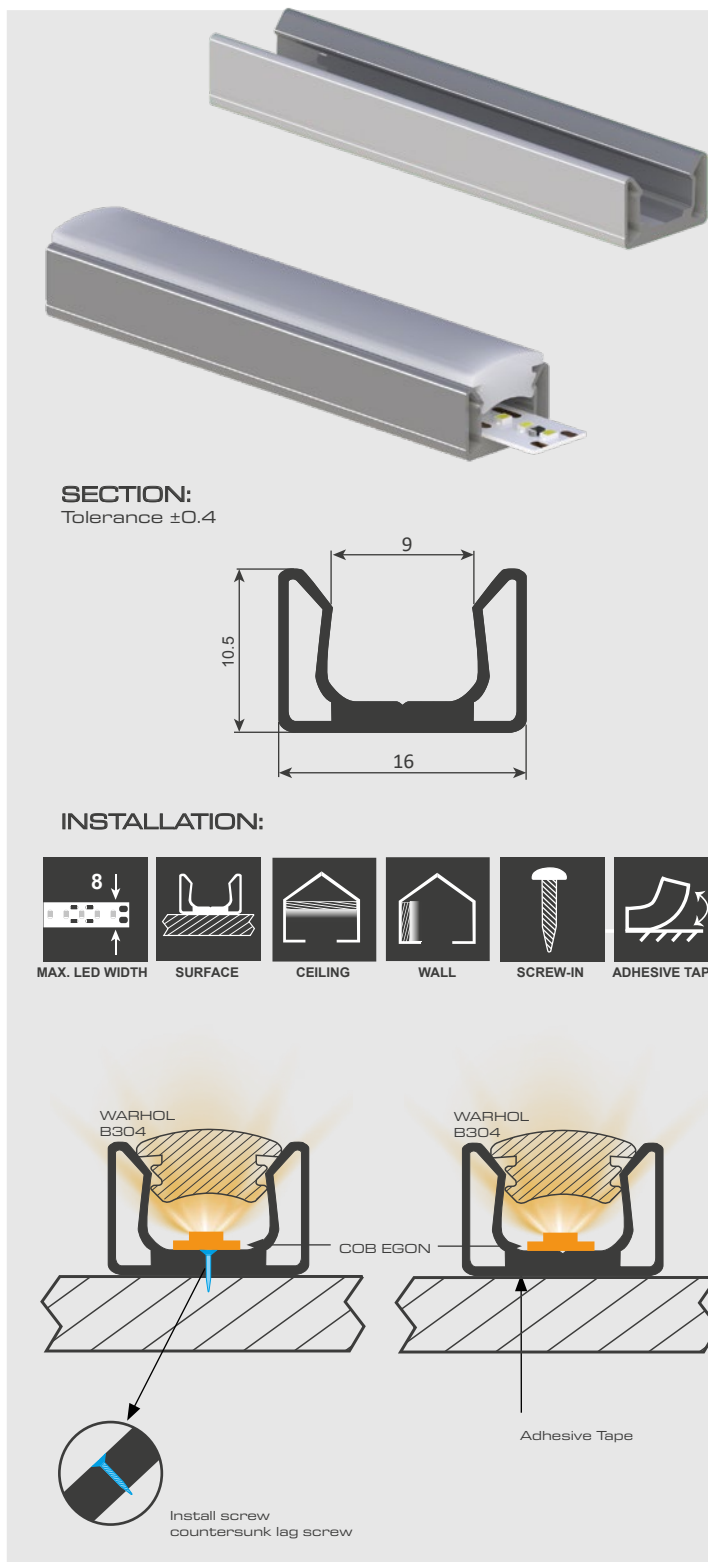



INTERIOR



EXTERIOR



LED POWER



LED 12V/24V



MILLING



CEILING



WALL

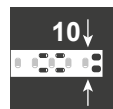

MAX. LED WIDTH

CULEN
Ref. B885

Attachment profile made from high-quality PVC designed to house the LED strip inside without the need for any type of diffuser.

In this case, just place the LED strip inside the channel. Thanks to its concave shape, there's no need to use any profile-diffuser or diffuser for indirect lighting. Then embed it.

We recommend using **COB EGON** strips to achieve a more uniform and diffused illumination.

TECHNICAL SPECIFICATIONS:

Profile material:	PVC
Profile finish:	○ White ● Black ● Aluminium
Max. LED width	10mm
Standard LED power:	15 W/m
Length of profile:	2.60m
Guarantee:	4 años ¹

¹ When properly installed, used and maintained

COMPATIBLE LEDs:

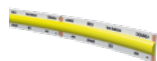

COB EGON 12V/11W

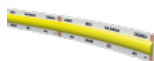

COB EGON 24V/15W



COB EGON RGB 24V/12W

12/24V COMPATIBLE ACCESSORIES:



Power supply
17FA-140-12 20W/60W/100W
17FA-141-24 30W/75W/120W/180W



Pseudo-touch Sensor Switch
For cupboards and drawers
17AE-033
100-240V 300W



Presence sensor
for doors
17AE-026
12V/36W-24V/72W



Sensor ON-OFF
Surface dimmer
17AE-024
12V/36W-24V/72W



Sensor Switch
Bluetouch indicator light
17AE-021
12-24V



Sensor ON-OFF
Recessed dimmer
17AE-023
12V/36W-24V/72W



Motion sensor
Detection 0.5-2m
76x35x19.5
17AE-025

RGB COMPATIBLE ACCESSORIES:



RGBW sequencer
6A x channel Max. 10A
Battery not included
17AE-150



Wifi RGBW sequencer
4 channels Max.15A
17AE-151



Power supply
17FA-141-24
30W/75W/120W/180W

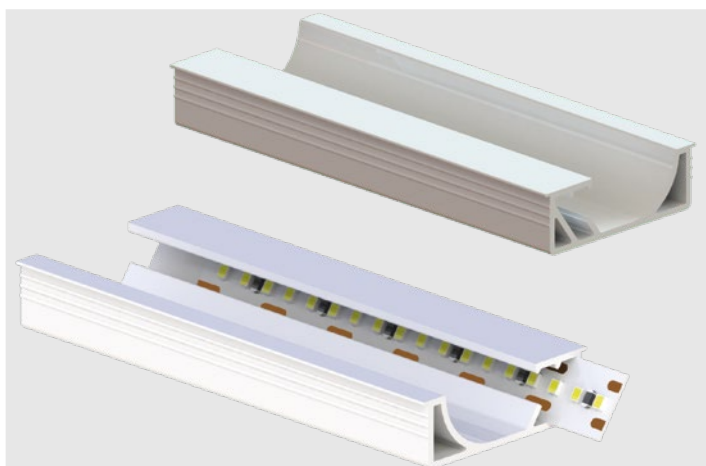

SECTION:

Tolerance ± 0.4

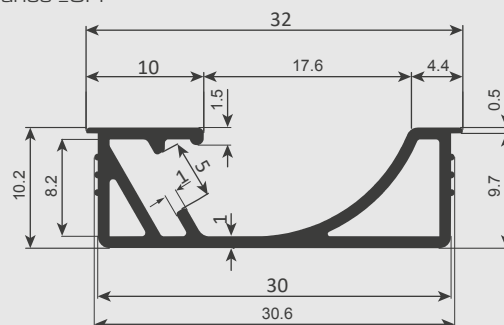

INSTALLATION:

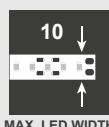

MAX. LED WIDTH

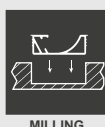

MILLING



CEILING



WALL

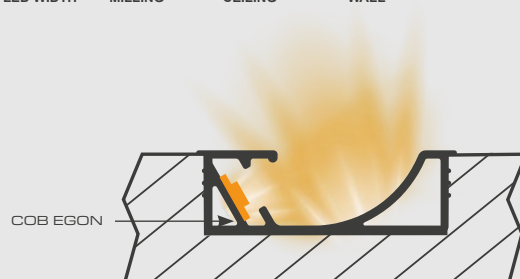

MILLING:

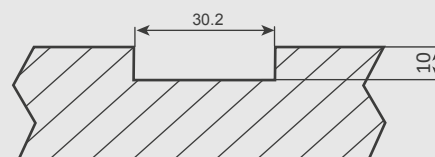

Remember to mill the surface when you receive the product and check its tolerance.





INTERIOR



EXTERIOR



LED POWER



LED 12V/24V



FLEXIBLE



MAGNETIC



SURFACE



CEILING



WALL

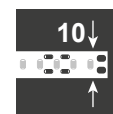

MAX. LED WIDTH



CLIP ATTACHMENT

NOYCE
Ref. B866

High-quality flexible magnetic profile designed to house the LED strip and dissipate the heat generated.

In this case, simply attach the LED strip to the profile, then align the diffuser profile, and finally install it by means of magnets on metallic or non-metallic surfaces using screws.

We recommend using it with our diffuser **PASCAL C191**.

We recommend using **COB EGON** LED strips to achieve a more uniform and diffused illumination.

TECHNICAL SPECIFICATIONS:

Profile material:	Ferro Magnetic
Profile finish:	Dark brown
Max. LED width:	10mm
Standard LED power:	30 W/m
Length of profile:	2.60m
Guarantee:	4 years*

* Properly installed, used and maintained

COMPATIBLE LEDS:

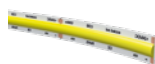

COB EGON 12V/11W



COB EGON 24V/15W



COB EGON RGB 24V/12W

COMPATIBLE DIFFUSERS:



Profile-diffuser
PASCAL C191

COMPATIBLE COVERS:



Cap with hole*
PASCAL C611



Cap without hole*
PASCAL C612

* To insert the cap with the profile and the diffuser, leave 1 cm of diffuser without profile.

COMPATIBLE ACCESSORIES:



Clip Attachment
NOYCE/MARCONI C613

12/24V COMPATIBLE ACCESSORIES:



Power supply
17FA-140-12 20W/60W/100W
17FA-141-24 30W/75W/120W/180W



Pseudo-touch Sensor Switch
For cupboards and drawers
17AE-033
100-240V 300W



Presence sensor
for doors
17AE-026
12V/36W-24V/72W



Sensor ON-OFF
Surface dimmer
17AE-024
12V/36W-24V/72W



Sensor Switch
Bluetooth indicator light
17AE-021
12-24V



Sensor ON-OFF
Recessed dimmer
17AE-023
12V/36W-24V/72W



Motion sensor
Detection 0.5-2m
76x35x19.5
17AE-025

RGB COMPATIBLE ACCESSORIES:



RGBW sequencer
6A x channel Max. 10A
Battery not included
17AE-150



Wifi RGBW sequencer
4 channels Max. 15A
17AE-151



Power supply
17FA-141-24
30W/75W/120W/180W



SECTION:
Tolerance ± 0.4

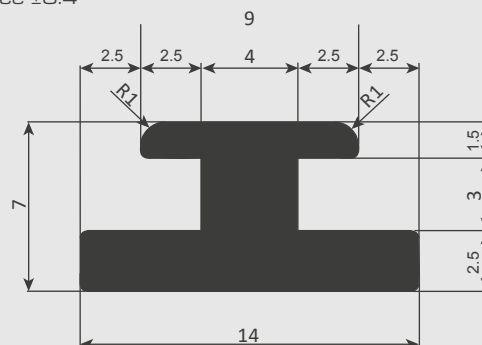

INSTALLATION:

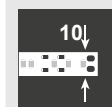

MAX. LED WIDTH



SURFACE



CEILING



WALL



MAGNETIC



FLEXIBLE



CLIP ATTACHMENT

PASCAL
C191



COB EGON

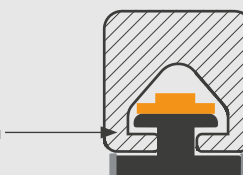

MAGNET EFFECT





INTERIOR



EXTERIOR



LED POWER



LED 12V/24V



LED 220V



FLEXIBLE



SURFACE



CEILING



WALL

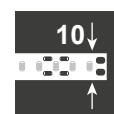

MAX. LED WIDTH ATTACHMENT CLIP

MARCONI
Ref. C220

Attachment profile and heat sink made of high-quality aluminium.

In this case, just stick the LED strip to the profile, line it up with the profile-diffuser and install it on the surface with the option of bending it.

We recommend using it with our diffuser profile **PASCAL C191** or our **ABS diffuser DEGAS C570**

We recommend using **COB EGON** LED strips to achieve a more uniform and diffused illumination.

TECHNICAL SPECIFICATIONS:

Profile material:	Aluminium
Profile finish:	Anodised
Max. LED width:	10mm
Standard LED power:	15 W/m
Length of profile:	2.60m
Guarantee:	4 years*

* Properly installed, used and maintained

COMPATIBLE LEDS:



COB EGON 12V/11W



COB EGON 24V/15W



COB EGON RGB
24V/12W



NIKOLA 220V
* depending on
installation

COMPATIBLE DIFFUSERS:



Profile-diffuser
PASCAL C191



Profile-diffuser
DEGAS C570

COMPATIBLE COVERS: COMPATIBLE ACCESSORIES:



Cap with hole*
PASCAL C611



Cap without hole*
PASCAL C612



Clip Attachment
NOYCE/MARCONI C613



Clip Attachment
NOYCE/DEGAS C616

* To insert the cap with the profile and the diffuser, leave 1 cm of the diffuser uncovered by the profile.

220V COMPATIBLE ACCESSORIES:



Pseudo-touch Sensor Switch
For cupboards and drawers
17AE-033
100-240V 300W



Motion sensor
Detection 0.5-2m
76x35x19.5
17AE-025

12/24V COMPATIBLE ACCESSORIES:



Power supply
17FA-140-12 20W/60W/100W
17FA-141-24 30W/75W/120W/180W



Pseudo-touch Sensor Switch
For cupboards and drawers
17AE-033
100-240V 300W



Presence sensor
for doors
17AE-026
12V/36W-24V/72W



Sensor ON-OFF
Surface dimmer
17AE-024
12V/36W-24V/72W



Sensor Switch
Bluetooth indicator light
17AE-021
12-24V



Sensor ON-OFF
Recessed dimmer
17AE-023
12V/36W-24V/72W



Motion sensor
Detection 0.5-2m
76x35x19.5
17AE-025

RGB COMPATIBLE ACCESSORIES:



RGBW sequencer
6A x channel Max. 10A
Battery not included 17AE-150



Wifi RGBW sequencer
4 channels Max. 15A
17AE-151



Power supply
17FA-141-24
30W/75W/120W/180W

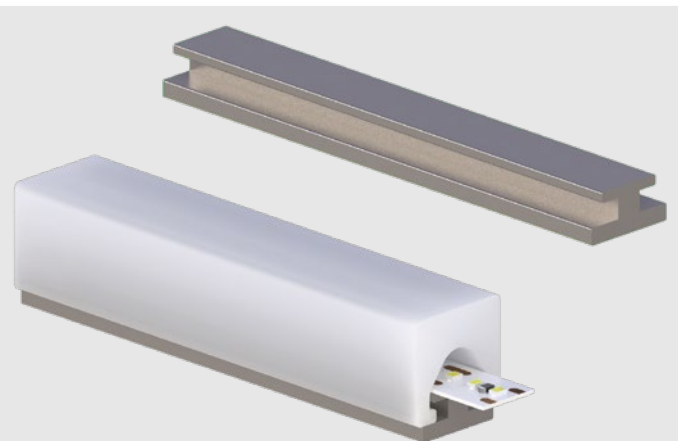

SECTION:
Tolerance ± 0.4

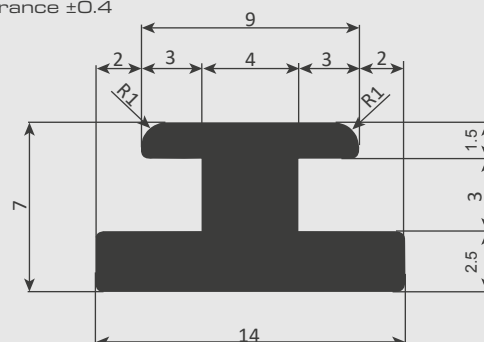

INSTALLATION:

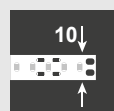

MAX. LED WIDTH



SURFACE



CEILING



WALL



ADHESIVE TAPE

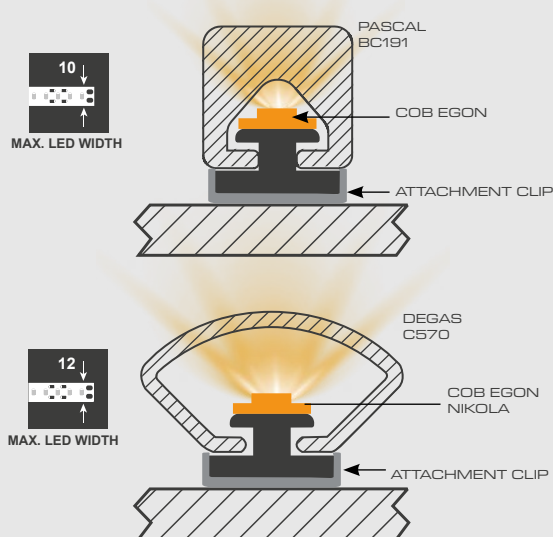



INTERIOR



EXTERIOR

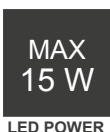

LED POWER



LED 12V/24V



LED 220V



MILLING



CEILING



WALL

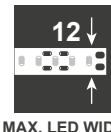

MAX. LED WIDTH

THOMAS
Ref. C219

High-quality aluminium plate perfect for diffusing the heat produced by LED strips in moulding.

In this case simply make a milling cut, place the LED strip on our aluminium plate, then insert the plate into the channel of our diffuser and finally fit the whole assembly into the milling cut.

We recommend using **COB EGON** or **NIKOLA** LED strips (depending on the installation) to achieve a more uniform and diffused illumination.

TECHNICAL SPECIFICATIONS:

Profile material:	Aluminium
Profile finish:	Aluminium
Max. LED width:	12mm
Standard LED power:	15 W/m
Length of profile:	2.60m
Guarantee:	4 years*

* Properly installed, used and maintained

COMPATIBLE LEDS:

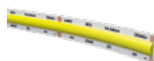

COB EGON 12V/11W



COB EGON 24V/15W



COB EGON RGB 24V/12W



NIKOLA 220V
* depending on installation

COMPATIBLE DIFFUSERS:



GOYA C218



TIZIANO B258



VELAZQUEZ B136



JOBS B137



EDISON C056

220V COMPATIBLE ACCESSORIES:



Pseudo-touch Sensor Switch
For cupboards and drawers
17AE-033
100-240V 300W



Motion sensor
Detection 0.5-2m
76x35x19.5
17AE-025

12/24V COMPATIBLE ACCESSORIES:



Power supply
17FA-140-12 20W/60W/100W
17FA-141-24 30W/75W/120W/180W



Pseudo-touch Sensor Switch
For cupboards and drawers
17AE-033
100-240V 300W



Presence sensor
for doors
17AE-026
12V/36W-24V/72W



Sensor ON-OFF
Surface dimmer
17AE-024
12V/36W-24V/72W



Sensor Switch
Bluetouch indicator light
17AE-021
12-24V



Sensor ON-OFF
Recessed dimmer
17AE-023
12V/36W-24V/72W



Motion sensor
Detection 0.5-2m
76x35x19.5
17AE-025

RGB COMPATIBLE ACCESSORIES:



RGBW sequencer
6A x channel Max. 10A
Battery not included
17AE-150



Wifi RGBW sequencer
4 channels Max.15A
17AE-151



Power supply
17FA-141-24
30W/75W/120W/180W

SECTION:

Tolerance ± 0.4



INSTALLATION:

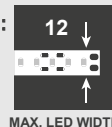

MAX. LED WIDTH



MILLING



CEILING



WALL

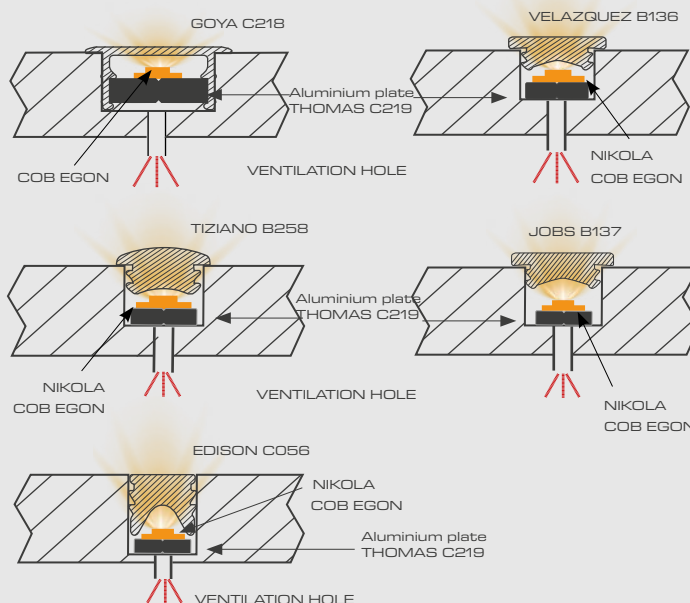

MILLING:

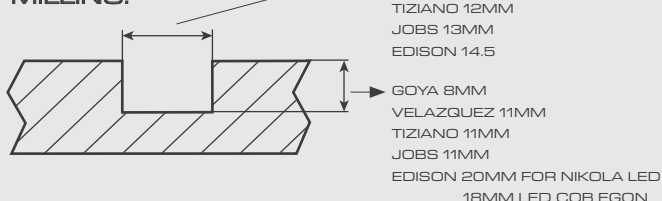

Remember to mill the surface when you receive the product and check its tolerance.





TECHNICAL DATA SHEET

ANGELO



INTERIOR



EXTERIOR



LED POWER



LED 12V/24V



SURFACE



CEILING



WALL



MAX. LED WIDTH



ADHESIVE TAPE



ATTACHMENT CLIP

ANGELO
Ref. B888

High-quality rigid ABS profile, designed to fit our ABS diffuser MICHEL B887.

In this case, just insert the LED strip in the profile, line up the diffuser with the profile and attach with our attachment clip. We recommend using **COB EGON** LED strips to achieve a more uniform and diffused illumination.

TECHNICAL SPECIFICATIONS:

Profile material:	ABS
Profile finish:	○ White
Max. LED width	9mm
Standard LED power:	15 W/m
Length of profile:	2.60m
Guarantee:	4 years*

* Properly installed, used and maintained

COMPATIBLE LEDS:

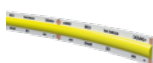

COB EGON 12V/11W



COB EGON 24V/15W



COB EGON RGB 24V/12W

COMPATIBLE DIFFUSERS:



Rigid diffuser
MICHEL B887

COMPATIBLE COVERS:



Cover without hole
ANGELO C608



ANGELO C609 cover
with hole

COMPATIBLE ACCESSORIES:



Attachment Clip
ANGELO C610

12/24V COMPATIBLE ACCESSORIES:



Power supply
17FA-140-12 20W/60W/100W
17FA-141-24 30W/75W/120W/180W



Pseudo-touch Sensor Switch
For cupboards and drawers
17AE-033
100-240V 300W



Presence sensor
for doors
17AE-026
12V/36W-24V/72W



Sensor ON-OFF
Surface dimmer
17AE-024
12V/36W-24V/72W



Sensor Switch
Blue touch indicator light
17AE-021
12-24V



Sensor ON-OFF
Recessed dimmer
17AE-023
12V/36W-24V/72W



Motion sensor
Detection 0.5-2m
76x35x19.5
17AE-025

RGB COMPATIBLE ACCESSORIES:



RGBW sequencer
6A x channel Max. 10A
Battery not included
17AE-150



Wifi RGBW sequencer
4 channels Max. 15A
17AE-151



Power supply
17FA-141-24
30W/75W/120W/180W

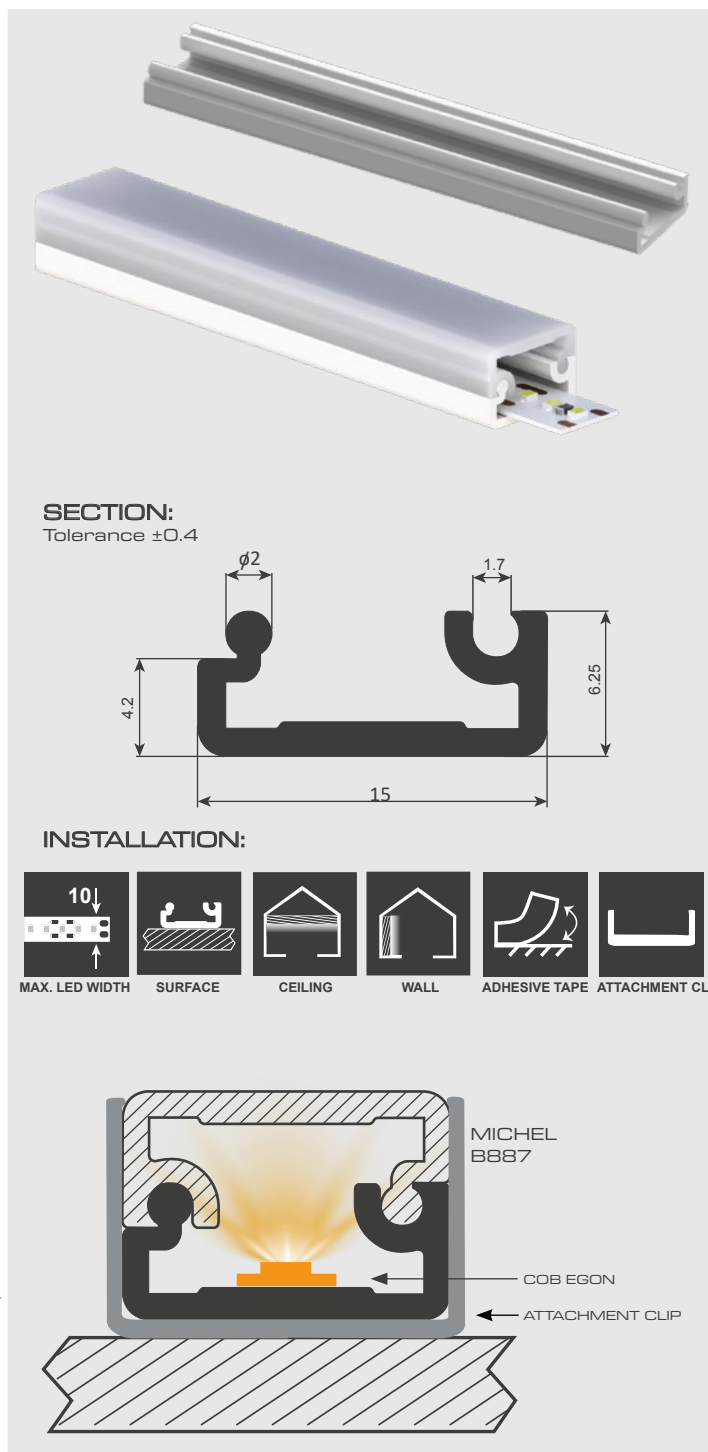



INTERIOR



EXTERIOR

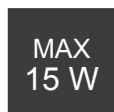

LED POWER



LED 220V



LED 12V/24



SURFACE



CEILING



WALL

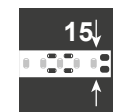

MAX. LED WIDTH



SCREW-IN

PLADUR
Ref. C740

High-quality aluminium attachment profile designed to house the LED strip inside.

Ideal for plasterboard installations.

In this case place the LED strip inside the profile, then attach our diffuser and finally install the assembly.

We recommend using it with our VELAZQUEZ B136 diffuser.

We recommend using our **COB EGON** and **NIKOLA** LED strips to achieve a more uniform and diffused illumination.

TECHNICAL SPECIFICATIONS:

Profile material:	Aluminium
Profile finish:	● Anodised
Max. LED width	15mm
Standard LED power:	15 W/m
Length of profile:	2.60m
Guarantee:	4 años ¹

¹ When properly installed, used and maintained

COMPATIBLE LEDS:

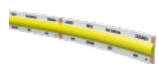

COB EGON 12V/11W

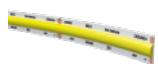

COB EGON 24V/15W



COB EGON RGB
24V/12W



NIKOLA 220V

COMPATIBLE DIFFUSERS:



Diffuser
VELAZQUEZ B136

220V COMPATIBLE ACCESSORIES:



Pseudo-touch Sensor Switch
For cupboards and drawers
17AE-033
100-240V 300W



Motion sensor
Detection 0.5-2m
76x35x19.5
17AE-025

12/24V COMPATIBLE ACCESSORIES:



Power supply
17FA-140-12 20W/60W/100W
17FA-141-24 30W/75W/120W/180W



Pseudo-touch Sensor Switch
For cupboards and drawers
17AE-033
100-240V 300W



Presence sensor
for doors
17AE-026
12V/36W-24V/72W



Sensor ON-OFF
Surface dimmer
17AE-024
12V/36W-24V/72W



Sensor Switch
Bluetouch indicator light
17AE-021
12-24V



Sensor ON-OFF
Recessed dimmer
17AE-023
12V/36W-24V/72W



Motion sensor
Detection 0.5-2m
76x35x19.5
17AE-025

RGB COMPATIBLE ACCESSORIES:



RGBW sequencer
6A x channel Max. 10A
Battery not included
17AE-150



Wifi RGBW sequencer
4 channels Max.15A
17AE-151



Power supply
17FA-141-24
30W/75W/120W/180W

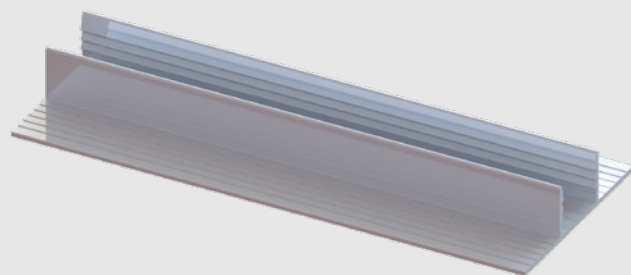

SECTION:
Tolerance ± 0.4

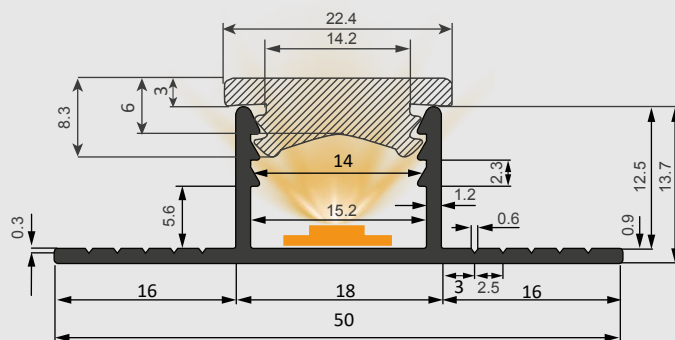

INSTALLATION:



SURFACE



CEILING



WALL



SCREW-IN



Install screw
countersunk lag screw

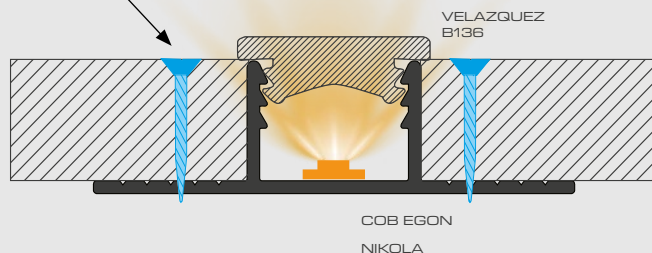

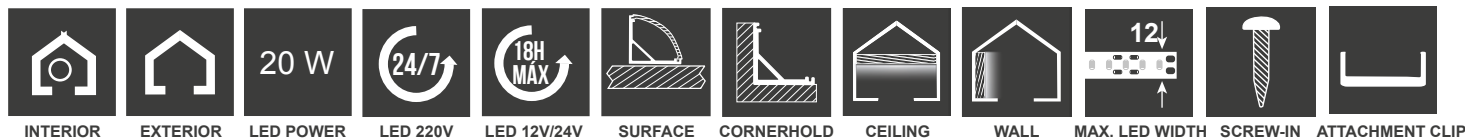

BERNERS

Ref. SILVER 17PS-053PL

Angled profile, made of high-purity aluminium, available in anodised silver.

Ideal for surface installations on walls, furniture, shelves and the like where a profile is required that emits light at an oblique angle to help diffuse the light spot and dissipate heat.

We recommend the use of our diffusers and our **COB EGON** and **NIKOLA** LED strips to achieve a more uniform and diffused illumination.

TECHNICAL SPECIFICATIONS:

Profile material:	Aluminium
Profile finish:	Silver
Max. LED width:	12mm
Standard LED power:	20 W/m
Length of profile:	2.60m
Guarantee:	4 years*

* Properly installed, used and maintained

COMPATIBLE LEDS:



COB EGON 12V/11W

COB EGON 24V/15W

COB EGON RGB
24V/12W

NIKOLA 220V

COMPATIBLE DIFFUSERS:



Diffuser
Berners 17PD-0710P

COMPATIBLE COVERS:



Plastic Cover
With hole, grey 17TP-104GR
Without hole, grey 17TP-105GR

COMPATIBLE ACCESSORIES:



Clip Attachment
Transparent
17TP-118TR

220V COMPATIBLE ACCESSORIES:



Pseudo-touch Sensor Switch
For cupboards and drawers
17AE-033
100-240V 300W



Motion sensor
Detection 0.5-2m
76x35x19.5
17AE-025

12/24V COMPATIBLE ACCESSORIES:



Power supply
17FA-140-12 20W/60W/100W
17FA-141-24 30W/75W/120W/180W



Pseudo-touch Sensor Switch
For cupboards and drawers
17AE-033
100-240V 300W



Presence sensor
for doors
17AE-026
12V/36W-24V/72W



Sensor ON-OFF
Surface dimmer
17AE-024
12V/36W-24V/72W



Sensor Switch
Bluetouch indicator light
17AE-021
12-24V



Sensor ON-OFF
Recessed dimmer
17AE-023
12V/36W-24V/72W



Motion sensor
Detection 0.5-2m
76x35x19.5
17AE-025



SECTION:

Tolerance +0.3/-0.2

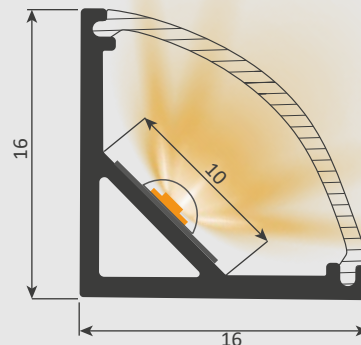

INSTALLATION:



CORNERHOLD SURFACE CEILING WALL SCREW-IN ATTACHMENT

CORNER APPLICATION:

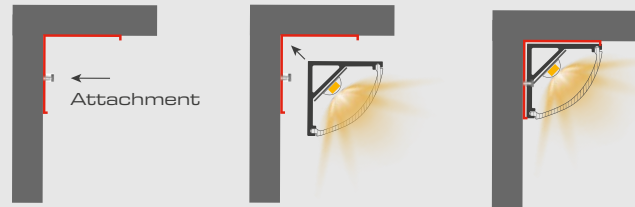

RGB COMPATIBLE ACCESSORIES:



RGBW sequencer
6A x channel Max. 10A
Battery not included
17AE-150



Wifi RGBW sequencer
4 channels Max.15A
17AE-151



Power supply
17FA-141-24
30W/75W/120W/180W





TECHNICAL DATA SHEET

DUMOND SLIM

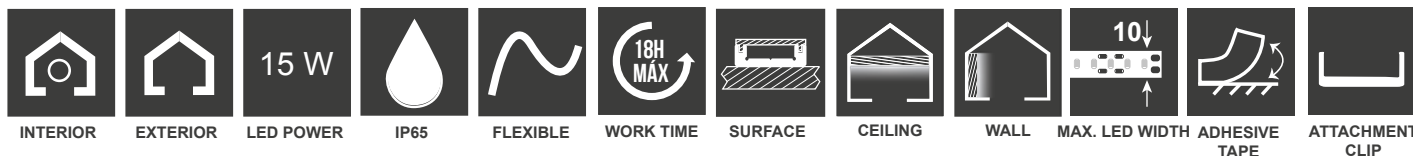

DUMOND SLIM

Ref. SILVER 17PS-001AL

BLACK 17PS-001NE

Profile made of high-purity aluminium, available in two different colours (the profile can also be supplied in raw aluminium without paint coating). With a height of only 4.05mm.

The profile is ideal for surface installations on walls, furniture, shelves and the like where a minimalist profile of very small dimensions is required.

Its diffuser gives an IP65 rating to the lighting fixture manufactured with this profile, which is very useful in places with high humidity.

We recommend using our diffusers and our **COB EGON** LED strips to achieve a more uniform and diffused illumination.

TECHNICAL SPECIFICATIONS:

Profile material:	Aluminium
Profile finish:	● Silver ● Black
Max. LED width	10mm
Standard LED power:	15 W/m
Length of profile:	2.60m
Guarantee:	4 years*

* Properly installed, used and maintained

COMPATIBLE LEDS:

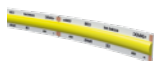

COB EGON 12V/11W

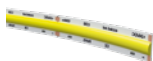

COB EGON 24V/15W

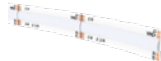

COB EGON RGB 24V/12W

COMPATIBLE DIFFUSERS:



Darkness
White 17PD-003BL



Darkness
Black 17PD-003NE

COMPATIBLE COVERS:



Dumond Slim plastic caps

Without hole grey 17TP-008AL

With hole grey 17TP-007AL

Without hole black 17TP-008NE

With hole black 17TP-007NE

COMPATIBLE ACCESSORIES:



Profile bending device



Clip Attachment
Transparent 17TP-10TR

RGB COMPATIBLE ACCESSORIES:



RGBW sequencer
6A x channel Max. 10A
Battery not included
17AE-150



Wifi RGBW sequencer
4 channels Max.15A
17AE-151



Power supply
17FA-141-24
30W/75W/120W/180W

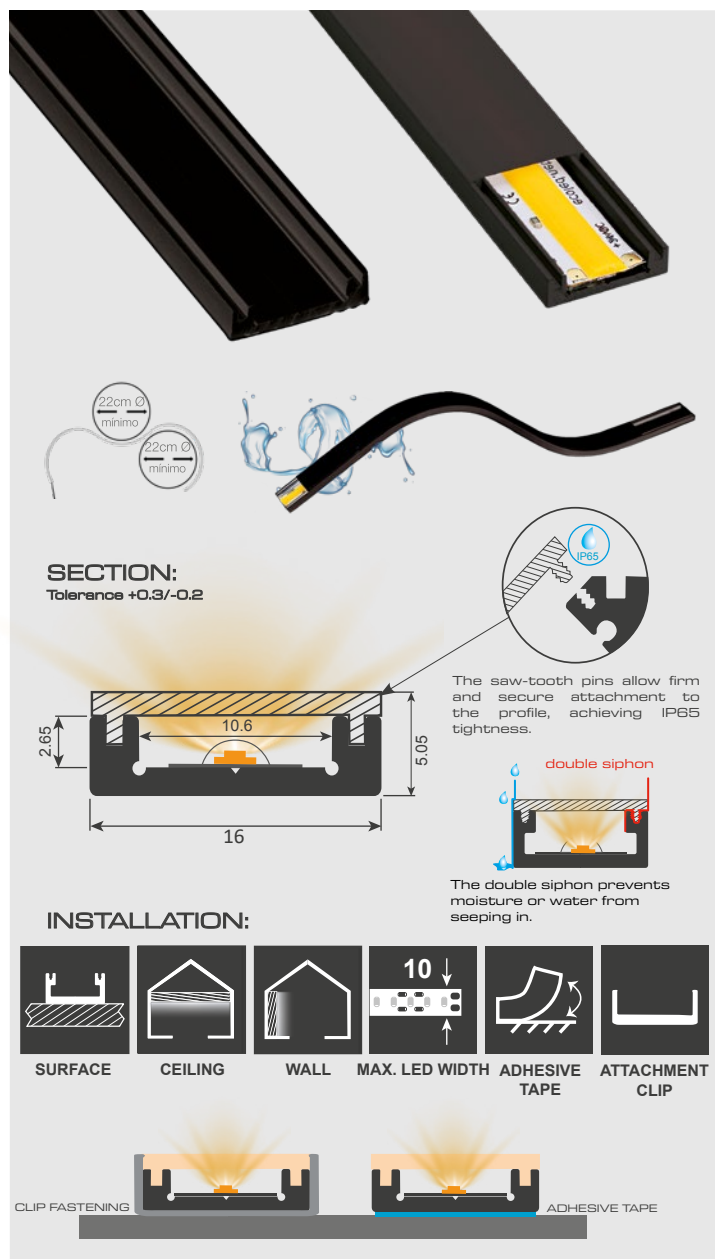

12/24V COMPATIBLE ACCESSORIES:



Power supply
17FA-140-12 20W/60W/100W
17FA-141-24 30W/75W/120W/180W



Pseudo-touch Sensor Switch
For cupboards and drawers
17AE-033
100-240V 300W



Presence sensor
for doors
17AE-026
12V/36W-24V/72W



Sensor ON-OFF
Surface dimmer
17AE-024
12V/36W-24V/72W



Sensor Switch
Bluetooth indicator light
17AE-021
12-24V



Sensor ON-OFF
Recessed dimmer
17AE-023
12V/36W-24V/72W



Motion sensor
Detection 0.5-2m
76x35x19.5
17AE-025





Ref. 17RL230AF 6000°K

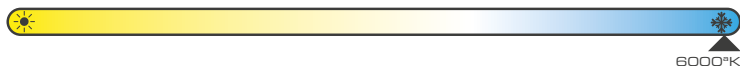

High quality opaline silicone profile extruded with an LED strip inside. Suitable for illuminating mouldings, cornices, etc... for up to 50 consecutive metres without a drop in luminosity. Direct 220V-AC power supply without the need for a trans-

former. It has a lateral fin with a longitudinal groove that allows the profile to be screwed or nailed to the desired surface. It doesn't require aluminium for heat dissipation, and it can operate for up to 24 hours uninterrupted. It can be cut every 10 cm.

It can be controlled via a TRIAC dimmer.

Thanks to its screw-on connection kit, no soldering is required, and its IP67 watertightness and UV protection make it suitable for outdoor and damp areas (it is essential to perfectly seal the connector and end cap with the silicone included in the kit).

TECHNICAL SPECIFICATIONS:

Material:	Silicone glaze
Colour:	Semi-opaline
Power (W):	14 W/m
Voltage:	220V-AC
Light temperature:	6000 K
Lumens 6000°K:	1500 Lm/m
Angle of light emission:	120°
Waterproof (IP):	IP67
N° LEDs/m:	140
Measurements:	14x10 mm
Sectioning:	every 100mm
PCB:	10mm
CRI:	>80
Dimmable with dimmer:	Yes
Power factor:	>85
Operating temperature:	-20°/+35°
Packaging:	25m roll
Guarantee:	3 years*
Operating life:	30,000h*

* Properly installed, used and maintained

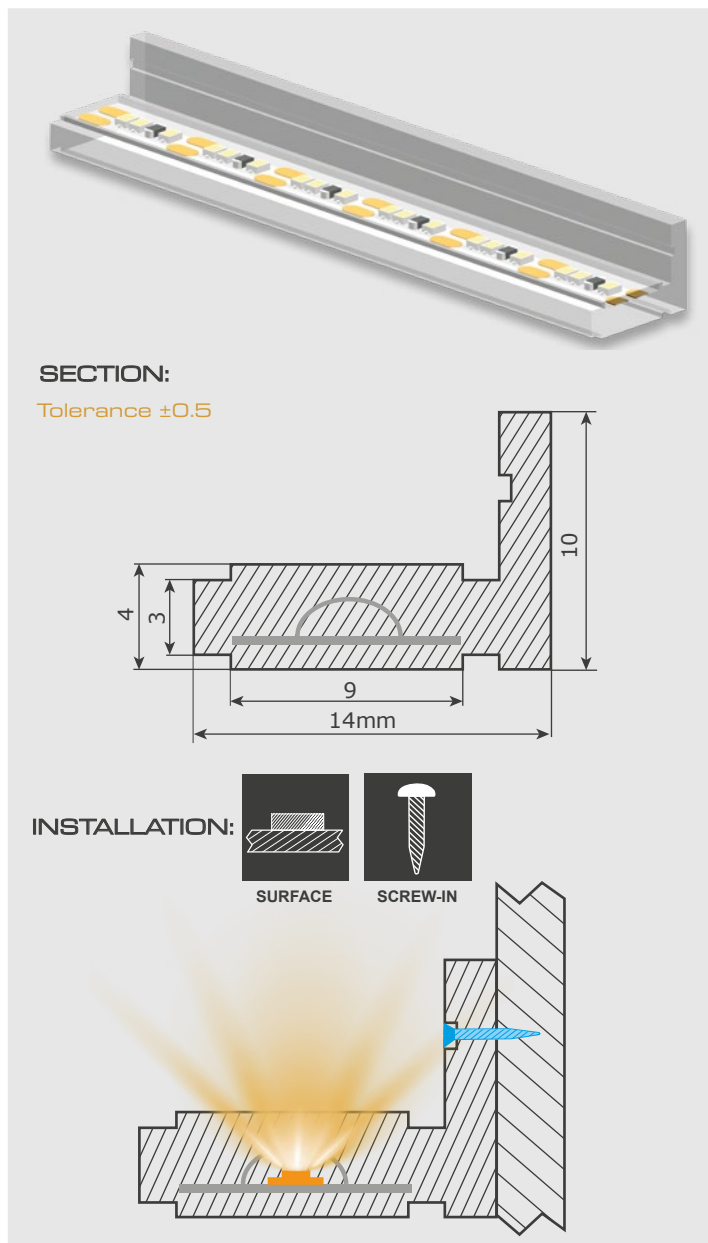

TECHNICAL DATA SHEET

PICASSO



INTERIOR



EXTERIOR

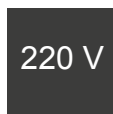

220 V

VOLTAGE



MAX.
14 W

POWER

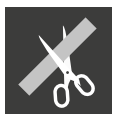

100MM



IP67



120°

ANGLE EMISSION



24/7

WORK TIME

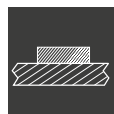

SURFACE



SCREW-IN

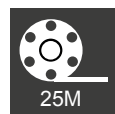

25M

ROLL

Ref. 17RL230PF
Ref. 17RL230PN

6000°K
4000°K

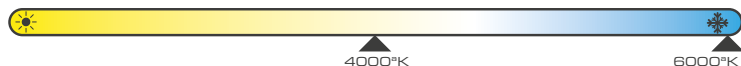

High quality opaline silicone profile extruded with an LED strip inside. Suitable for illuminating mouldings, cornices, etc... for up to 50 consecutive metres without a drop in luminosity.

Direct 220V-AC power supply without the need for a transformer.

It features horizontal slits which allow it to be installed on the desired surface.

It doesn't require aluminium for heat dissipation, and it can operate for up to 24 hours uninterrupted.

It can be cut every 10 cm.

It can be controlled via a TRIAC dimmer.

Thanks to its screw-on connection kit, no soldering is required, and its IP67 watertightness and UV protection make it suitable for outdoor and damp areas (it is essential to perfectly seal the connector and end cap with the silicone included in the kit).

TECHNICAL SPECIFICATIONS:

Material:	Silicone glaze
Colour:	Semi-opaline
Power (W):	14 W/m
Voltage:	220V-AC
Light temperature:	6000°K/4000°K:
Lumens 6000°K/ 4000°K:	1500 Lm/m
Angle of light emission:	120°
Waterproof (IP):	IP67
N° LEDs/m:	140
Measurements:	26x4 mm
Sectioning:	every 100mm
PCB:	10mm
CRI:	>80
Dimmable with dimmer:	Yes
Power factor:	>85
Operating temperature:	-20°/+35°
Packaging:	25m roll
Guarantee:	3 years*
Operating life:	30,000h*

* Properly installed, used and maintained

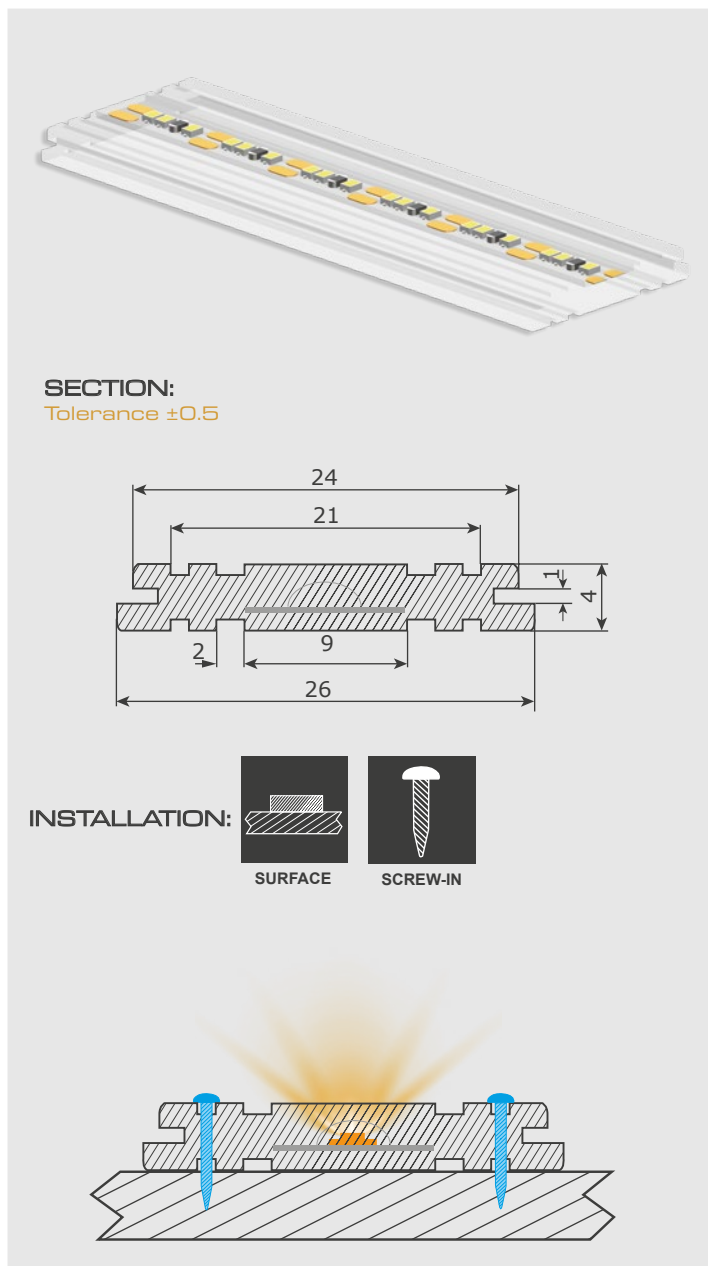

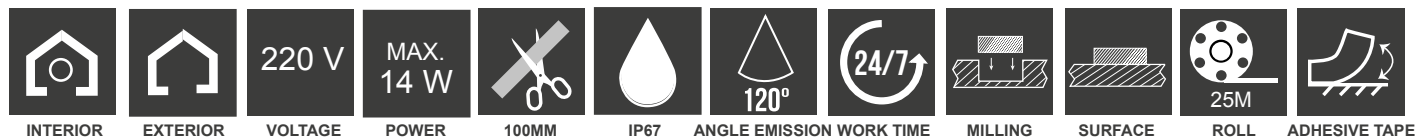

Ref. 17RL230PX 6500°K
 Ref. 17RL230PS 4500°K
 Ref. 17RL230PC 2700°K



High quality opaline silicone profile extruded with an LED strip inside. Suitable for illuminating mouldings, cornices, etc... for up to 50 consecutive metres without a drop in luminosity. Direct 230V-AC power supply without the need for a transformer.

It features adhesive tape which allows it to be installed on the desired surface.

No need for aluminium to dissipate heat.

It can be controlled via a TRIAC dimmer.

Thanks to its screw-on connection kit, there's no need for welding, and its IP67 watertight rating and UV protection mean that it's suitable for use outdoors and in humid areas (the connector and end cap must be perfectly sealed with silicone in this kit)

Adjustable via TRIAC from 40 to 100%.

TECHNICAL SPECIFICATIONS:

Material:	Silicone glaze
Colour:	Crystal clear
Power (W):	14 W/m
Voltage:	220V-AC
Light temperature:	6500°K/ 4500°K/ 2700°K
Lumens 6500°K:	1680 Lm/m
Lumens 4500°K:	1450 Lm/m
Lumens 2700°K:	1350 Lm/m
Angle of light emission:	120°
Waterproof (IP):	IP67
N° LEDs/m:	140
Measurements:	12x4 mm
Sectioning:	every 100mm
PCB:	12mm
Dimmable with dimmer:	Yes
Operating temperature:	-20°/+40°
Packaging:	25m roll
Guarantee:	3 years*
Operating life:	30,000h*

* Properly installed, used and maintained

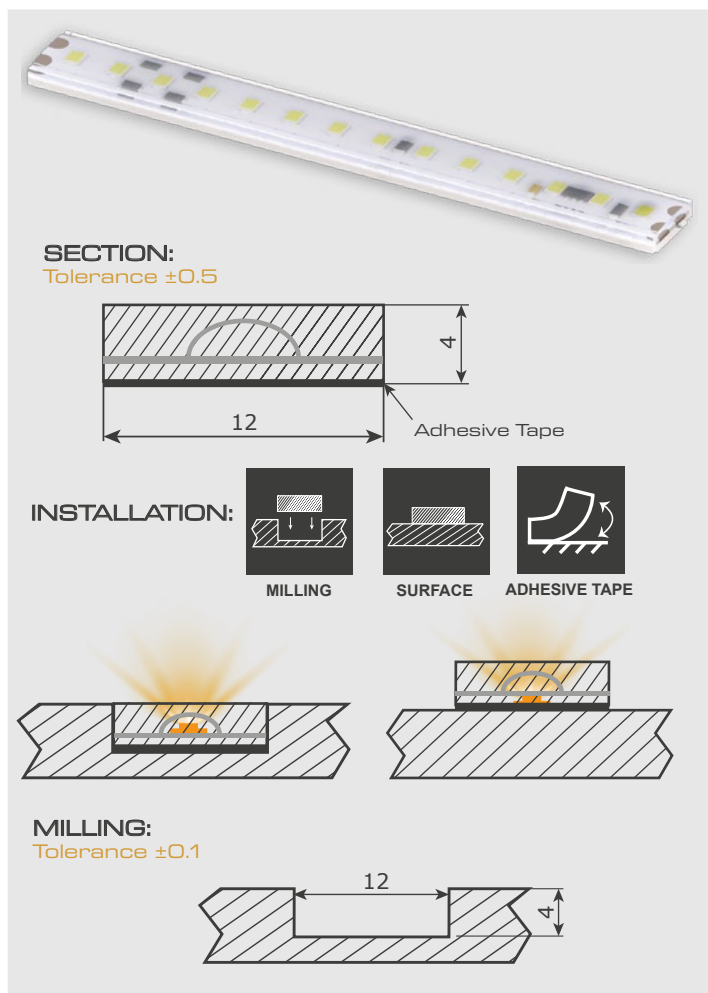



TECHNICAL DATA SHEET

COB EGON

Ref. 17RL-146-6000-5 6000°K 1170Lm/m
 Ref. 17RL-146-4000-5 4000°K 1140Lm/m
 Ref. 17RL-146-2800-5 2800°K 1000Lm/m



INTERIOR

12 V

VOLTAGE

MAX.
11 W

POWER



10MM



IP20



ANGLE EMISSION



WORK TIME

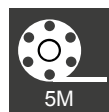

ROLL



The new flexible strips with COB technology allow linear illumination without visible LED spots. In contrast to conventional strips, the chip is fixed directly on the PCB without the need for the SMD die (frame). By attaching it directly to the base of the strip, it offers increased heat dissipation.

TECHNICAL SPECIFICATIONS:

Material:	Silicone glaze
Colour:	Opaline.
Power (W):	11 W/m
Voltage:	12 V
Type of LED:	COB
CRI:	>90
Light emission:	120°
Waterproof (IP):	IP20
N° LEDs/m:	600
Measurements:	5000x8x1.6 mm
Sectioning:	every 10mm
PCB:	8mm
Operating temperature:	-25°/+45°
Packaging:	5m roll
Guarantee:	2 years ¹
Max. open-circuit connection:	5m
Max. closed-circuit connection:	10m
Max. connection per section:	10m
Max. recommended daily use:	20h
Operating life:	50,000h ²

¹ When properly installed, used and maintained

² Depending on the profile heat dissipation, the daily operating hours and the external ambient temperature of the working environment.

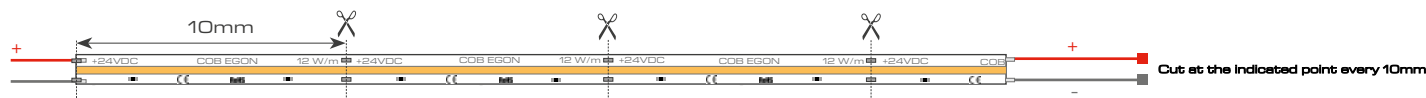
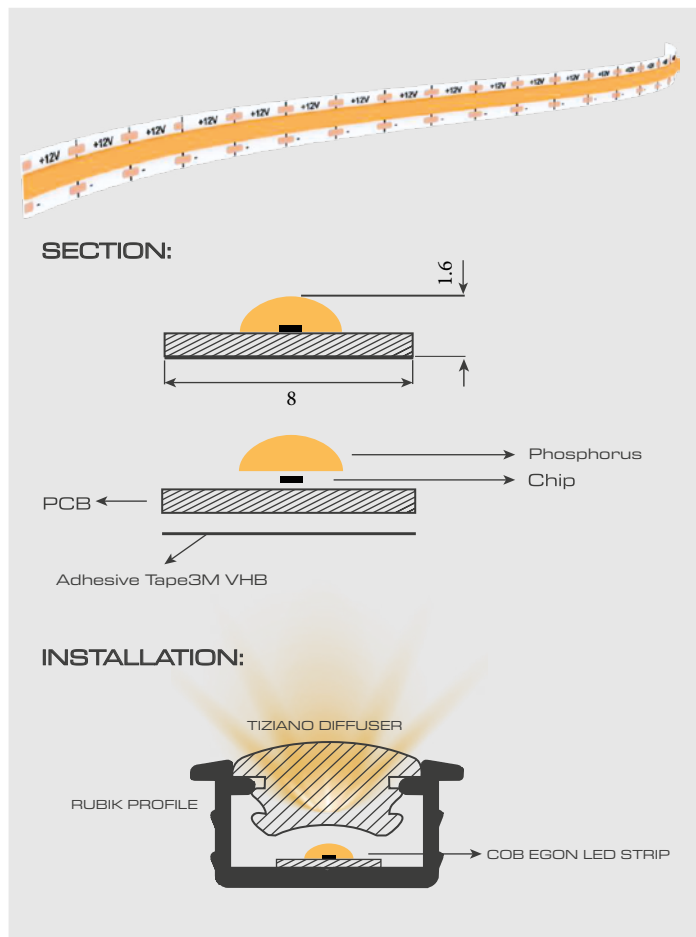

COMPATIBLE ACCESSORIES:



Power supply
17FA-140-12-20 12V/30W
17FA-140-12-60 12V/60W
17FA-140-12-100 12V/100W



Sensor Switch
Bluetouch indicator light
17AE-021
12-24V



Presence sensor
for doors
17AE-026
12V/36W-24V/72W



Sensor ON-OFF
Surface dimmer
17AE-024
12V/36W-24V/72W



Sensor ON-OFF
Recessed dimmer
17AE-023
12V/36W-24V/72W



Motion sensor
Detection 0.5-2m
76x35x19.5
17AE-025



Pseudo-touch Sensor Switch
For cupboards and drawers
17AE-033
100-240V 300W



Pressure connector
PCB 8mm
17AE-142-8



TECHNICAL DATA SHEET

COB EGON

Ref. 17RL-005-6500 6500°K 1530Lm/m
 Ref. 17RL-005-4000 4000°K 1500Lm/m
 Ref. 17RL-005-3000 3000°K 1400Lm/m
 Ref. 17RL-005-2500 2500°K 1330Lm/m



INTERIOR

24 V

VOLTAGE

MAX.
15 W

POWER



50MM



IP20



180°



20H MAX
WORK TIME

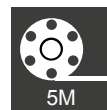

5M
ROLL

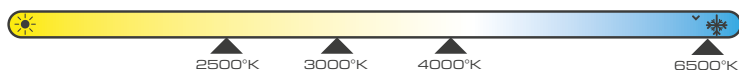

The new flexible strips with COB technology allow linear illumination without visible LED spots. In contrast to conventional strips, the chip is fixed directly on the PCB without the need for the SMD die (frame). When attached directly to the base of the strip it offers greater thermal dissipation but its structural strength is lower, which is why the flexible COB EGON strips from FLEX&LUX incorporate a steel sheet on the back of the PCB that helps with thermal dissipation, but above all it provides 80% greater resistance to torsion than the rest of the COB strips on the market.

TECHNICAL SPECIFICATIONS:

Material:	Silicone glaze
Colour:	Opaline.
Power (W):	15 W/m
Voltage:	24V-AC
Type of LED:	COB
CRI:	>80
Light emission:	180°
Waterproof (IP):	IP20
N° LEDs/m:	480
Measurements:	5000x10x2 mm
Sectioning:	every 50mm
PCB:	10mm
Operating temperature:	-20°/+40°
Packaging:	5m roll
Guarantee:	2 years ¹
Max. open-circuit connection:	5m
Max. closed-circuit connection:	10m
Max. connection per section:	10m
Max. recommended daily use:	20h
Operating life:	50,000h ²

¹ When properly installed, used and maintained

² Depending on the heat dissipation of the profile, the daily operating hours and the external ambient temperature of the working environment.

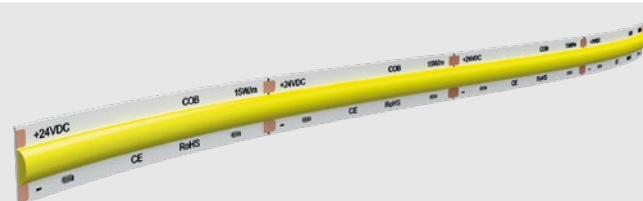

SECTION:

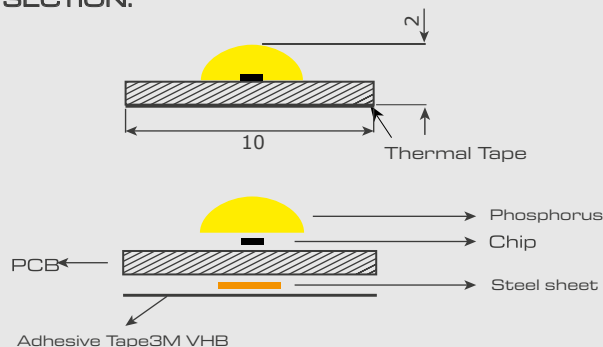

INSTALLATION:

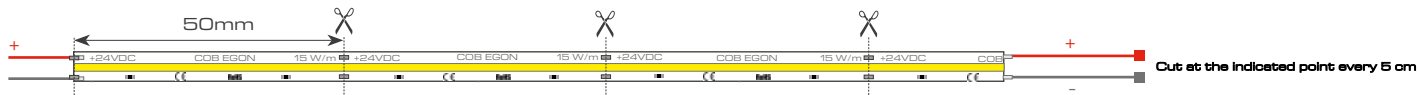
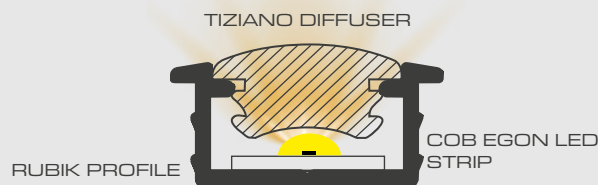

COMPATIBLE ACCESSORIES:



Power supply
 17FA-141-24-30 24V/30W
 17FA-141-24-75 24V/75W
 17FA-141-24-120 24V/120W
 17FA-141-24-180 24V/180W



Sensor Switch
 Bluetouch indicator light
 17AE-021
 12-24V



Presence sensor
 for doors
 17AE-026
 12V/36W-24V/72W



Sensor ON-OFF
 Surface dimmer
 17AE-024
 12V/36W-24V/72W



Sensor ON-OFF
 Recessed dimmer
 17AE-023
 12V/36W-24V/72W



Motion sensor
 Detection 0.5-2m
 76x35x19.5
 17AE-025



Sensor Switch
 17AE-033



Pressure connector
 PCB 10mm
 17AE-142-10



TECHNICAL DATA SHEET

COB EGON RGB



INTERIOR

24 V

VOLTAGE

MAX.
12 W

POWER



50MM



ANGLE EMISSION



WORK TIME



5M

ROLL

Ref. 17RL-149-RGB-5 513.6Lm/m

The new flexible strips with COB RGB technology allow linear illumination without visible LED spots. In contrast to conventional strips, the chip is fixed directly on the PCB without the need for the SMD die (frame). By attaching it directly to the base of the strip, it offers increased heat dissipation.

TECHNICAL SPECIFICATIONS:

Material:	Silicone glaze
Colour:	Opaline.
Power (W):	12 W/m
Voltage:	24V-AC
Type of LED:	COB
CRI:	>70
Light emission:	180°
Waterproof (IP):	IP20
N° LEDs/m:	513.6
Measurements:	5000x10x2 mm
Sectioning:	every 50mm
PCB:	10mm
Operating temperature:	-20°/+45°
Packaging:	5m roll
Guarantee:	2 years ¹
Max. open-circuit connection:	5m
Max. closed-circuit connection:	10m
Max. connection per section:	10m
Max. recommended daily use:	20h
Operating life:	50,000h ²

¹ When properly installed, used and maintained

² Depending on the heat dissipation of the profile, the daily operating hours and the external ambient temperature of the working environment.



SECTION:

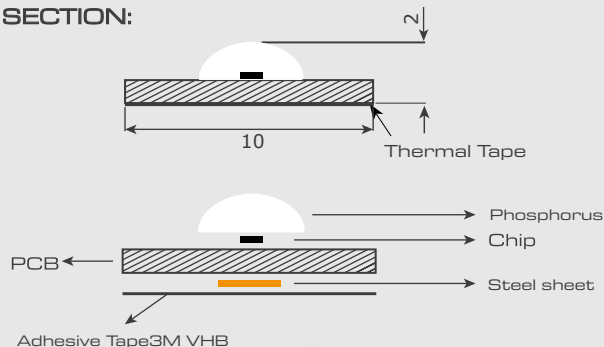

INSTALLATION:

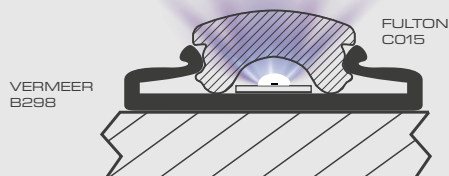

Cut at the indicated point every 5 cm

COMPATIBLE ACCESSORIES:



RGBW sequencer
6A x channel Max. 10A
Battery not included
17AE-150



Wifi RGBW sequencer
4 channels Max. 15A
17AE-151



Power supply
17FA-141-24 30W/75W/120W/180W



TECHNICAL DATA SHEET
BLUETOUCH SWITCH/SENSOR

Ref. 17AE-020

Ref. 17AE-021



The "Bluetouch" Switch/Dimmer behaves like a switch (tapping it turns it on and tapping it again turns it off) and like a dimmer (touching and holding your finger will dim it, increasing or decreasing the brightness).

Once it is switched off, it leaves an identifying "blue" halo.

If you dim to 80% and tap it, it will turn off, and when you turn it back on it will return to its previous state (80%).

Both when it is off and on, it keeps on the blue indicator light that shows us where you have to touch to turn it on/off (if you don't disconnect the mains power).

This product is used for the manufacture of KITS MANUFACTURED LED profile, always under the diffuser. Its flexible spring will allow it to be applied on different LED profiles (with different heights) with a minimum of 5mm and a maximum of 11mm.

It is recommended to apply an insulating base on the underside of the sensor when mounting inside the LED profile to prevent malfunctioning.

Only 1 sensor can be applied in a single installation.

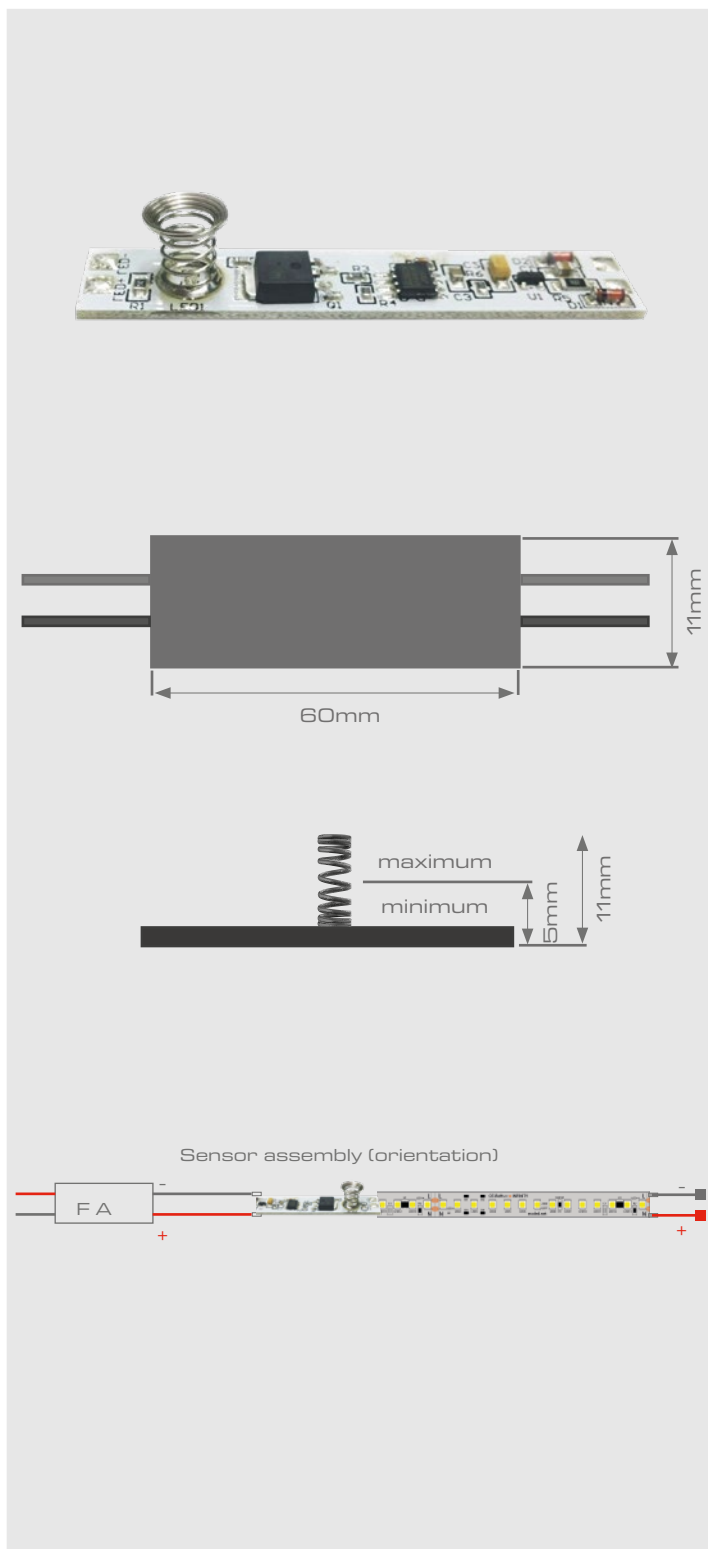

TECHNICAL SPECIFICATIONS:

Power (W):	48W/m (12V)
Power (W):	96W/m (24V)
Channels (output):	1
Amperage (12V):	4A
Measurements:	60x11x5mm
Regulation:	0%-100%
LED indicator light:	Ref: 17AE-021: blue Ref: 17AE-020: no
On/Off:	Touch
Watertightness (IP)	IP20
Power factor:	>0.5
Packaging:	1 unit
Guarantee:	2 years*

* Properly installed, used and maintained

COMPATIBLE LEDS

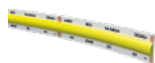
COB EGON 12V/11W



COB EGON 24V/15W



COB EGON RGB 24V/12W



TECHNICAL DATA SHEET
SENSOR SWITCH-DIMMER

Ref. 17AE-033

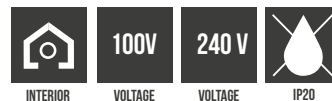

Infrared sensor with two functions in one, it can be set to "sensor for cupboard doors" or "pseudo-touch switch" mode by means of a selector switch.

TECHNICAL SPECIFICATIONS:

Power (W):	300 W/m
Voltage:	100V-240V
Amperage:	1.25A
Power supply:	84x35x19mm
Ø Sensor opening:	Ø17.5xØ12.5x11.5mm Ø14
Ø Mini sensor opening:	Ø12.5xØ9.8x13mm Ø10
Detection Range:	5-10cm
Operating temperature:	-20°/+45°C
Waterproof (IP):	IP20
Packaging:	1 unit
Guarantee:	2 years*

* Properly installed, used and maintained

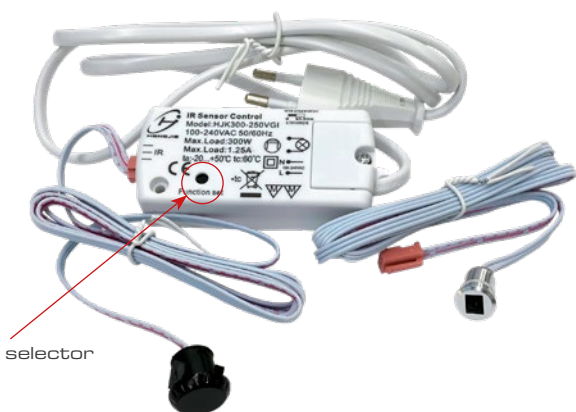

Function selector

COMPATIBLE LEDS

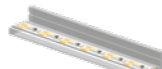

NIKOLA 220V



DALÍ 220V

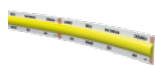

PICASSO 220V



COB EGON 12V/11W



COB EGON 24V/15W

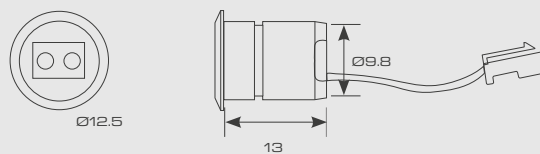
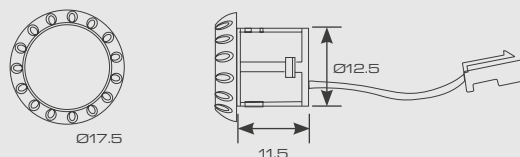
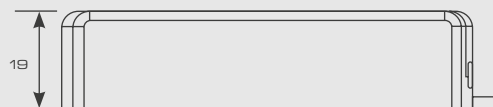
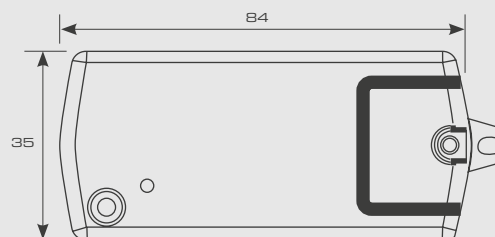

COB EGON RGB 24V/12W

Mini sensor:

Sensor:

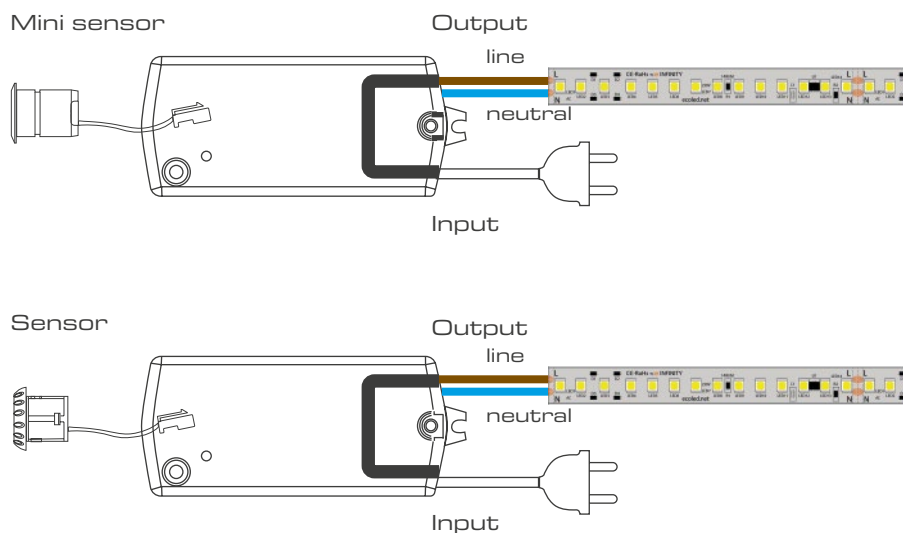
Supply measures:

WIRING DIAGRAM:



SENSOR FUNCTION:

Function of the sensor in the door

1. The lights are off

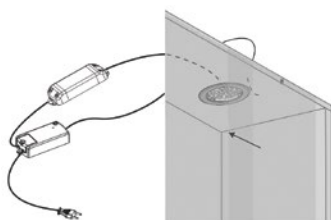

2. The lights are on



Sensor function

1. The lights are off

2. The lights are on

3. The lights are off

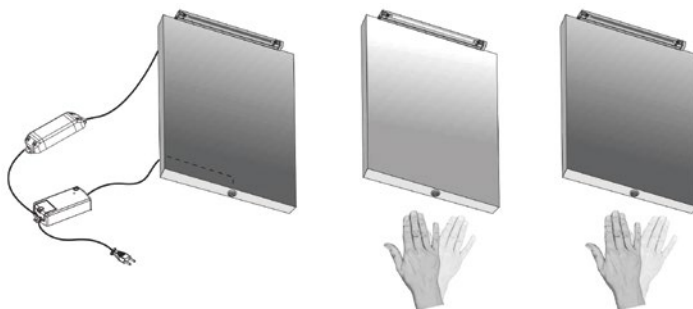

TECHNICAL DATA SHEET TOUCH SENSOR FOR FLUSH MOUNTING

Ref. 17AE-023

Recessed touch sensor with Dimmer on-off function.

The light intensity can be adjusted.

12V to 24V operation.

Product recommended for indoor use only.

Only 1 sensor can be applied in a single installation.

The cable of the "cell" detector must not be cut as this can lead to failure.

WARNING: the installation of the sensor with the LED strip must be carried out without connection to the power supply (the line must be disconnected from 230V) as this could shut down and cause a malfunction.

TECHNICAL SPECIFICATIONS:

Power (W):	36W/m (12V)
Power (W):	72W/m (24V)
Channels (output):	1
Amperage (12V):	3A
Measurements:	ø22
Regulation:	yes
Operating temperature:	-20°/+45°C
Weight:	65g
Watertightness (IP):	IP20
Packaging:	1 unit
Guarantee:	2 years

* Properly installed, used and maintained

COMPATIBLE LEDS

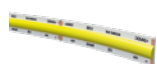

COB EGON 12V/11W



COB EGON 24V/15W



COB EGON RGB 24V/12W

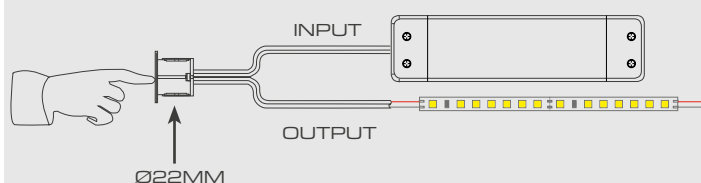
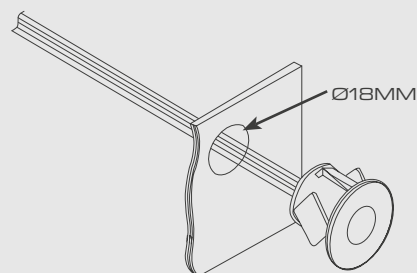
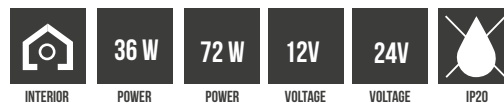

TECHNICAL DATA SHEET

SURFACE TOUCH SENSOR

Ref. 17AE-024

Surface touch sensor with on-off function.

The light intensity can be adjusted.

12V to 24V operation.

Product recommended for indoor use only.

Only 1 sensor can be applied in a single installation.

The cable of the "cell" detector must not be cut as this can lead to failure.

WARNING: the installation of the sensor with the LED strip must be carried out without connection to the power supply (the line must be disconnected from 230V) as this could shut down and cause a malfunction.

TECHNICAL SPECIFICATIONS:

Power (W):	36W/m (12V)
Power (W):	72W/m (24V)
Channels (output)	1
Amperage (12V):	2A
Measurements:	60x11x6mm
On-Off:	yes
Operating temperature:	-20°/+45°C
Weight:	38g
Watertightness (IP)	IP20
Packaging:	1 unit
Guarantee:	2 years

* Properly installed, used and maintained

COMPATIBLE LEDS

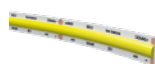

COB EGON 12V/11W



COB EGON 24V/15W



COB EGON RGB 24V/12W

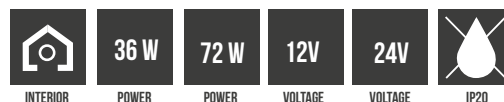

INTERIOR

36 W

POWER

72 W

POWER

12V

VOLTAGE

24V

VOLTAGE



IP20

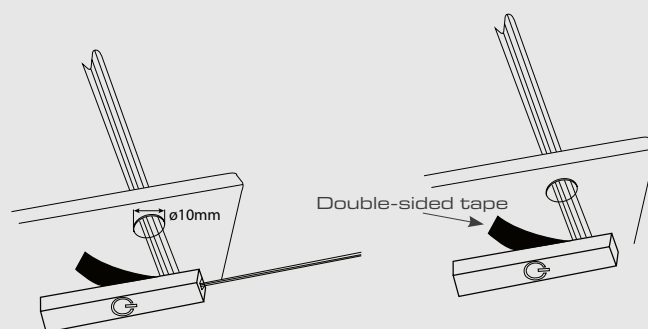
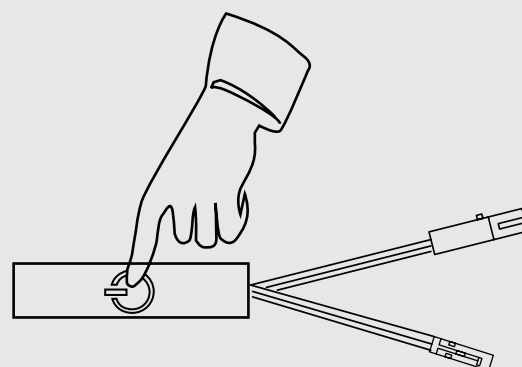

TECHNICAL DATA SHEET

PSEUDO-TOUCH SENSOR

Ref. 17AE-026

Sensor recommended for use in cupboards and drawers.

Operates at 12V-24V. Working range (ON/OFF) 4-20cm.

This product is only recommended for indoor use and only 1 sensor can be used in the same installation.

It can be used for both surface and recessed mounting.

The "cell" detection cable must not be cut, as this could cause a failure.

WARNING: the installation of the sensor with the LED strip must be carried out without connection to the power supply (the line must be disconnected from 230V) as this could shut down and cause a malfunction.

TECHNICAL SPECIFICATIONS:

Power (W):	36W/m (12V)
Power (W):	72W/m (24V)
Channels (output):	1
Amperage (12V):	3A
Measurements:	63x28x17mm
On-Off:	4-20cm
Weight:	12g
Watertightness (IP)	IP20
Packaging:	1 unit
Guarantee:	2 years

* Properly installed, used and maintained

COMPATIBLE LEDS

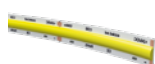

COB EGON 12V/11W

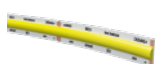

COB EGON 24V/15W



COB EGON RGB 24V/12W



INTERIOR



POWER



POWER



VOLTAGE



VOLTAGE



IP20

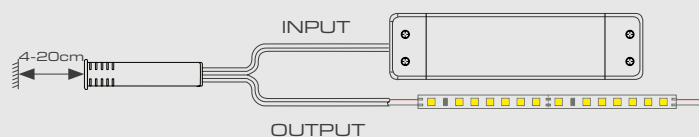
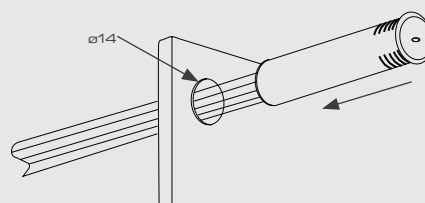
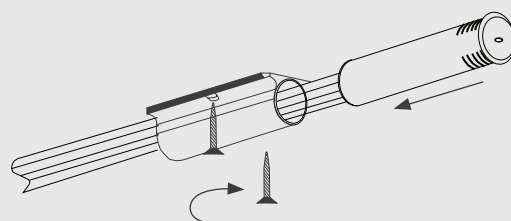
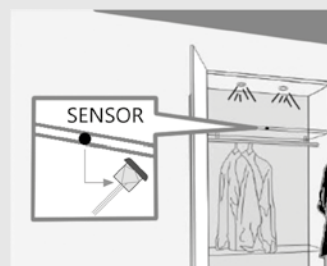

TECHNICAL DATA SHEET

MOTION SENSOR

Ref. 17AE-025

Motion sensor with 120° angle ideal for transit areas such as stairs, corridors, etc. It can be installed in 2 ways, either surface mounted or flush mounted. It works at 220V and includes the driver.

Indoor use is recommended for this product, which can be installed with only 1 sensor. To avoid malfunctions, the cable connected to the sensing cell must not be cut.

ATTENTION: The joint installation of the sensor and the LED strip must be carried out without connection to the power supply (the line must be disconnected from 240V) to avoid disconnections and malfunctions.



TECHNICAL SPECIFICATIONS:

Power (W):	250 W
Input:	100V - 240V
Output:	100V - 240V
Input stop:	120°
Receptor measures:	76x35x19.5mm
Receptor measures:	ø18mm
Operating temperature:	-20° / +45°
Size of hole	15mm
Watertightness (IP)	IP20
Packaging:	1 unit
Guarantee:	2 years

* Properly installed, used and maintained

COMPATIBLE LEDS



COB EGON 12V/11W



COB EGON 24V/15W



COB EGON RGB 24V/12W



NIKOLA 220V

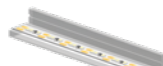

DALÍ 220V



PICASSO 220V

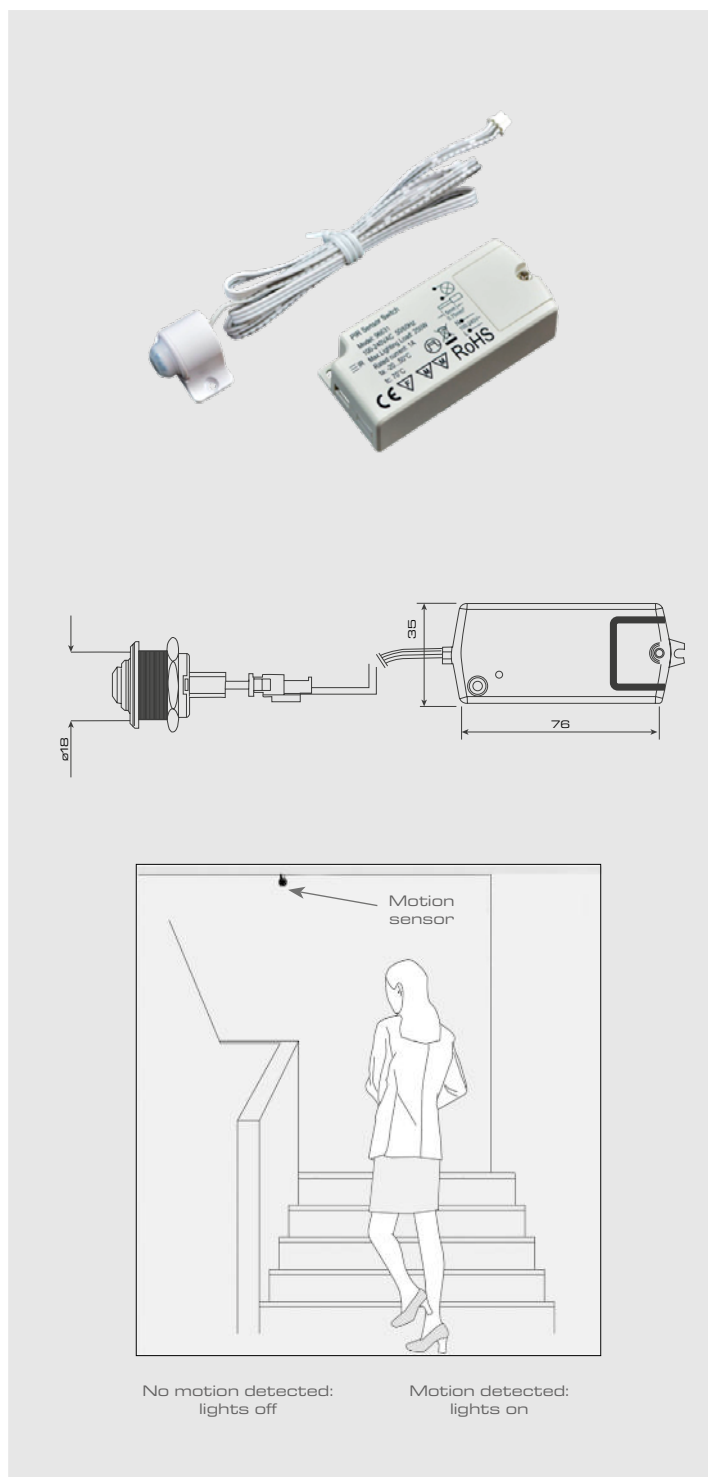



flex_and_lux



@servicanto



SERVICANTO, S.L.

FLEX&LUX by Servicanto
Polígono Can Illa C/Pompeu Fabra, 16
08530 La Garriga (Barcelona)
SPAIN
T. +34 93 871 55 05
flex.lux@servicanto.es
www.flexandlux.com
www.servicanto.com

